

**KITCHEN CABINETS**

WINDOW/DOOR SCHEDULE			
<b>WINDOWS: Andersen 100 series</b>			
#	SIZE	QTY	COMMENT
1	4-0x4-0	4	insert in steel buck with area wall
2	5-0x4-0	2	slider
3	6-0x1-0	1	fixed
3A	5-6X1-0	2	fixed
4	6-0x5-0	2	fixed, tempered
5	2-0x4-0	2	fixed
6	4-0x2-0	1	fixed
7	4-0x2-6	1	fixed, tempered
8	4-0x3-0	1	slider
9	5-0x5-0	2	simulated divided lite slider
10	4-0x1-6	1	simulated divided lite fixed
<b>DOORS</b>			
#	SIZE	COMMENT	
A	6-0X6-8	A 100 patio sliders: 1ea. OX, 1ea XO	
B	3-0X6-8	fiber glass with side lite	
C	9x8	insulated metal sectional overhead door	
D	16x8	insulated metal sectional overhead door	
<b>NOTE: VERIFY ALL R.O.'S WITH G.C. PRIOR TO FRAMING</b>			

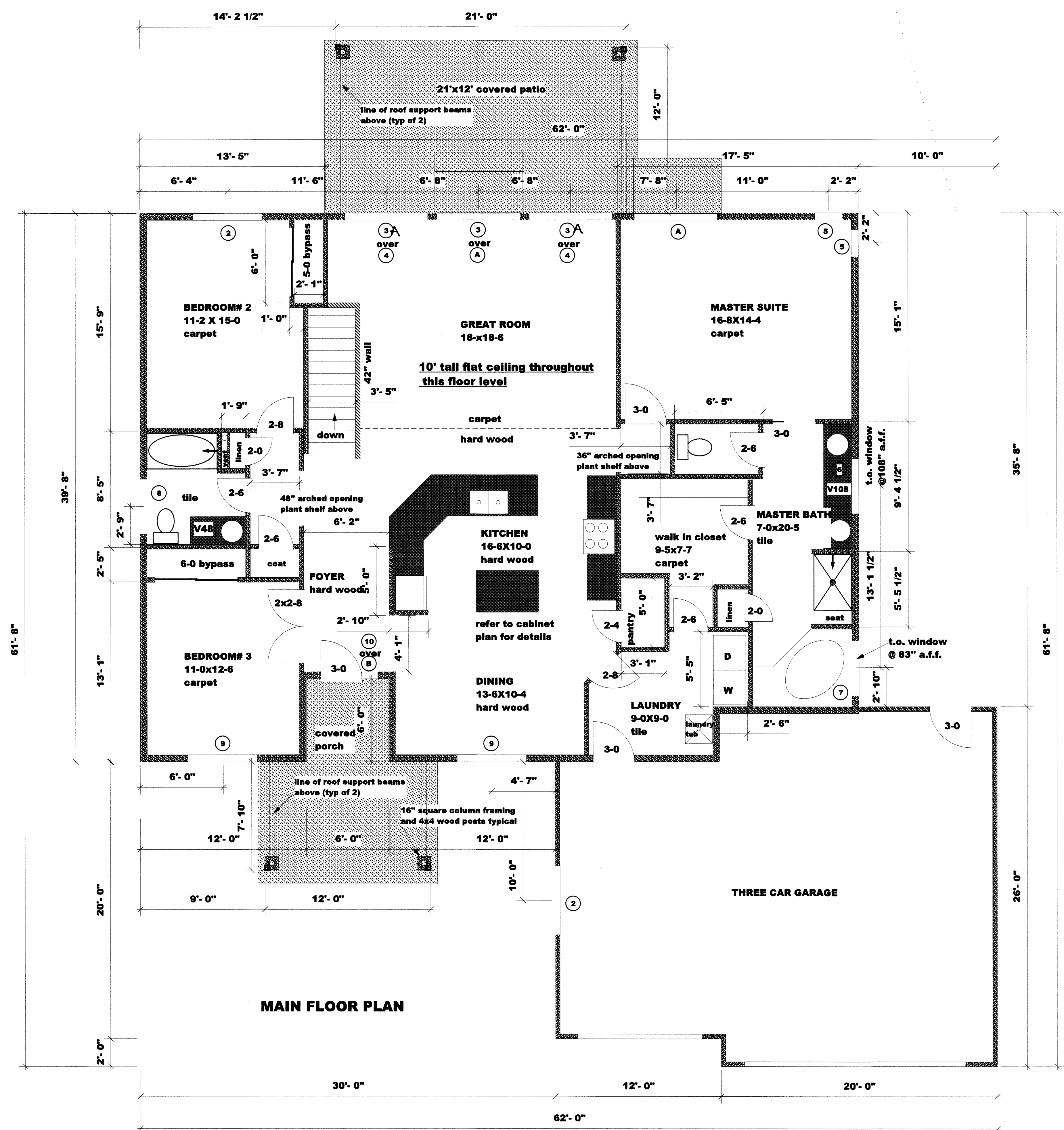

**MAIN FLOOR PLAN**

**GENERAL NOTES**

1. Exterior dimensions are to face of sheathing. All other dimensions are to framing. Interior partitions are dimensioned to centerline of framing except where noted otherwise.
2. Any discrepancies or questions pertaining to these drawings are to be clarified with the general contractor prior to proceeding with work.
3. engineered foundation and structural drawings shall take precedence over information contained on these drawings.

**AREAS:**

BASEMENT: 1898 SQUARE FEET  
 MAIN LEVEL: 1986 SQUARE FEET  
 GARAGE: 808 SQUARE FEET  
 stated room sizes are approximate

**THOMAS CONSTRUCTION MANAGEMENT**  
 2120 GALE RD. PUEBLO, CO 81006  
 phone: 719.542.1400 fax 719.542.3607 cell 719.250.1400  
 email: scott52 thomas@gmail.com

**MAIN FLOOR PLAN, CABINET DETAIL**

Date: 7/11/17	Project#
Scale: 1/4" = 1' U.N.O.	Drawing# 1986A Page# 1/3