

614-00011 614-00012 614-00013 614-01502 614-01572 614-00615 614-03002 210-00825

Tabulation of Signs

Sign No.	Location	Station	Direction		Side	Sign Code	Sign Panel Size			Backgrnd. Color	Sign Panel			Steel Sign Supp. (P) (2" Round)		Steel Sign Supp. (P1) (2.5" Round)		Steel Post (W Shape)	Concrete Footing Type2	Reset Flashing Becon
			Bound	Facing			W"	x	H"		Class I	Class II	Class III	Socket	Post	Slipbase	Post	W6x15 Beam		
31	US 50	217+40	EB	North	RT	R6-1	54	x	18	White		7				1	9			
32	US 50	236+00	EB	West	RT	R2-1	36	x	48	White		12				1	11			
33	US 50	231+00	EB	West	RT	M3-2	36	x	18	White		5								
34	US 50	231+00	EB	West	RT	M1-4	36	x	36	White		9			1	12				
35	US 50	245+46	EB	West	LT	R5-1a	42	x	30	Red		9			1	10				
36	US 50	245+46	EB	West	LT	R5-1a	42	x	30	Red		9			1	10				
37	US 50	247+72	EB	West	LT	R5-1	36	x	36	White		9			1	10				
38	US 50	247+72	EB	West	LT	R5-1	36	x	36	White		9			1	10				
39	US 50	248+50	EB	West	RT	R6-1	54	x	18	White		7								
40	US 50	248+50	EB	West	RT	R6-1	54	x	18	White		7			1	10				
41	US 50	249+15	EB	West	RT	R6-1	54	x	18	White		7								
42	US 50	249+15	EB	West	RT	R1-1	36	x	36	Red		9								
43	US 50	249+15	EB	West	RT	R3-2	36	x	36	White		9			1	13				
44	US 50	266+13	EB	West	RT	SP-4	168	x	84	Brown			98				28		2	
45	US 50	265+07	EB	West	RT	R2-1	36	x	48	White		12			1	11				
46	US 50	263+90	EB	West	RT	D10-3	12	x	48	Green	4			1	12					
47	US 50	262+59	EB	West	RT	R3-7r	30	x	30	White	6			1	11					
48	US 50	261+40	EB	West	RT	D50-3	84	x	48	Green			28			2	22			
49	US 50	273+35	EB	West	RT	R5-1	36	x	36	White		9			1	10				
50	US 50	272+16	EB	West	RT	R3-7r	30	x	30	White	6			1	11					
SHEET 2 SUBTOTALS											17	127	126	3	34	13	138	28	2	0
SHEET 1 SUBTOTALS											12	208	259	3	36	13	152	100	6	2
PROJECT TOTALS											29	335	385	6	70	26	290	128	8	2

Print Date: 10/9/2014		 Region 2	902 Erie Avenue Pueblo, CO 81001 Phone: 719-562-5509 FAX: 719-546-5702 DTD	As Constructed	US 50 WEST PURCELL BLVD. TO WILLS BLVD. TAB OF SIGNING & PVMT MARKING	Project No./Code
File Name: I9056 TAB_Sign_1.dgn				No Revisions:		FSA 0503-081
Horiz. Scale: 1:100 Vert. Scale: As Noted				Revised:		19751
 J.F. SATO AND ASSOCIATES 5898 South Ropp Street Littleton, Colorado 80120			902 Erie Avenue Pueblo, CO 81001 Phone: 719-562-5509 FAX: 719-546-5702 DTD	Void:	Designer: AB Structure Detailer: AB Numbers Subset: SGT Subset Sheets: SGT2of 3	Sheet Number 284

oboonier: 12:41:54 PM \\nas1\0900_Jobs\0940E_CDDT_US50_Design\04_Design\19056\Design\Drawings\30_Signing_Stripping_Tob\19056 TAB_Sign_1.dgn

Tabulation of Pavement Marking											
Station	Location	Edge - Epoxy		Lane Line White	Channelizing		Stop Line	Cross Walk	Left/Right		
		White Solid 4 Inch	Yellow Solid 4 Inch	Lane Line White	White Solid - 8 Inch	Yellow Solid - 8 Inch	White Solid - 24 Inch	White Solid - 12 Inch			
		Epoxy Pavement Marking (Special)					Preformed Thermoplastic Pavement Marking				
		LF	LF	LF	LF	LF	LF	LF			
Sta. 99+14 to Sta. 217+12	US 50	12,337	10,754	23,804	500	1,223	47	344	2		
Sta. 400+00 to Sta. 410+24.37	SW Ramp	1,773									
Sta. 500+00 to Sta. 508+99.30	SE Ramp	1,311									
Sta. 219+07 to Sta. 274+00.00	US 50	6,208	4,959	11,084			60	305	2		
Sta. 700+42.96 to Sta. 721+41.18	McCulloch Blvd.	2,262		619	887			40	2		
Subtotal (LF)		23,891	15,712	35,507	1,387	1,223	107	689	6		
Subtotal (SF)		7,964	5,237	2,959	925	815	214	689	93		
Subtotal (Gal)		80	52	30	9	8					

627-00007

627-30405

627-30410

Summary of Pavement Marking			
Color	Epoxy Pavement Marking (Special)	Preformed Thermoplastic Pavement Marking Word-Symbol	Preformed Thermoplastic Pavement Marking Xwalk-Stopline
	Gal.	SF	SF
Yellow	61	0	0
White	118	93	903
Total	179	93	903

NOTE:
 1. THESE QUANTITIES ARE CARRIED FORWARD TO THE TABULATION TRAFFIC ENGINEERING ITEMS AND ARE SHOWN HERE FOR INFORMATION ONLY.
 2. IT IS ESTIMATED THAT 400 GAL OF PAVEMENT MARKING PAINT (WATERBORNE) WILL BE NEEDED FOR TEMPORARY PAVEMENT MARKINGS. THE QUANTITIES ARE SUFFICIENT FOR 2 APPLICATIONS DURING CONSTRUCTION.

Print Date: 10/9/2014	0000	Sheet Revisions			Colorado Department of Transportation  902 Erie Avenue Pueblo, CO 81001 Phone: 719-562-5509 FAX: 719-546-5702 Region 2 DTD	As Constructed	US 50 WEST PURCELL BLVD. TO WILLS BLVD. TAB OF SIGNING & PVMT MARKING		Project No./Code
File Name: 19056 TAB_Sign_1.dgn		Date:	Comments	Init.		No Revisions:			FSA 0503-081
Horiz. Scale: 1:100 Vert. Scale: As Noted						Revised:	Designer: AB Structure Detailer: AB Numbers Subset: SGT Subset Sheets: SGT3of 3	19751	Sheet Number 285

JFS&A
 J. F. SATO AND ASSOCIATES
 5898 South Rapp Street
 Littleton, Colorado 80120



Know what's below.
Call before you dig.

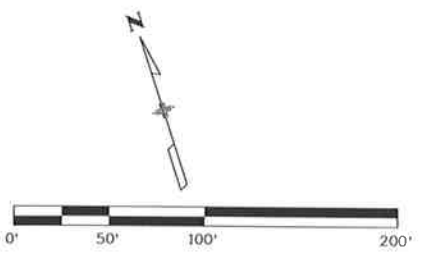
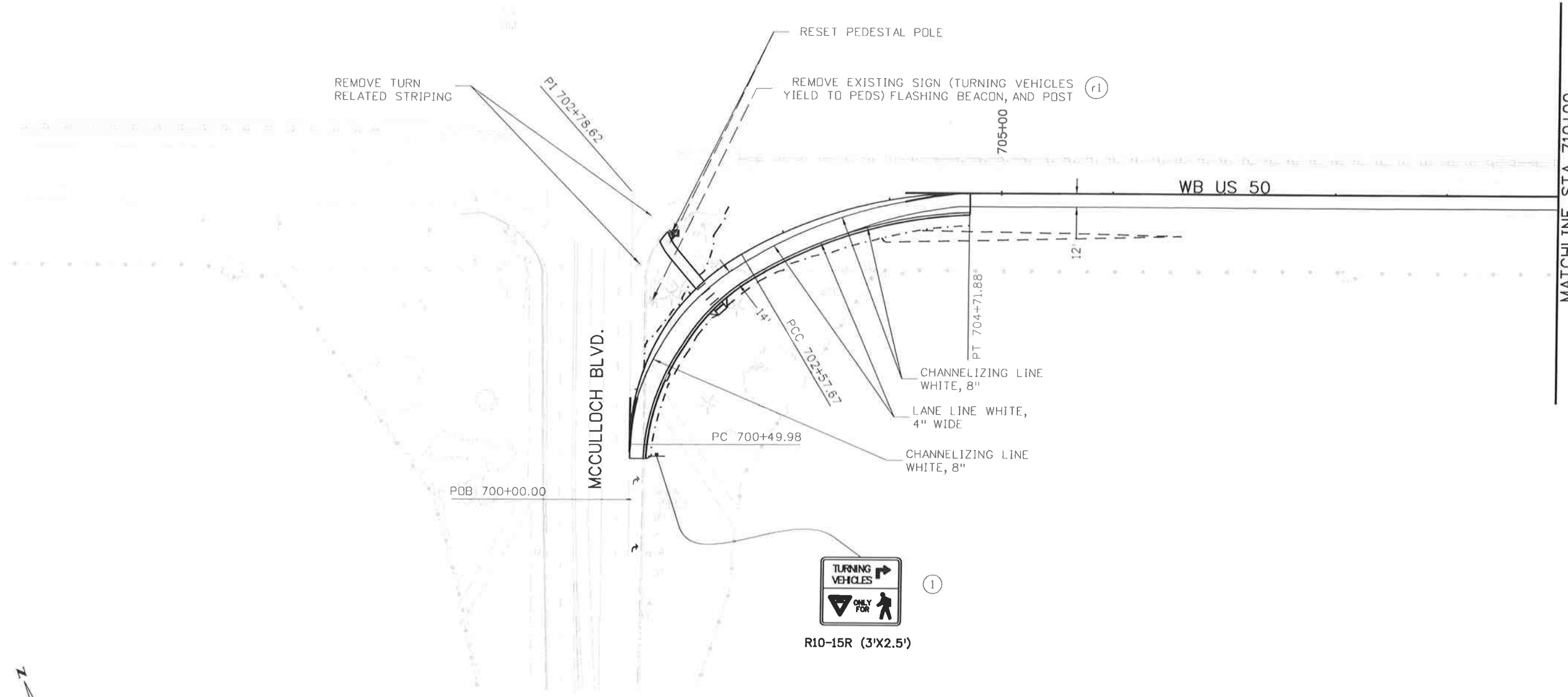
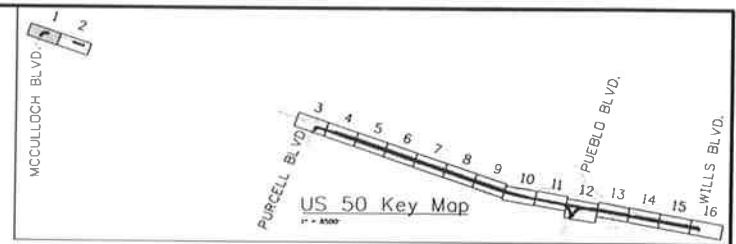

NOTE:
HCL NOT SHOWN FOR CLARITY PURPOSES

Print Date: 10/9/2014		Sheet Revisions Date: Comments Init.			Colorado Department of Transportation 902 Erie Avenue Pueblo, CO 81001 Phone: 719-562-5509 FAX: 719-546-5702		As Constructed		US 50 WEST MCCULLOCH BLVD. SIGNING AND STRIPING PLAN		Project No./Code	
File Name: 19056Sign_01_Plan.dgn							No Revisions:				Designer: AB	
Horiz. Scale: 1:100 Vert. Scale: As Noted		Revised:		Detailer: AB		Numbers		19751		Sheet Number		
J. F. SATO AND ASSOCIATES 5898 South Rapp Street Littleton, Colorado 80120		Region 2		DTD		Subset: SN Subset Sheets: SN01 of 18		286				

aboonert 12:42:33 PM \\nas\0900...Jobs\0940E\CDDT US50 Design\04...Design\19056\Design\Drawings\31...Signing...Striping Plan\19056Sign_01_Plan.dgn



Know what's below.
Call before you dig.

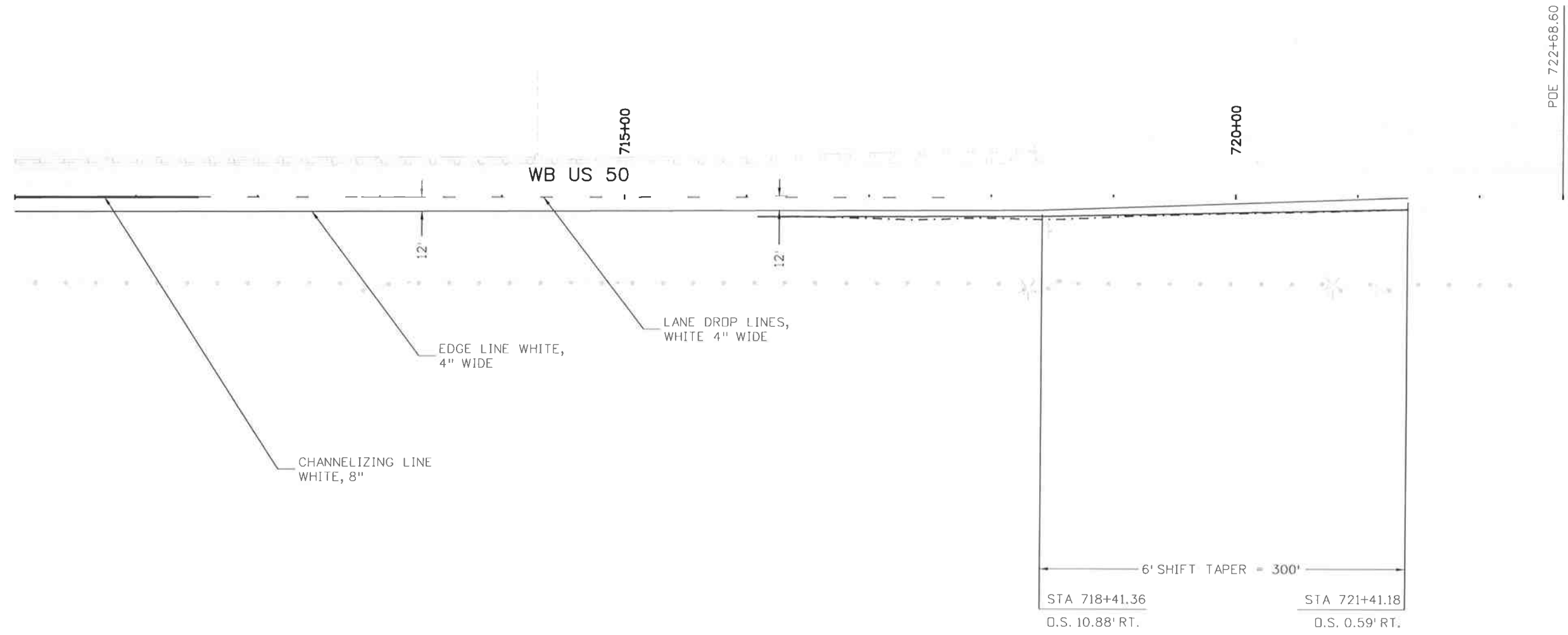
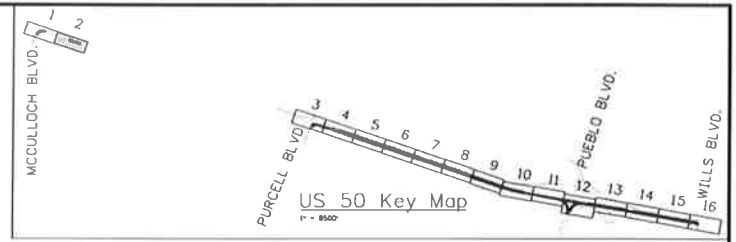

PDE 722+68.60

6' SHIFT TAPER = 300'
 STA 718+41.36 STA 721+41.18
 D.S. 10.88' RT. D.S. 0.59' RT.

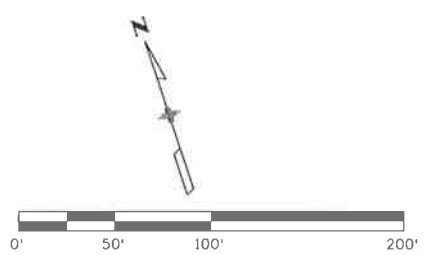

NOTE:
HCL NOT SHOWN FOR CLARITY PURPOSES

Print Date: 10/9/2014 File Name: 19056Sign_02_Plan.dgn Horiz. Scale: 1:100 Vert. Scale: As Noted		Sheet Revisions <table border="1"> <thead> <tr> <th>Date:</th> <th>Comments</th> <th>Init.</th> </tr> </thead> <tbody> <tr><td> </td><td> </td><td> </td></tr> <tr><td> </td><td> </td><td> </td></tr> <tr><td> </td><td> </td><td> </td></tr> <tr><td> </td><td> </td><td> </td></tr> </tbody> </table>		Date:	Comments	Init.													Colorado Department of Transportation 902 Erie Avenue Pueblo, CO 81001 Phone: 719-562-5509 FAX: 719-546-5702 Region 2 DTD		As Constructed No Revisions: Revised: Void:		US 50 WEST MCCULLOCH BLVD. SIGNING AND STRIPING PLAN Designer: AB Structure Numbers Detailer: AB Subset: SN Subset Sheets: SN02 of 18			Project No./Code FSA 0503-081 19751 Sheet Number 287	
Date:	Comments	Init.																									

aooniert 12:42:39 PM \\nas1\0900...Jobs\0940E\CDOT U550 Design\04...Design\19056\Drawings\31...Signing...Striping Plan\19056Sign_02_Plan.dgn



Know what's below.
Call before you dig.

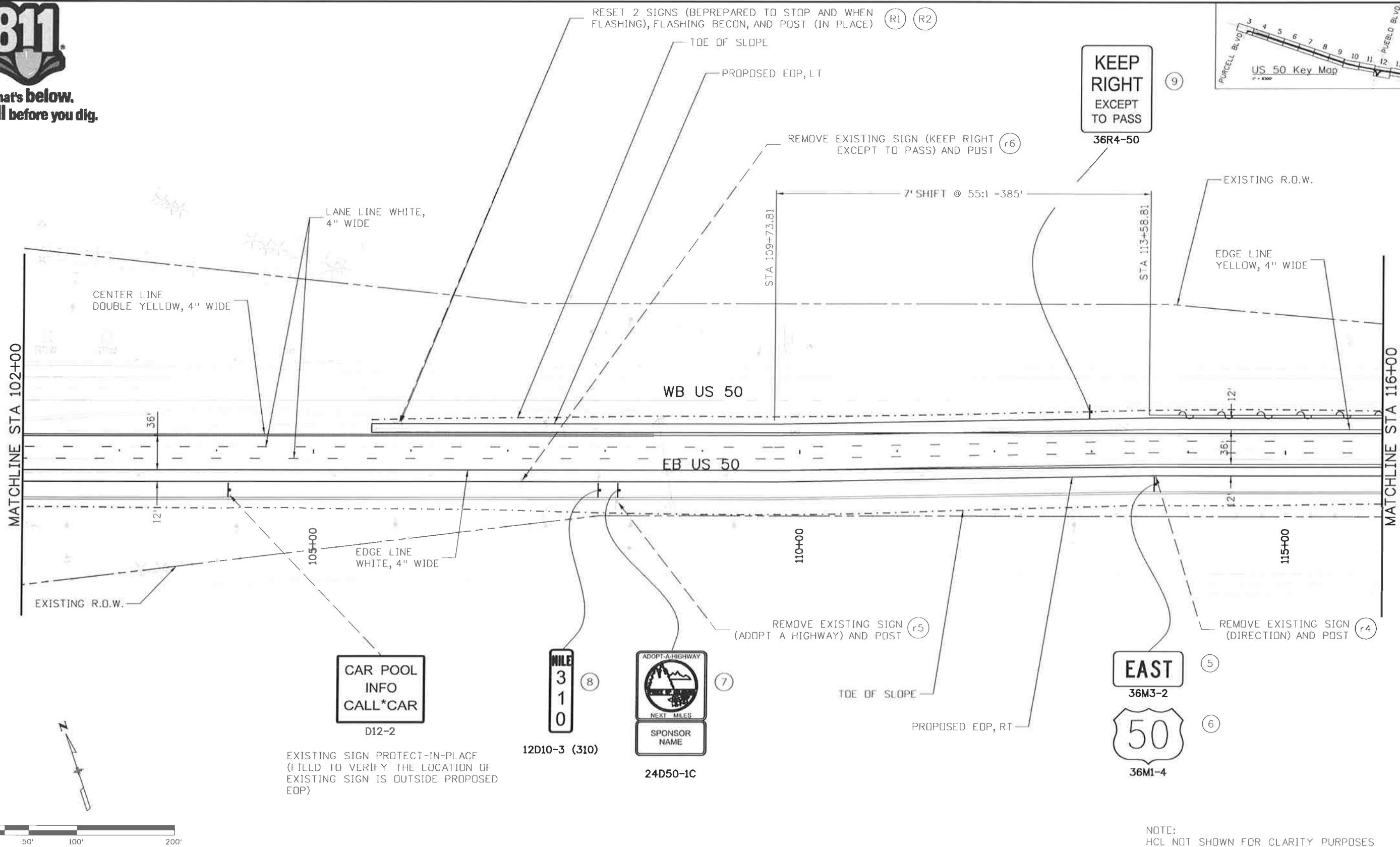
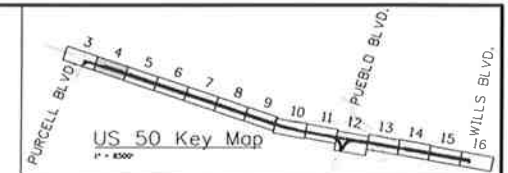

NOTE:
HCL NOT SHOWN FOR CLARITY PURPOSES

Print Date: 10/9/2014
 File Name: 19056Sign_04_Plan.dgn
 Horiz. Scale: 1:100 Vert. Scale: As Noted

JFS
 J. F. SATO AND ASSOCIATES
 5898 South Rapp Street
 Littleton, Colorado 80120

Sheet Revisions		
Date:	Comments	Init.

Colorado Department of Transportation

 902 Erie Avenue
 Pueblo, CO 81001
 Phone: 719-562-5509 FAX: 719-546-5702
 Region 2 DTD

As Constructed
 No Revisions:
 Revised:
 Void:

US 50 WEST
 PURCELL BLVD. TO WILLS BLVD.
 SIGNING AND STRIPING PLAN

Designer: AB Structure
 Detailer: AB Numbers
 Subset: SN Subset Sheets: SN04 of 18

Project No./Code
 FSA 0503-081
 19751
 Sheet Number 289

c:\nests\0900...jobs\0940E CDDT US50 Design\04...Design\19056\Drawings\31_Signing_Striping_Plan\19056Sign_04_Plan.dgn



Know what's below.
Call before you dig.

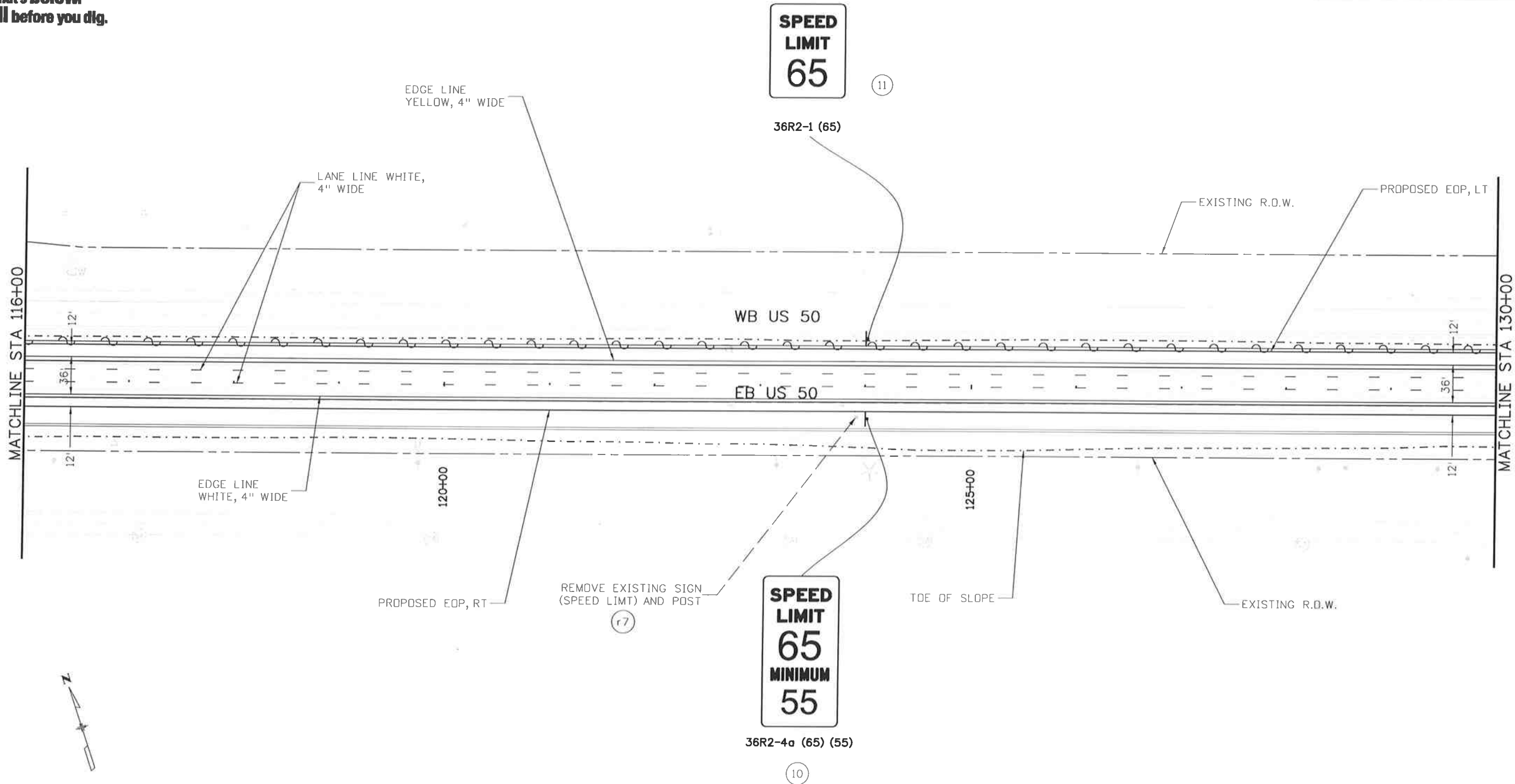
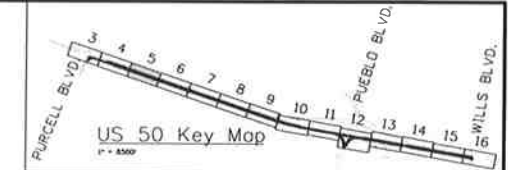

NOTE:
HCL NOT SHOWN FOR CLARITY PURPOSES

Print Date: 10/9/2014
File Name: 19056Sign_05_Plan.dgn
Horiz. Scale: 1:100 Vert. Scale: As Noted
JFS&A
J. F. SATO AND ASSOCIATES
5898 South Rapp Street
Littleton, Colorado 80120

Sheet Revisions		
Date:	Comments	Init.

Colorado Department of Transportation
 902 Erie Avenue
Pueblo, CO 81001
Phone: 719-562-5509 FAX: 719-546-5702
Region 2 DTD

As Constructed
No Revisions:
Revised:
Void:

U.S. 50 WEST
PURCELL BLVD. TO WILLS BLVD.
SIGNING AND STRIPING PLAN
Designer: AB Structure
Detailer: AB Numbers
Subset: SN Subset Sheets: SN05of 18

Project No./Code
FSA 0503-081
19751
Sheet Number 290

c:\n\0900_000s\0940E\CDOT US50 Design\19056\Design\Drawings\31_Signing_Striping\Plan\19056Sign_05_Plan.dgn



Know what's below.
Call before you dig.

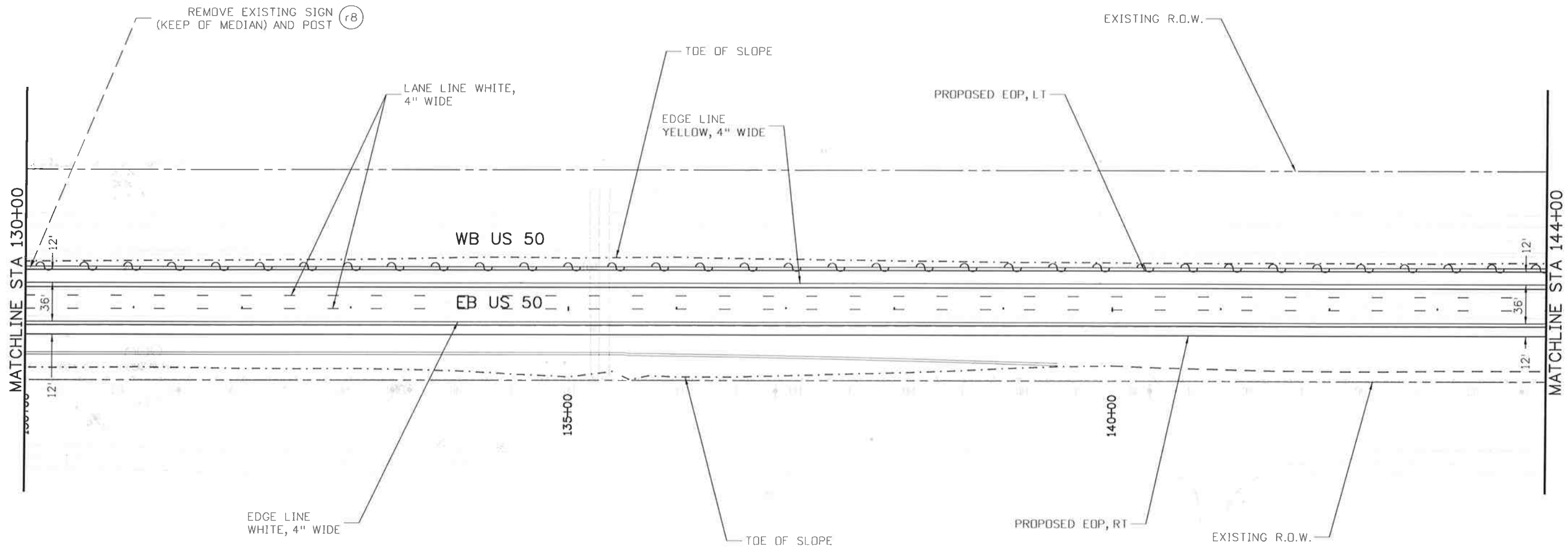
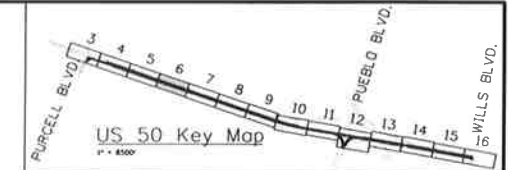

NOTE:
HCL NOT SHOWN FOR CLARITY PURPOSES

Print Date: 10/9/2014		Sheet Revisions Date: Comments Init.		Colorado Department of Transportation 902 Erie Avenue Pueblo, CO 81001 Phone: 719-562-5509 FAX: 719-546-5702		As Constructed		US 50 WEST PURCELL BLVD. TO WILLS BLVD. SIGNING AND STRIPING PLAN		Project No./Code	
File Name: 19056Sign_06_Plan.dgn						No Revisions:				FSA 0503-081	
Horiz. Scale: 1:100 Vert. Scale: As Noted				Region 2 DTD		Revised:		Designer: AB Structure		19751	
J. F. SAID AND ASSOCIATES 5898 South Rapp Street Littleton, Colorado 80120						Void:		Detailer: AB Numbers		Sheet Number 291	
						Subset:		SN Subset Sheets: SN06 of 18			

12:43:05 PM \\nas1\0900...Jobs\0940E\CDOT US50 Design\04...Design\19056\Sign_06_Plan.dgn



Know what's below.
Call before you dig.

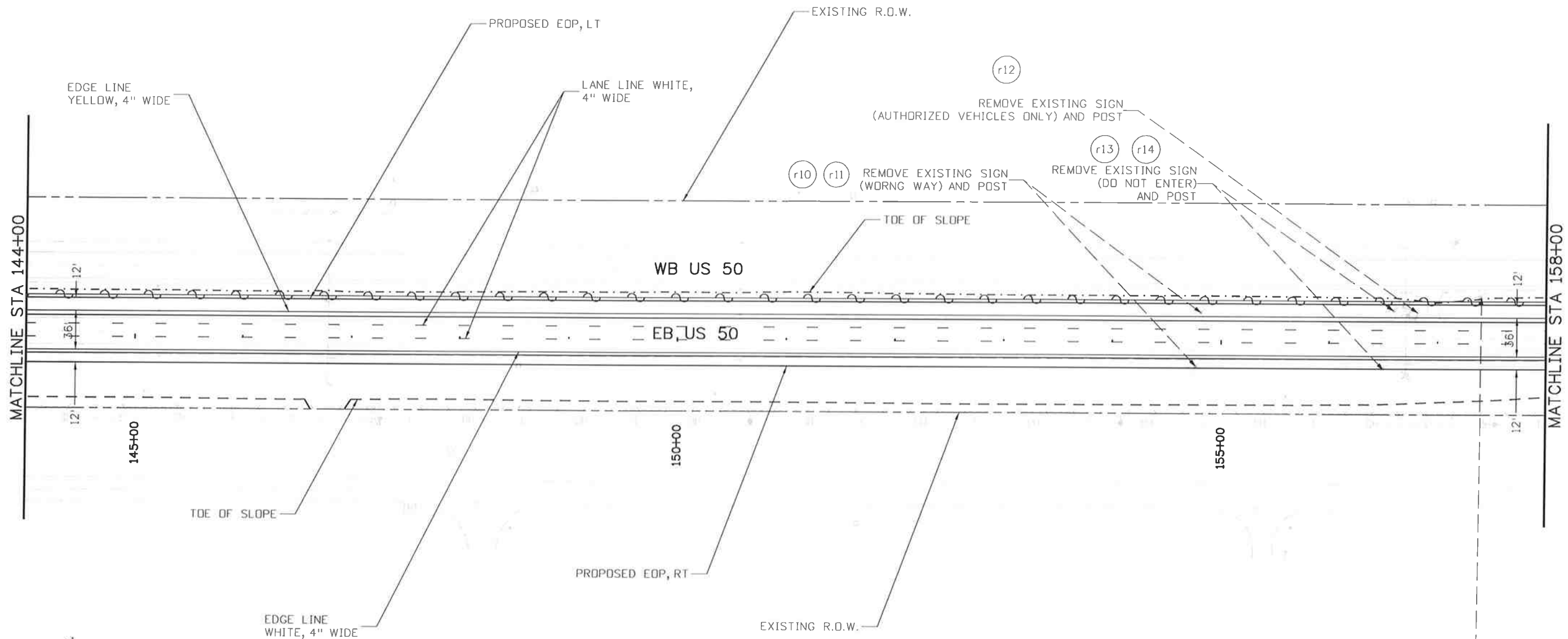
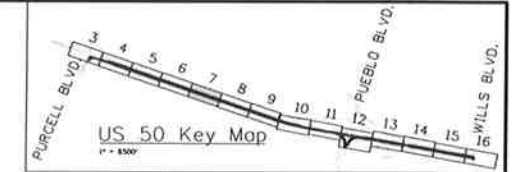

(r10) (r11) REMOVE EXISTING SIGN (WRONG WAY) AND POST

(r12) REMOVE EXISTING SIGN (AUTHORIZED VEHICLES ONLY) AND POST

(r13) (r14) REMOVE EXISTING SIGN (DO NOT ENTER) AND POST

(r9) REMOVE EXISTING SIGN (DO NOT ENTER) AND POST

NOTE:
HCL NOT SHOWN FOR CLARITY PURPOSES

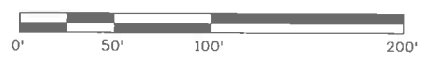

Print Date: 10/9/2014
 File Name: 19056Sign_07_Plan.dgn
 Horiz. Scale: 1:100 Vert. Scale: As Noted

JFS&A
 J. F. SATO AND ASSOCIATES
 5898 South Rapp Street
 Littleton, Colorado 80120

Sheet Revisions		
Date:	Comments	Init.

Colorado Department of Transportation

CDOT
 902 Erie Avenue
 Pueblo, CO 81001
 Phone: 719-562-5509 FAX: 719-546-5702

Region 2 DTD

As Constructed

No Revisions:
 Revised:
 Void:

US 50 WEST
 PURCELL BLVD. TO WILLS BLVD.
 SIGNING AND STRIPING PLAN

Designer:	AB	Structure	
Detailer:	AB	Numbers	
Subset:	SN	Subset Sheets:	SN07 of 18

Project No./Code
 FSA 0503-081
 19751
 Sheet Number 292

oboonert.12:4:3:10 PM \\Nesi\0900_Jobs\0940E_CDDT_US50_Design\04_Design\19056\Design\Drawings\31_Signing_Striping_Plan\19056Sign_07_Plan.dgn



Know what's below. Call before you dig.

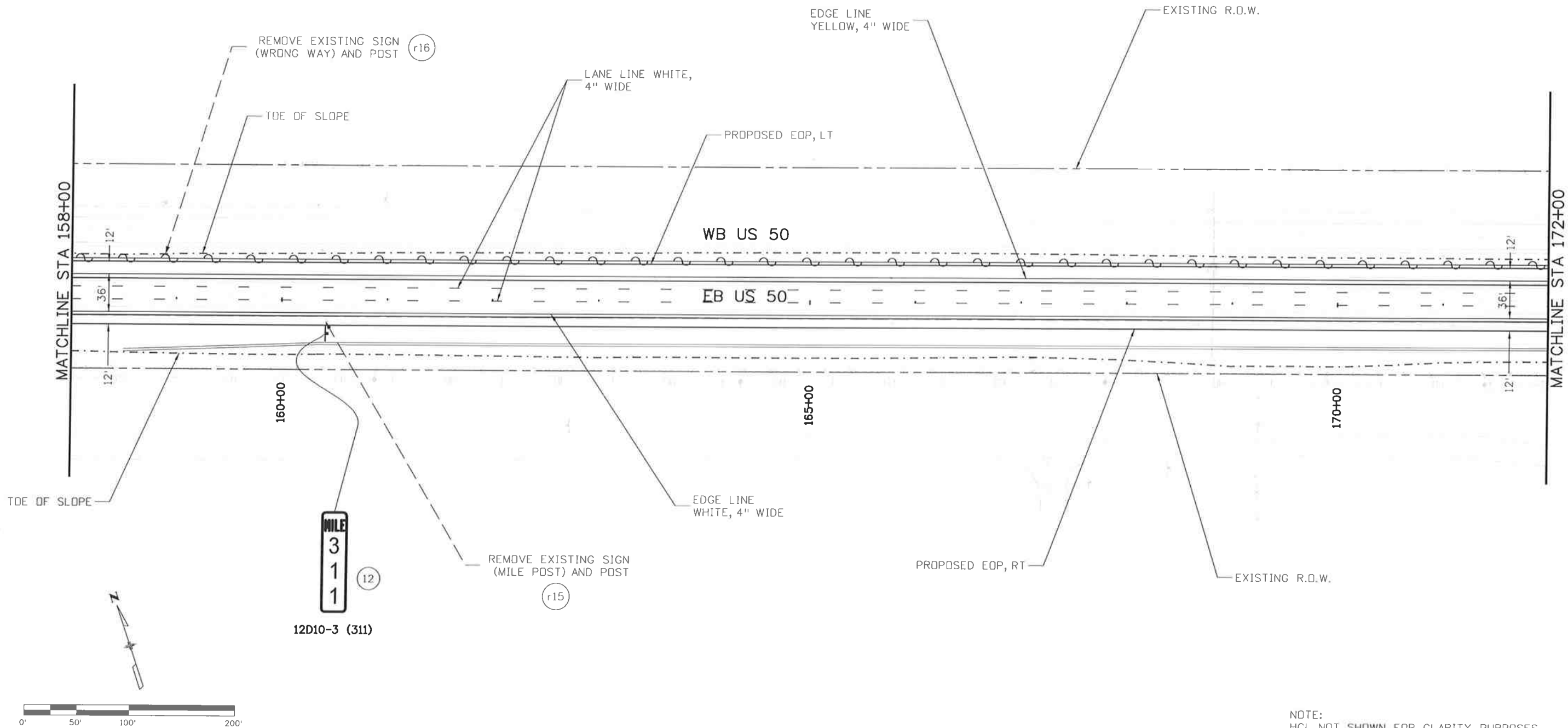
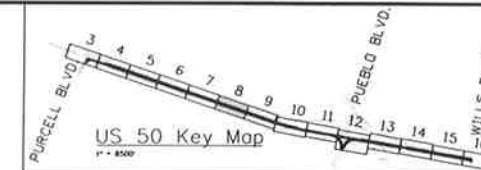

NOTE: HCL NOT SHOWN FOR CLARITY PURPOSES

Print Date: 10/9/2014
File Name: 19056Sign_08_Plan.dgn
Horiz. Scale: 1:100 Vert. Scale: As Noted

Sheet Revisions		
Date:	Comments	Init.

Colorado Department of Transportation

 902 Erie Avenue
 Pueblo, CO 81001
 Phone: 719-562-5509 FAX: 719-546-5702
Region 2 DTD

As Constructed
No Revisions:
Revised:
Void:

US 50 WEST PURCELL BLVD. TO WILLS BLVD. SIGNING AND STRIPING PLAN		
Designer: AB	Structure	Numbers
Detailer: AB		
Subset: SN	Subsel Sheets: SNO8of 18	

Project No./Code
FSA 0503-081
19751
Sheet Number 293

JFS&A
 J. F. SATO AND ASSOCIATES
 5898 South Rapp Street
 Littleton, Colorado 80120

c:\nos1\09000\jobs\09405\cddt\US50\Design\04\Design\19056\Design\Drawings\31_Signing_Striping_Plan\19056Sign_08_Plan.dgn



Know what's below.
Call before you dig.

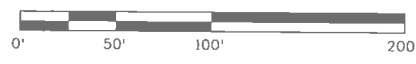
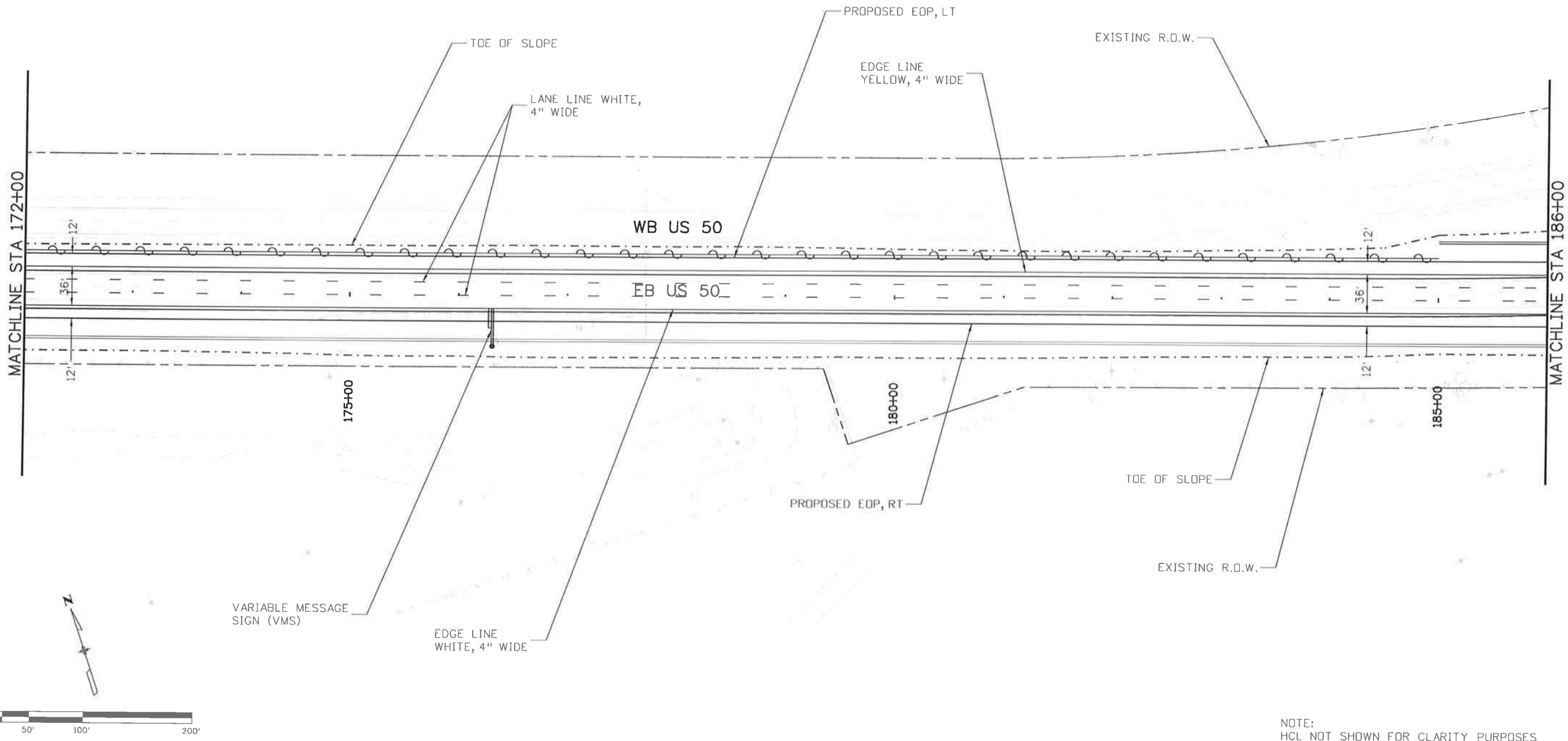
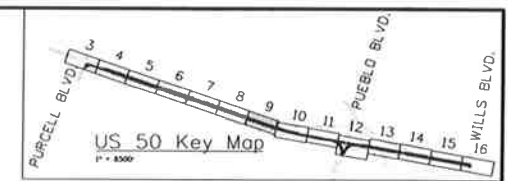

NOTE:
HCL NOT SHOWN FOR CLARITY PURPOSES

Print Date: 10/9/2014
 File Name: 19056Sign_09_Plan.dgn
 Horiz. Scale: 1:100 Vert. Scale: As Noted

JFS&A
 J. F. SATO AND ASSOCIATES
 5898 South Rapp Street
 Littleton, Colorado 80120

Sheet Revisions		
Date:	Comments	Init.

Colorado Department of Transportation

CDOT
 902 Erie Avenue
 Pueblo, CO 81001
 Phone: 719-562-5509 FAX: 719-546-5702

Region 2 DTD

As Constructed

No. Revisions:

Revised:

Void:

US 50 WEST
 PURCELL BLVD. TO WILLS BLVD.
 SIGNING AND STRIPING PLAN

Designer:	AB	Structure	
Detailer:	AB	Numbers	
Subset:	SN	Subset Sheets:	SN09 of 18

Project No./Code

FSA 0503-081

19751

Sheet Number 294

aboonert.12:43:20 PM \\nas1\0900...jobs\0940E\CDOT\US50 Design\04_Design\19056\Design\Drawings\31_Signing_Striping_Plan\19056Sign_09_Plan.dgn



Know what's below.
Call before you dig.

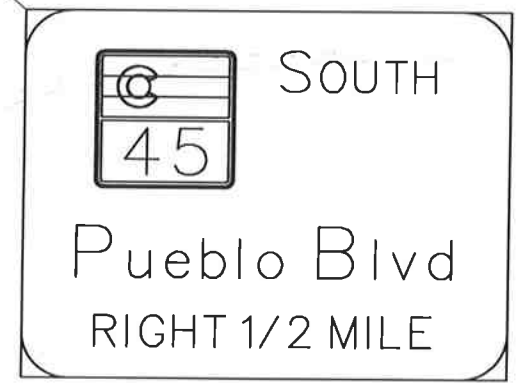
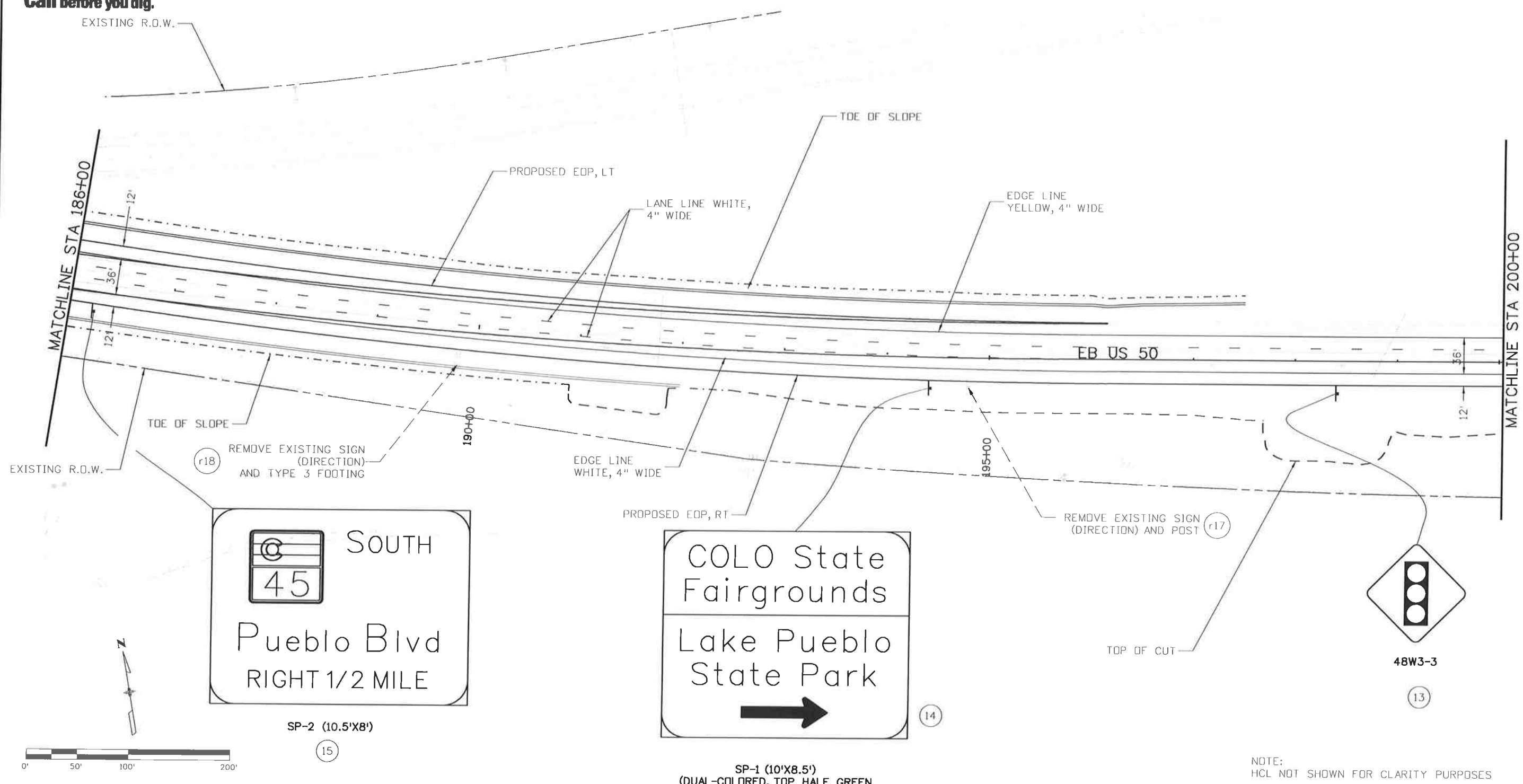
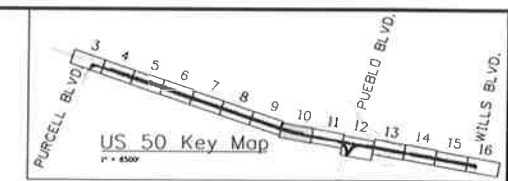

SP-2 (10.5'x8')



SP-1 (10'x8.5')
(DUAL-COLORED, TOP HALF GREEN
BOTTOM HALF BROWN)

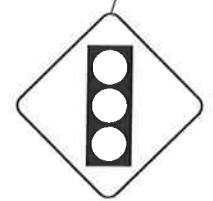

48W3-3

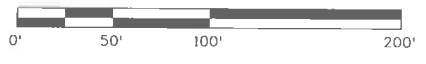

NOTE:
HCL NOT SHOWN FOR CLARITY PURPOSES

Print Date: 10/9/2014
File Name: 19056Sign_10_Plan.dgn
Horiz. Scale: 1:100 Vert. Scale: As Noted
JFS&A
J. F. SATO AND ASSOCIATES 5898 South Rapp Street Littleton, Colorado 80120

Sheet Revisions		
Date:	Comments	Init.

Colorado Department of Transportation

902 Erie Avenue
Pueblo, CO 81001
Phone: 719-562-5509 FAX: 719-546-5702

Region 2 DTD

As Constructed
No Revisions:
Revised:
Void:

US 50 WEST PURCELL BLVD. TO WILLS BLVD. SIGNING AND STRIPING PLAN		
Designer:	AB	Structure
Detailer:	AB	Numbers
Subset:	SN	Subset Sheets: SN10 of 18

Project No./Code
FSA 0503-081
19751
Sheet Number 295

absolent 12:43:25 PM \\nas1\0900...jobs\0940E\CDOT_US50_Design\04...Design\19056\Design\Drawings\31_Signing_Striping_Plan\19056Sign_10_Plan.dgn



Know what's below.
Call before you dig.

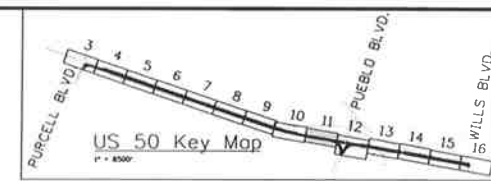
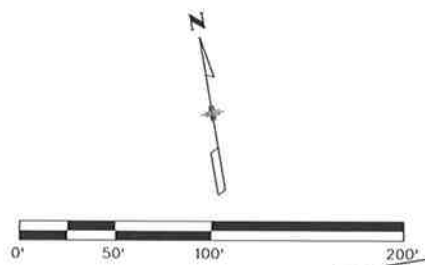

NOTE:
HCL NOT SHOWN FOR CLARITY PURPOSES

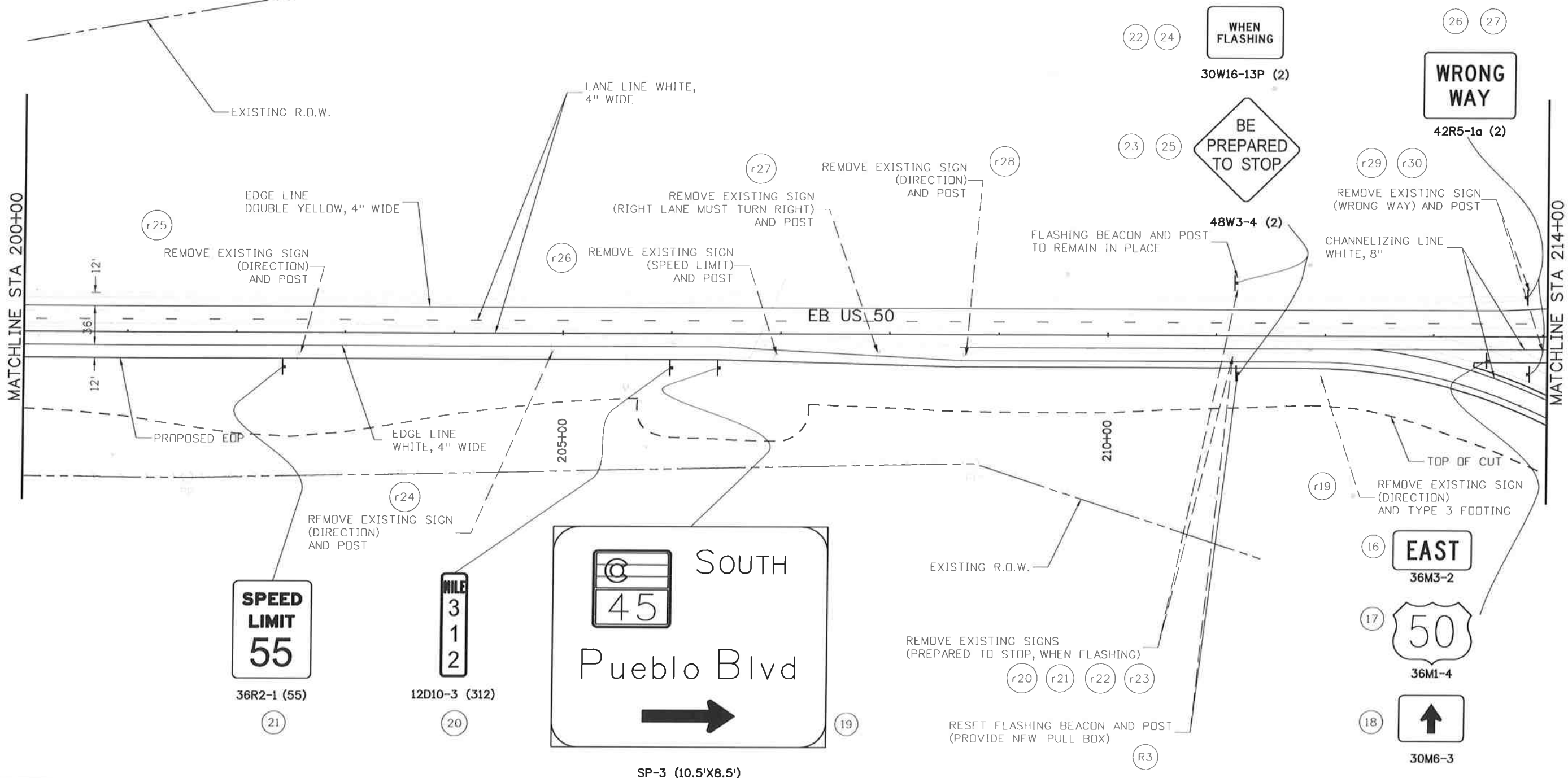

Print Date: 10/9/2014
File Name: 19056Sign_11_Plan.dgn
Horiz. Scale: 1:100 Vert. Scale: As Noted
JFS&A
J. F. SAID AND ASSOCIATES
5898 South Rapp Street
Littleton, Colorado 80120

Sheet Revisions		
Date:	Comments	Init.

Colorado Department of Transportation
CDOT
902 Erie Avenue
Pueblo, CO 81001
Phone: 719-562-5509 FAX: 719-546-5702
Region 2 DTD

As Constructed
No Revisions:
Revised:
Void:

US 50 WEST
PURCELL BLVD. TO WILLS BLVD.
SIGNING AND STRIPING PLAN
Designer: AB Structure
Detailer: AB Numbers
Subset: SN Subset Sheets: SN11 of 18

Project No./Code
FSA 0503-081
19751
Sheet Number 296

c:\noss1\09000_jobs\09400\CDOT US50 Design\04_Design\19056\Design\Drawings\31_Signing_Striping_Plan\19056Sign_11_Plan.dgn

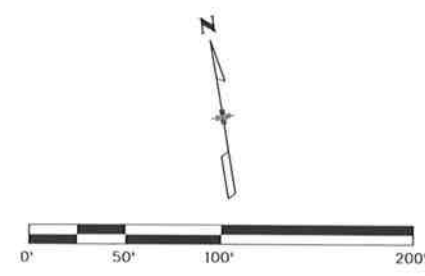
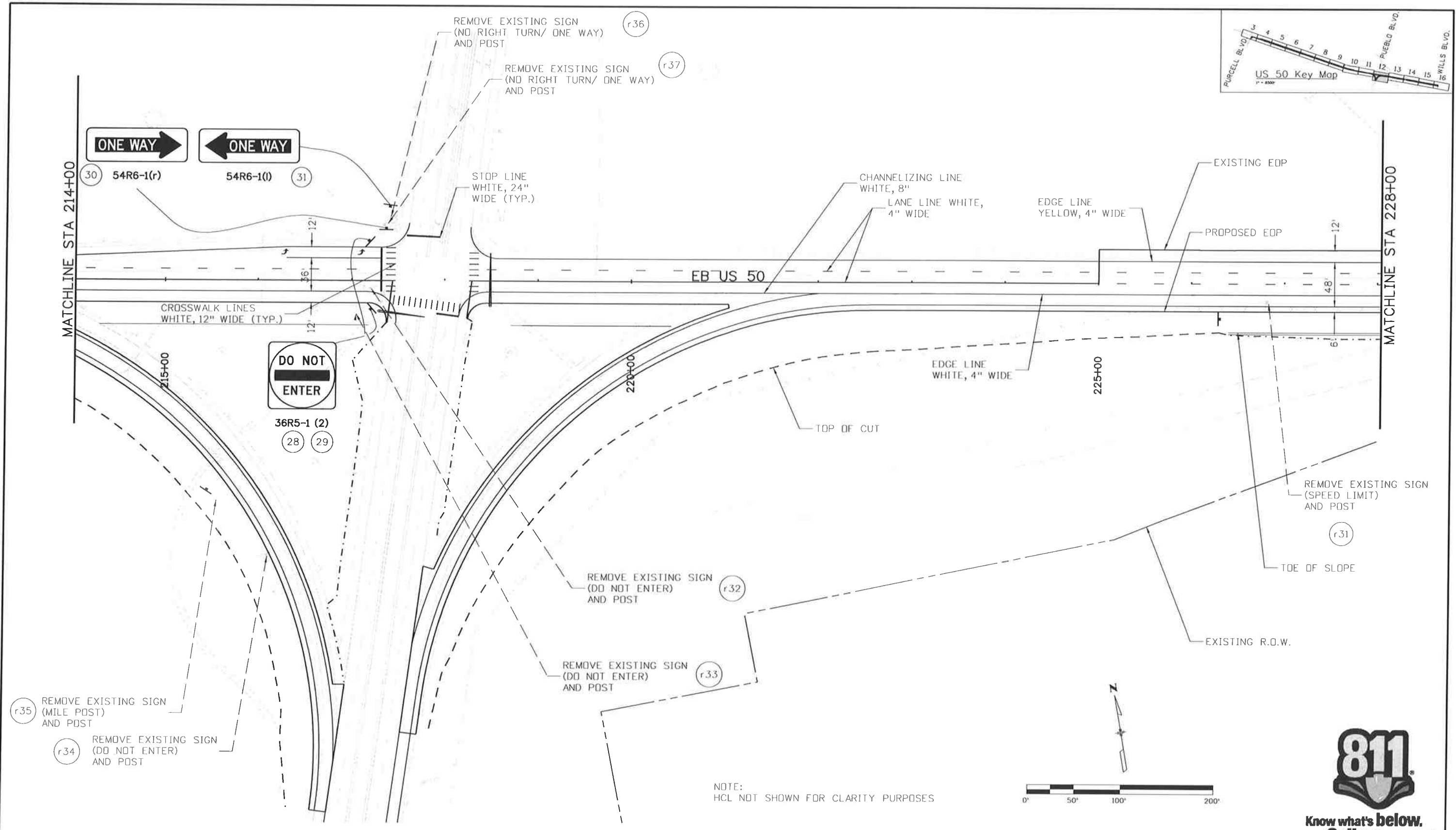
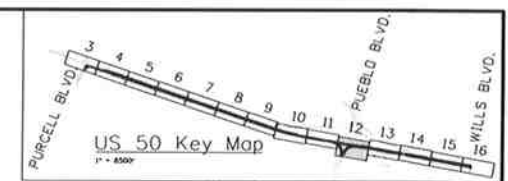

Know what's below.
Call before you dig.

Print Date: 10/9/2014		Sheet Revisions		Colorado Department of Transportation		As Constructed		US 50 WEST: PURCELL BLVD. TO WILLS BLVD. SIGNING AND STRIPING PLAN		Project No./Code	
File Name: 19056Sign_12_Plan.dgn		Date:	Comments	Init.	902 Erie Avenue Pueblo, CO 81001 Phone: 719-562-5509 FAX: 719-546-5702		No Revisions:		Designer: AB		Structure
Horiz. Scale: 1:100 Verl. Scale: As Noted					Region 2		Revised:		Detailer: AB		Numbers
JFS&A J. F. SATO AND ASSOCIATES 5898 South Rapp Street Littleton, Colorado 80120					DTD		Void:		Subset: SN		Subset Sheets: SN12 of 18
0000											19751
											Sheet Number 297
											FSA 0503-081

aboonier:12:4:3:37 PM \\Nesi\0900...jobs\0940E\CDOT US50 Design\04...Design\19056\Design\Drawings\31...Signing...Striping Plan\19056Sign_12_Plan.dgn



Know what's below.
Call before you dig.

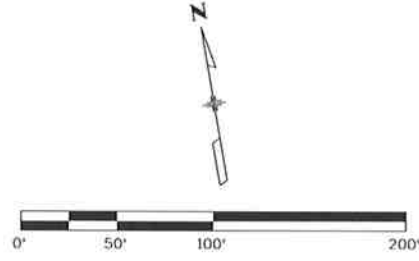

NOTE:
HCL NOT SHOWN FOR CLARITY PURPOSES

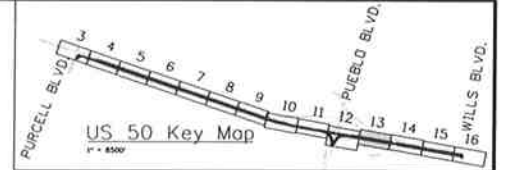

MATCHLINE STA 228+00

MATCHLINE STA 242+00

EAST
36M3-2

50
36M1-4

33

34

EXISTING R.O.W.

EDGE LINE
YELLOW, 4" WIDE

LANE LINE WHITE,
4" WIDE

PROPOSED EOP

EDGE LINE
WHITE, 4" WIDE

TOP OF CUT

TOE OF SLOPE

EXISTING R.O.W.

SPEED
LIMIT
55
36R2-1 (55)

32

STA 229+28.82
D.S. 6' RT

222'

STA 231+50.82
D.S. 12' RT

12'

235+00

230+00

240+00

STA 239+80.27

STA 239+80.27

4' @ 55:1 = 220' SHIFT TAPER

Print Date: 10/9/2014
 File Name: 19056Sign_13_Plan.dgn
 Horiz. Scale: 1:100 Vert. Scale: As Noted

J. F. SATO AND ASSOCIATES
 5898 South Rapp Street
 Littleton, Colorado 80120

Sheet Revisions		
Date:	Comments	Init.

Colorado Department of Transportation

902 Erie Avenue
 Pueblo, CO 81001
 Phone: 719-562-5509 FAX: 719-546-5702

Region 2 DTD

As Constructed	
No Revisions:	
Revised:	
Void:	

US 50 WEST PURCELL BLVD. TO WILLS BLVD. SIGNING AND STRIPING PLAN			
Designer:	AB	Structure	
Detailer:	AB	Numbers	
Subset:	SN	Subset Sheets:	SN13 of 18

Project No./Code	FSA 0503-081
	19751
Sheet Number	298

c:\nast\0900\jobs\0940\cddt\us50\design\04\design\19056\design\drawings\31\signing\striping\plan\19056sign_13_plan.dgn



Know what's below.
Call before you dig.

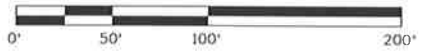
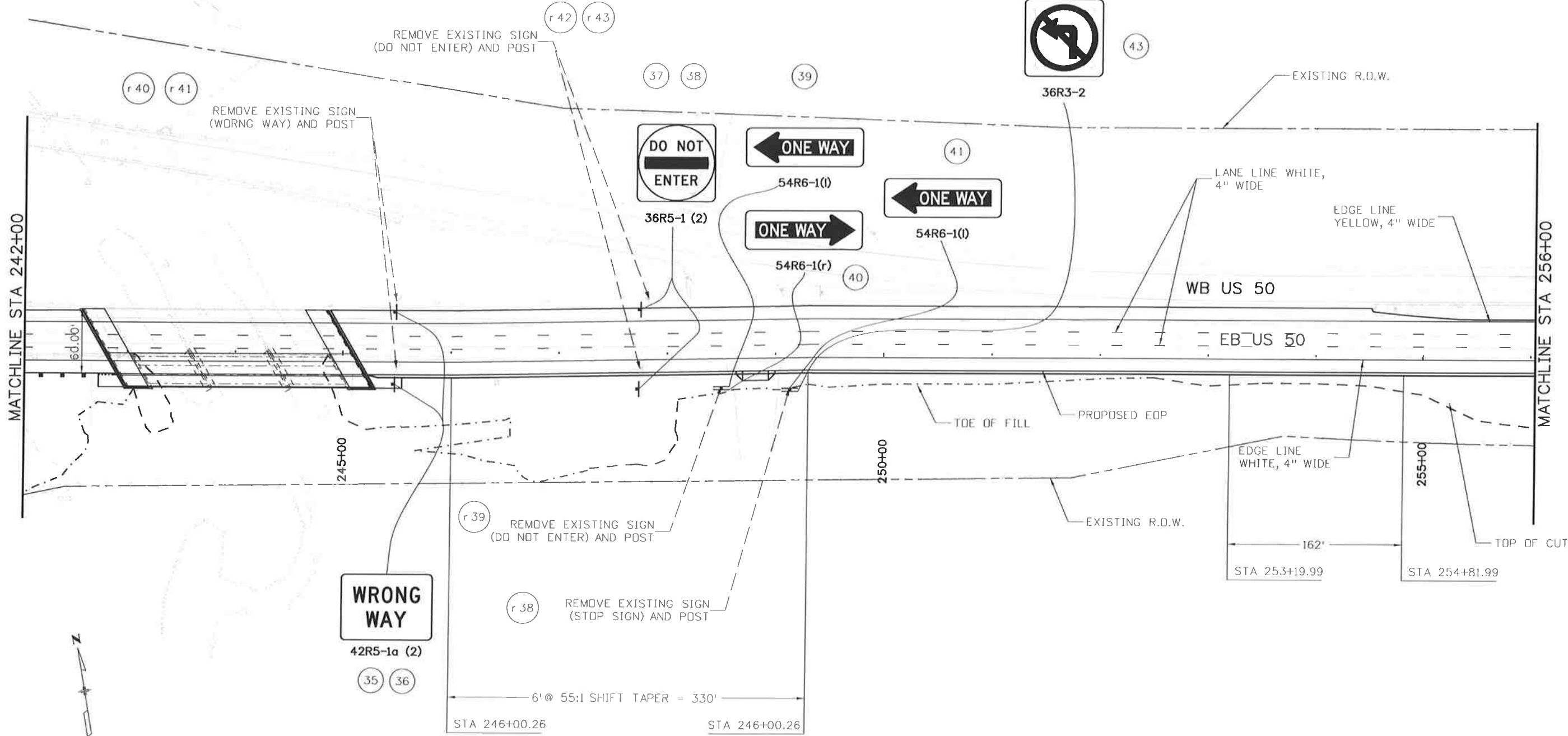
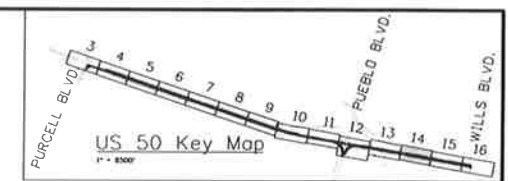

NOTE:
HCL NOT SHOWN FOR CLARITY PURPOSES

Print Date: 10/9/2014		Sheet Revisions		Colorado Department of Transportation		As Constructed		US 50 WEST PURCELL BLVD. TO WILLS BLVD. SIGNING AND STRIPING PLAN		Project No./Code	
File Name: 19056Sign_14_Plan.dgn		Date:	Comments	Init.	902 Erie Avenue Pueblo, CO 81001 Phone: 719-562-5509 FAX: 719-546-5702		No Revisions:		Designer: AB		Structure
Horiz. Scale: 1:100 Vert. Scale: As Noted					Region 2		Revised:		Detailer: AB		Numbers
					DTD		Void:		Subset: SN		Subset Sheets: SN14 of 18
J.F. SATO AND ASSOCIATES 5898 South Rapp Street Littleton, Colorado 80120											19751
											Sheet Number 299

c:\n\109000...obs\09-05\CDOT_US50_Design\04_Design\19056\Design\Drawings\31_Signing_Striping_Plan\19056Sign_14_Plan.dgn



Know what's below.
Call before you dig.

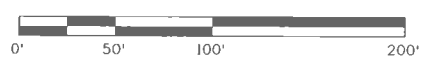
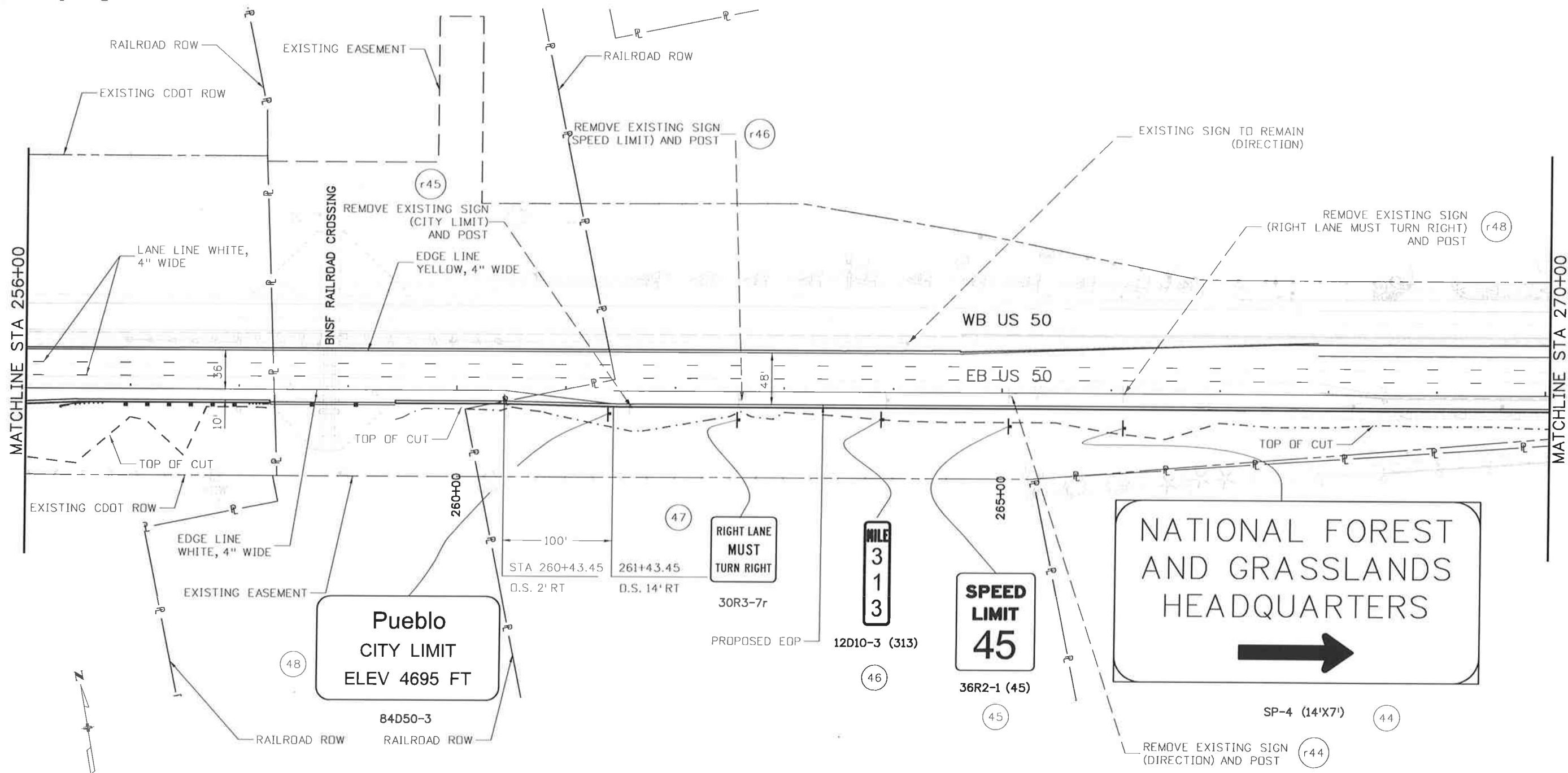
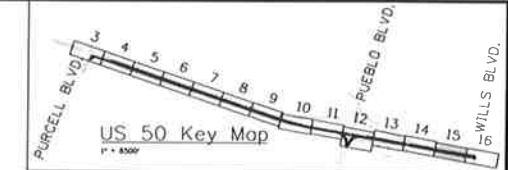

NOTE:
HCL NOT SHOWN FOR CLARITY PURPOSES

Print Date: 10/9/2014	0000	Sheet Revisions			Colorado Department of Transportation 902 Erie Avenue Pueblo, CO 81001 Phone: 719-562-5509 FAX: 719-546-5702 Region 2 DTD	As Constructed		US 50 WEST PURCELL BLVD. TO WILLS BLVD. SIGNING AND STRIPING PLAN	Project No./Code	
File Name: I9056Sign_15_Plan.dgn		Date:	Comments	Init.		No Revisions:	FSA 0503-081			
Horiz. Scale: 1:100 Vert. Scale: As Noted						Revised:	Designer: AB		Structure Numbers	19751
	J. F. SATO AND ASSOCIATES 5898 South Rapp Street Littleton, Colorado 80120				Void:	Detailer: AB	Subset Sheets: SN15 of 18	Sheet Number	300	

aboonert 12:43:53 PM \\nas1\0900...Jobs\0940...CDOT US50 Design\04_Design\19056\Design\Drawings\31_Signing_Striping_Plan\19056Sign_15_Plan.dgn



Know what's below.
Call before you dig.

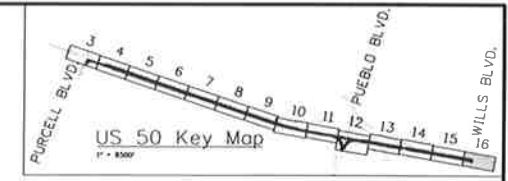

CROSSWALK LINES
WHITE, 24" WIDE
& LONG (TYP.)

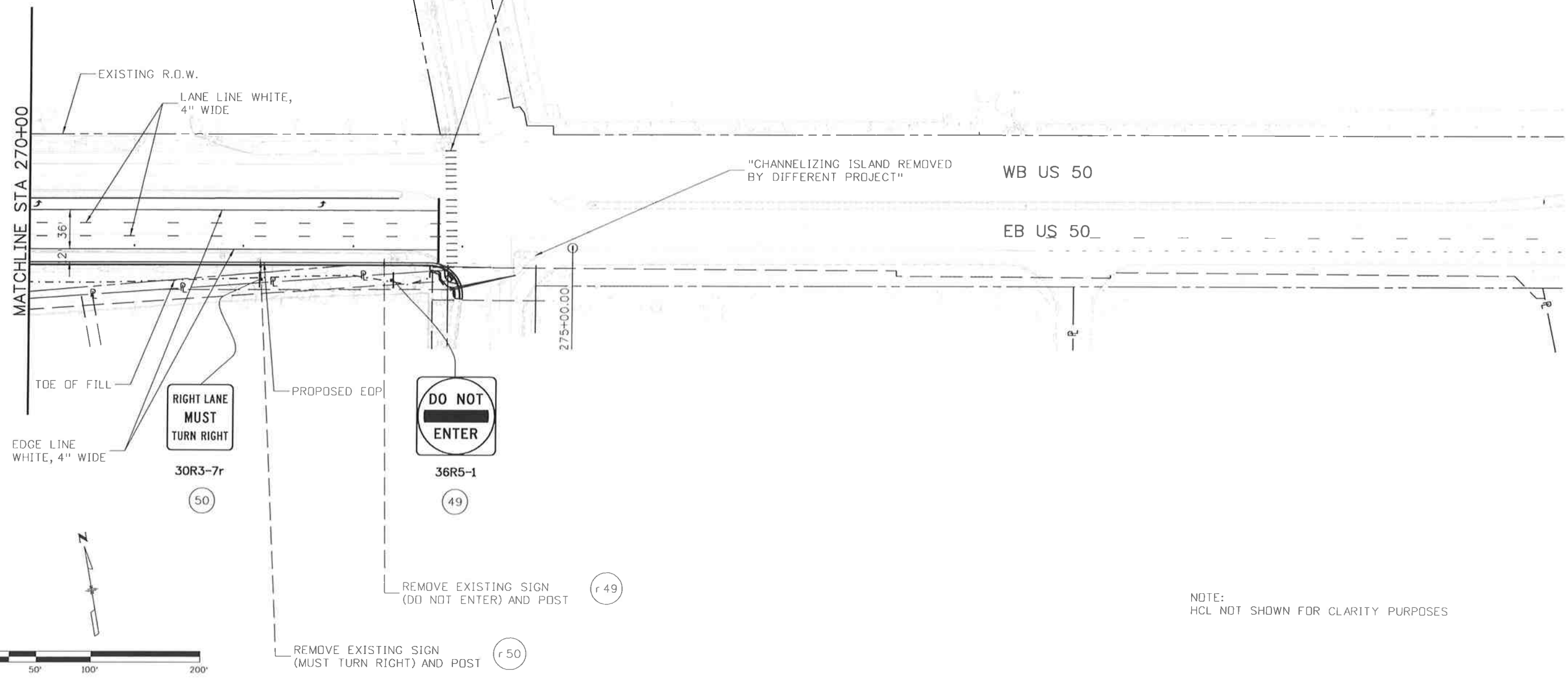

RIGHT LANE
MUST
TURN RIGHT

30R3-7r
50

DO NOT
ENTER

36R5-1
49

REMOVE EXISTING SIGN
(DO NOT ENTER) AND POST

r 49

REMOVE EXISTING SIGN
(MUST TURN RIGHT) AND POST

r 50

NOTE:
HCL NOT SHOWN FOR CLARITY PURPOSES

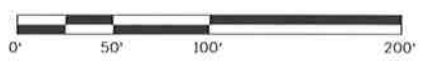

Print Date: 10/9/2014
File Name: 19056Sign_16_Plan.dgn
Horiz. Scale: 1:100 Vert. Scale: As Noted

Sheet Revisions		
Date:	Comments	Init.

Colorado Department of Transportation

902 Erie Avenue
Pueblo, CO 81001
Phone: 719-562-5509 FAX: 719-546-5702

Region 2 DTD

As Constructed

No Revisions:

Revised:

Void:

US 50 WEST PURCELL BLVD. TO WILLS BLVD. SIGNING AND STRIPING PLAN			
Designer:	AB	Structure	
Detailer:	AB	Numbers	
Subset:	SN	Subset Sheets:	SN16 of 18

Project No./Code

FSA 0503-081

19751

Sheet Number 301

J. F. SATO AND ASSOCIATES
5898 South Rapp Street
Littleton, Colorado 80120

aboonlert 12:44:02 PM \\Nesi\1_0900_Jobs\09404\CDOT_US50_Design\04_Design\19056\Design\Drawings\31_Signing_Striping_Plan\19056Sign_16_Plan.dgn

aboonert 12:44:07 PM \\nas1\0900_Jobs\0940\1 CDOT US50 Design\04_Design\19056\Design\Drawings\3_Signing_Striping\Plan\19056_Sign_Class 3 Xsec_16.dgn

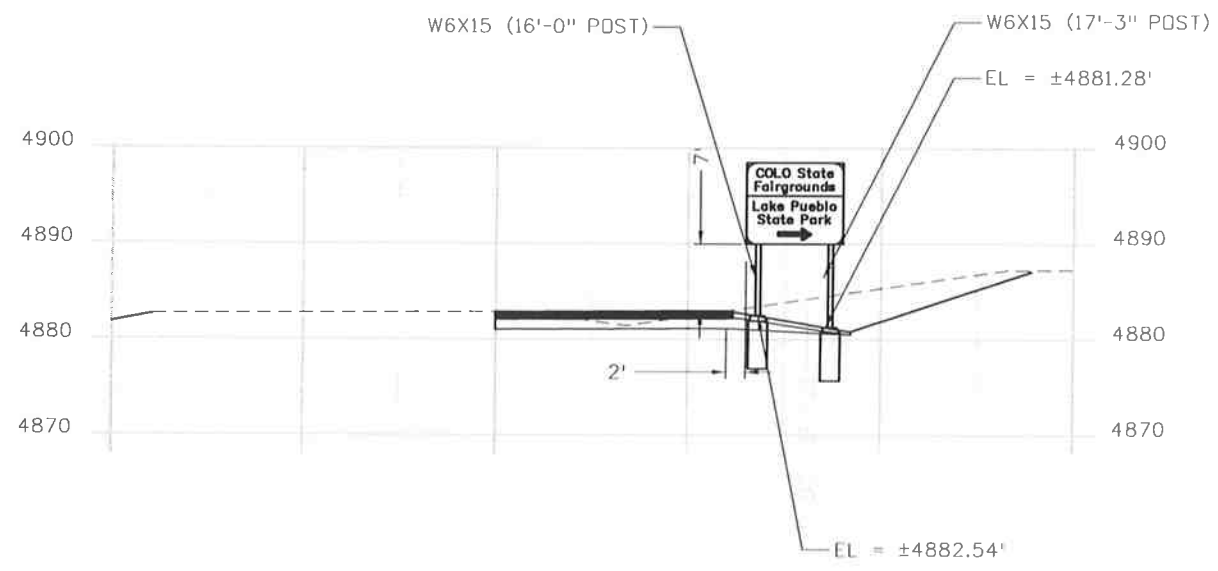

US 50 EB STA. 194+44
SP-1 (10'-0"X8'-6")

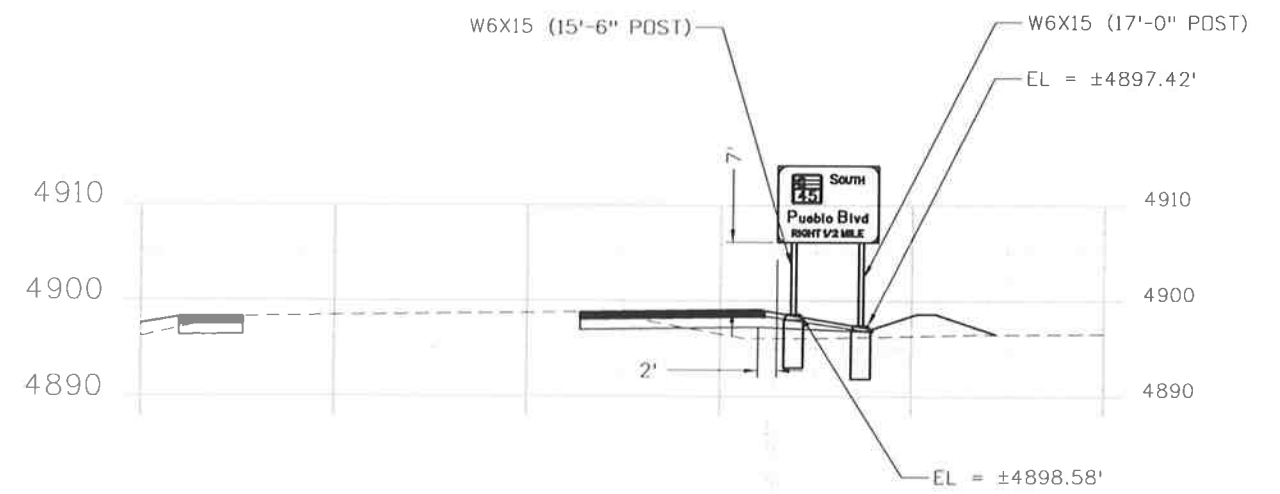

US 50 EB STA. 186+24
SP-2 (10'-6"X8'-0")

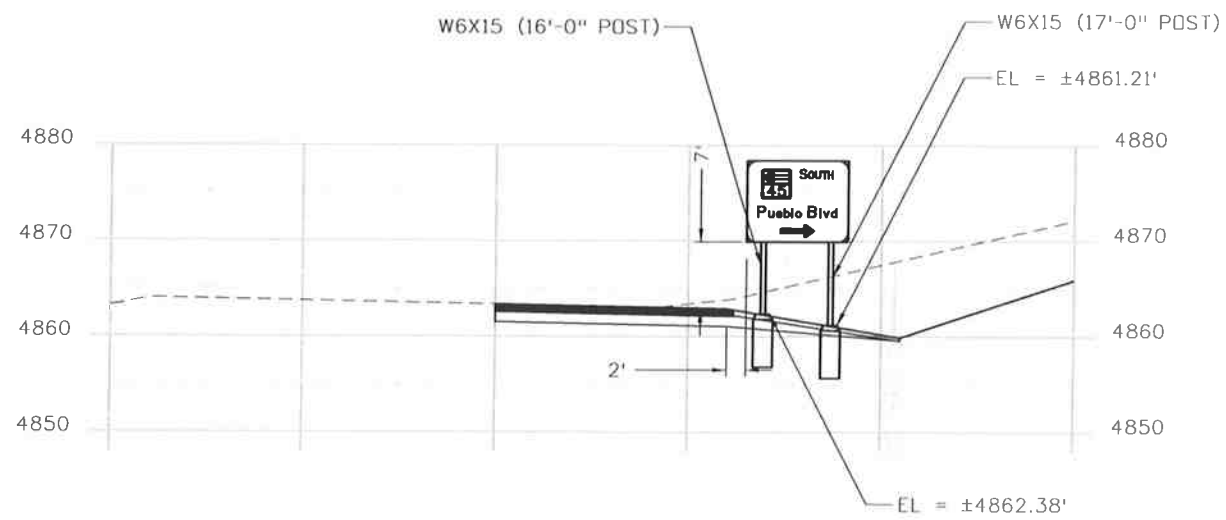

US 50 EB STA. STA. 206+44
SP-3 (10'-6"X8'-6")

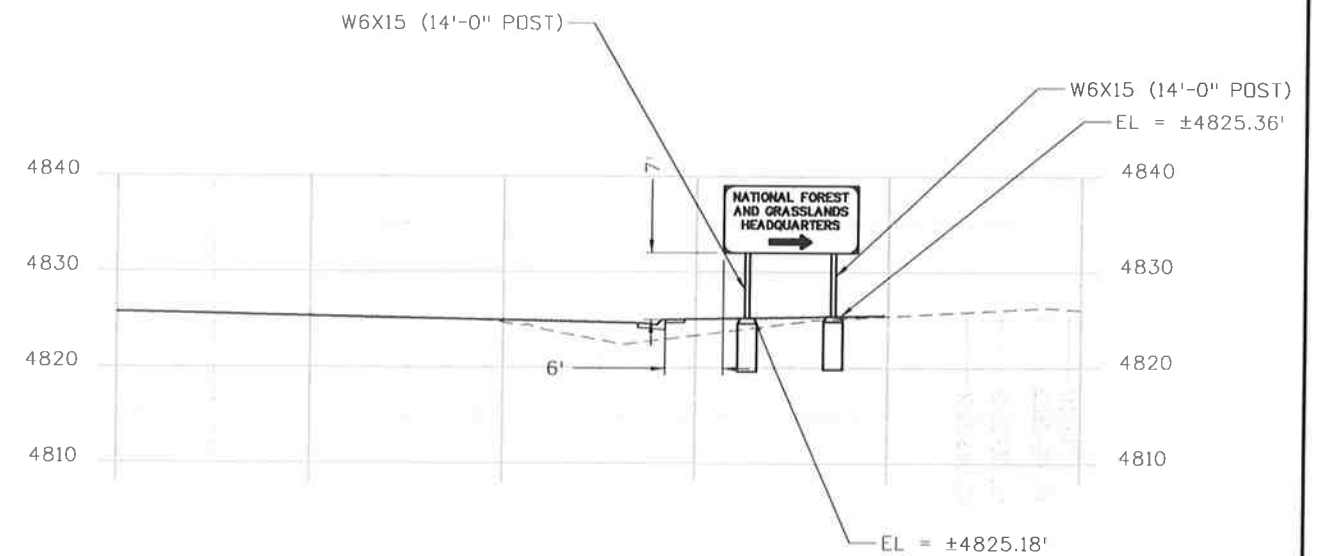

US 50 EB STA. 266+13
SP-4 (14'-0"X7'-0")

Print Date: 10/9/2014	
File Name: 19056_Sign_Class 3 Xsec_16.dgn	
Horiz. Scale: 1:20	Vert. Scale: As Noted
 J.F. SATO AND ASSOCIATES 5898 South Rapp Street Littleton, Colorado 80120	

Sheet Revisions		
Date:	Comments	Init.

Colorado Department of Transportation
 902 Erie Avenue
 Pueblo, CO 81001
 Phone: 719-562-5509 FAX: 719-546-5702
Region 2 **DTD**

As Constructed
No Revisions:
Revised:
Void:

US 50 WEST PURCELL BLVD. TO WILLS BLVD. Class III X-Sections	
Designer: AB	Structure Numbers
Detailer: AB	
Subset: SN	Subset Sheets: SN17 of 18

Project No./Code
FSA 0503-081
19751
Sheet Number 302

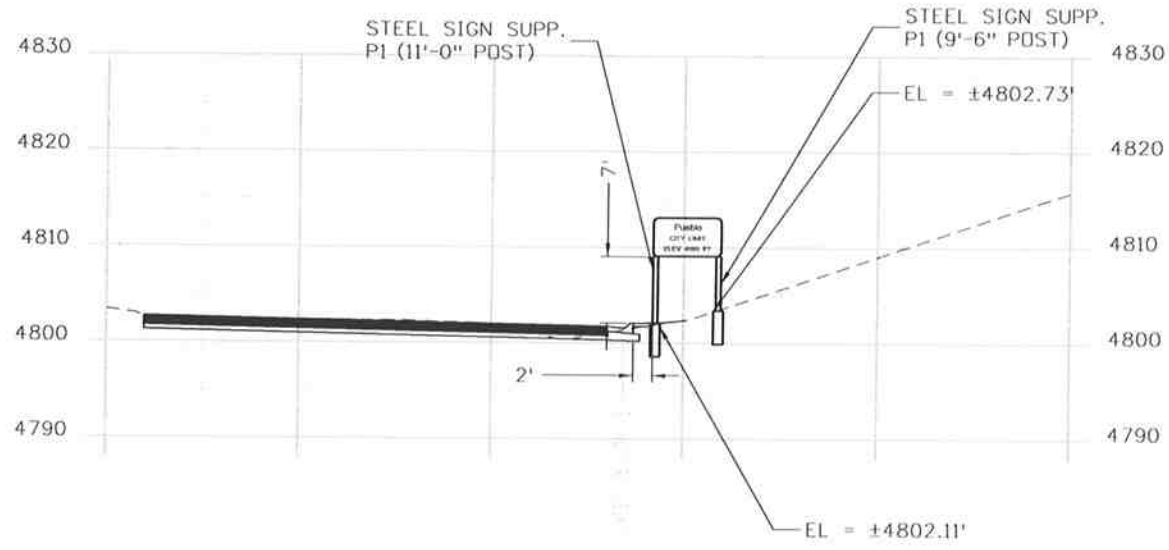

US 50 EB STA. 261+40
 D50-3 (7'-0"X4'-0")
 (SIGN # 48)

Print Date: 10/9/2014
 File Name: 19056_Sign_Class 3 Xsec_17.dgn
 Horiz. Scale: 1:20 Vert. Scale: As Noted

JFS&A
 J. F. SATO AND ASSOCIATES
 5898 South Rapp Street
 Littleton, Colorado 80120



Sheet Revisions

Date:	Comments	Init.

Colorado Department of Transportation



Region 2

902 Erie Avenue
 Pueblo, CO 81001
 Phone: 719-562-5509 FAX: 719-546-5702

DTD

As Constructed

No Revisions:
Revised:
Void:

**US 50 WEST
 PURCELL BLVD. TO WILLS BLVD.
 Class III X-Sections**

Designer:	AB	Structure	
Detailer:	AB	Numbers	
Subset:	17	Subset Sheets: SN18 of	18

Project No./Code

FSA 0503-081
19751
Sheet Number 303

e:\projects\19056\jobs\09406\CDOT US50 Design\04_Design\19056\Design\Drawings\31_Signing\Stripping_Plan\19056_Sign_Class 3 Xsec_17.dgn
 12:44:11 PM



Know what's below.
Call before you dig.

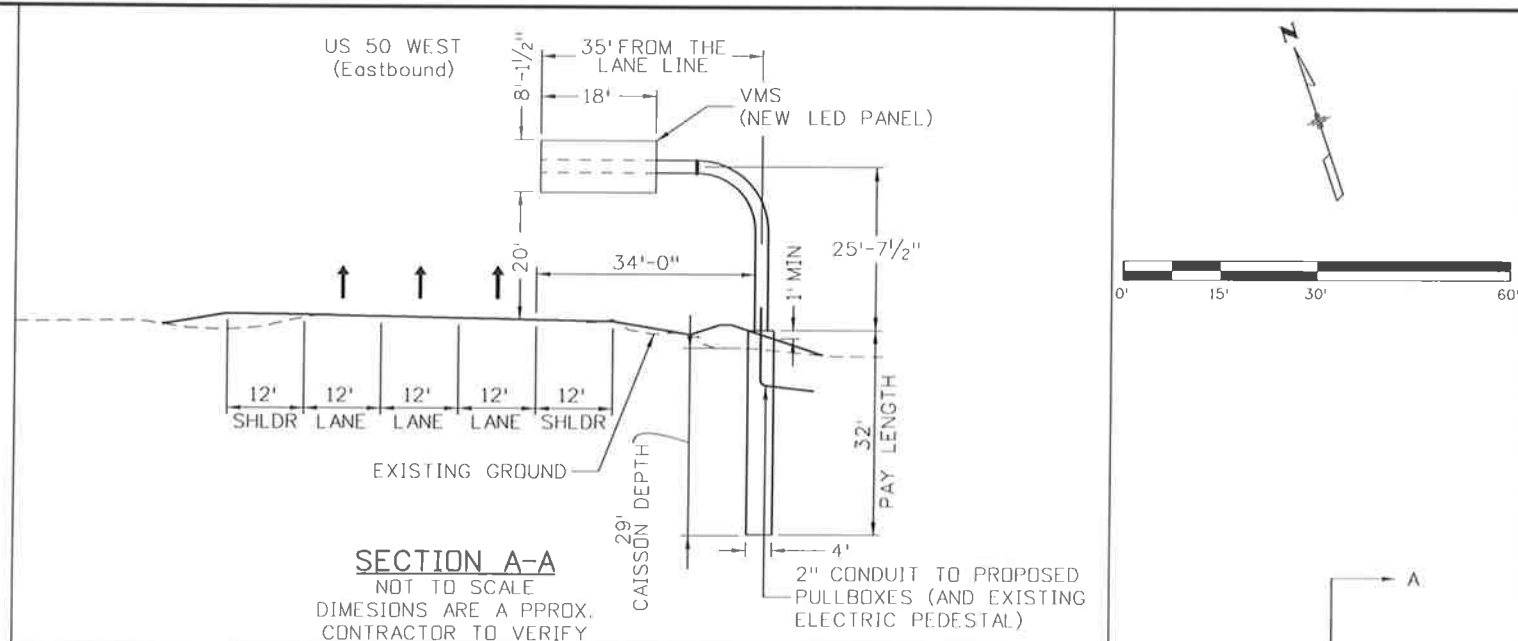

TABULATION OF ITS ENGINEERING ITEMS			
ITEM NO.	DESCRIPTION	UNIT	QTY.
202-00720	REMOVAL OF CCTV CAMERA	EA	1
202-00750	REMOVAL OF LUMINAIRE	EA	1
202-00805	REMOVAL OF OVERHEAD SIGN STRUCTURE	EA	1
202-00827	REMOVAL OF PULL BOX	EA	1
210-00750	RESET LIGHT STANDARD	EA	1
503-00048	DRILLED CAISSON (48 INCH)	LF	32
604-39050	MANHOLE (TRAFFIC MANAGEMENT SYSTEM)*	EA	4
613-00200	2 INCH ELECTRICAL CONDUIT	LF	90
613-07023	PULL BOX (24"X36"X24")	EA	2
613-07039	PULL BOX (30"X48"X18")**	EA	1
613-10000	WIRING***	LS	0.25
613-13006	LUMINARE (LED) (8500 LUMENS)	EA	1
613-40010	LIGHT STANDARD FOUNDATION	EA	1
614-10147	VARIABLE MESSAGE SIGN LED (OVERHEAD)	EA	1
614-32400	MONOTUBE OVERHEAD SIGN CANTILEVER (24 INCH DIAMETER)	EA	1
614-87010	FIBER OPTIC CABLE (SINGLE MODE) (12 STRAND)	LF	50
614-87524	SPLICE FIBER OPTIC CABLE (24 STRAND)	EA	1

* 1 MANHOLE AT VMS AND 3 FOR FIBER OPTIC LINE IN PLACE OF PULL BOX AT STA 148+53.75, STA. 220+36.58 AND STA 246+42.57
 ** PULL BOX TO REPLACE EXISTING FIBER OPTIC LINE PULL BOX AT STA 205+58.08
 *** REMAINING WIRING LS QUANTITY FOR TRAFFIC SIGNALS AND OTHER ITEMS
 TAB. OF ITS ITEMS CARRIED FORWARD TO SUMMARY OF TRAFFIC ENGINEERING ITEMS AND PROVIDED HERE FOR INFO ONLY

- NOTE:
- 1) ELECTRICAL LINE TO BE ADJUSTED BY APPROPRIATE UTILITY OWNER PRIOR TO VMS PLACEMENT AND LIGHT STANDARD RESET. CDOT SHALL BE INVOLVED IN DISCUSSIONS DURING UTILITY PLANNING AND PLACEMENT.
 - 2) UTILITY LOCATIONS ARE BASED ON BEST AVAILABLE INFORMATION. CONTRACTOR TO COORDINATE WITH CDOT AND APPROPRIATE UTILITY OWNERS PRIOR TO COMMENCEMENT OF WORK.
 - 3) COST OF RESET OF MARKER IS INCLUDED IN THE COST OF VMS.
 - 4) CONTRACTOR TO COORDINATE WITH CDOT REGION2 TRAFFIC REGARDING EXISTING ITS EQUIPMENT AND FINAL LOCATION OF ALL EQUIPMENT BEFORE INSTALLATION.
 - 5) FIBER OPTIC RUN, ELECTRICAL AND OTHER SERVICE CONDUITS SHALL GO DIRECTLY INTO THE STRUCTURE CAISSON FROM THE PULLBOXES. FIBER PULLBOX SHALL BE PLACED A MAXIMUM OF 10 FEET FROM VMS LOCATION.
 - 6) MAINTAIN EXISTING POWER SOURCE.
 - 7) LENGTH AND HEIGHT OF SUPPORT POLE IS APPROXIMATE. THE CONTRACTOR SHALL SURVEY TO DETERMINE ACTUAL POST LENGTH AND HEIGHT. CDOT REVIEW AND APPROVAL SHALL BE OBTAINED PRIOR TO FABRICATION.

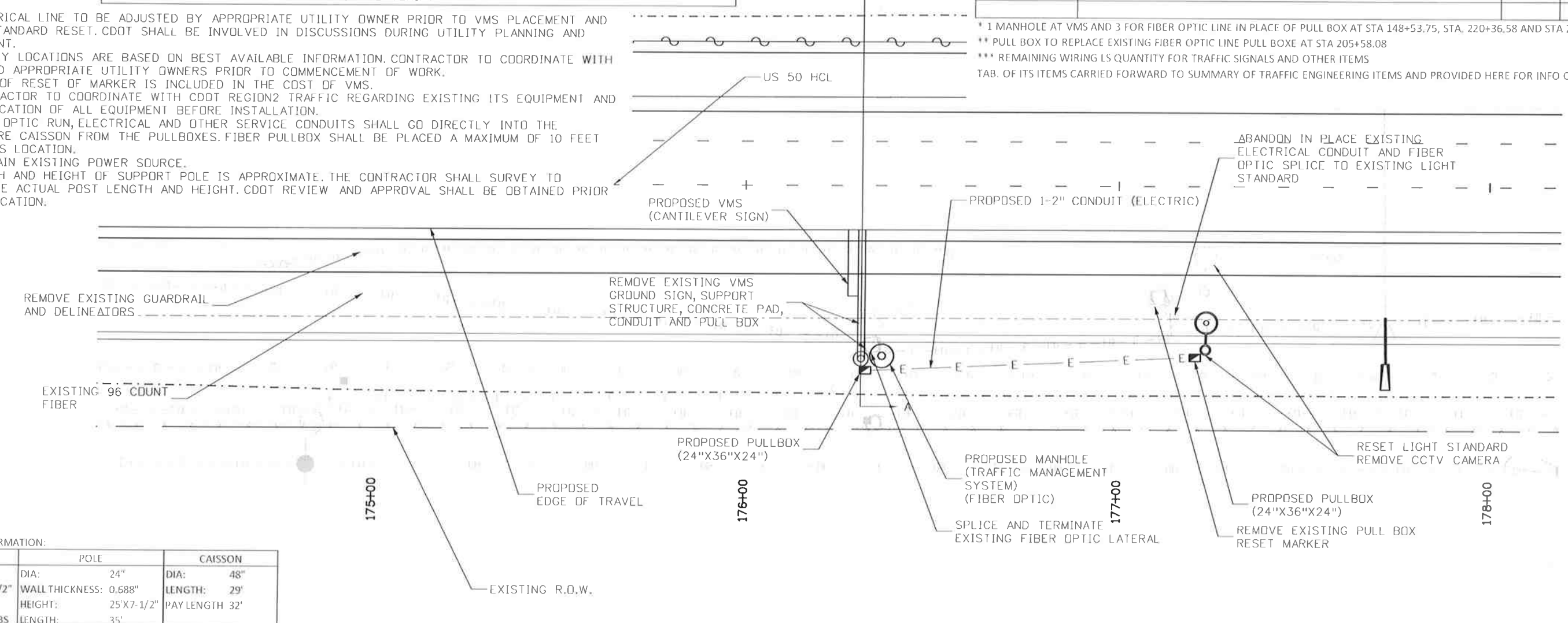

STRUCTURE INFORMATION:

VMS	POLE	CAISSON
LENGTH: 18'	DIA: 24"	DIA: 48"
WIDTH: 8'X1-1/2"	WALL THICKNESS: 0.688"	LENGTH: 29'
DEPTH: 46"	HEIGHT: 25'X7-1/2"	PAY LENGTH 32'
WEIGHT: 3000 LBS	LENGTH: 35'	

Print Date: 10/9/2014
 File Name: 19056 ITS-01.dgn
 Horiz. Scale: 1:30 Vert. Scale: As Noted

JFS&A
 J. F. SATO AND ASSOCIATES
 5898 South Rapp Street
 Littleton, Colorado 80120

Sheet Revisions		
Date:	Comments	Init.

Colorado Department of Transportation
 902 Erie Avenue
 Pueblo, CO 81001
 Phone: 719-562-5509 FAX: 719-546-5702

Region 2 **DTD**

As Constructed
No Revisions:
Revised:
Void:

US 50 WEST ITS VMS	
Designer: GV	Structure Numbers
Detailer: ACE	
Subset: ITS	Subset Sheets: ITS1 of 1

Project No./Code
FSA 0503-081
19751
Sheet Number 304

aboonier 12:45:00 PM \\nas1\0900_jobs\0940\CDOT US50 Design\04_Design\19056\Design\Drawings\32 ITS\19056 ITS-01.dgn

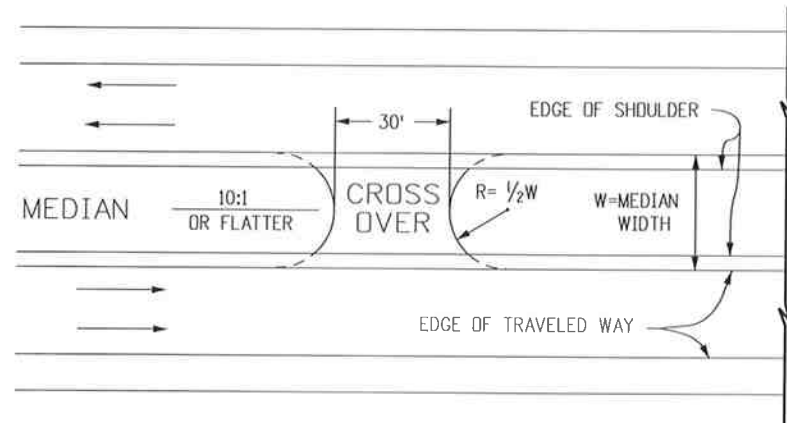

MEDIAN WIDTH LESS THAN 50 FT.

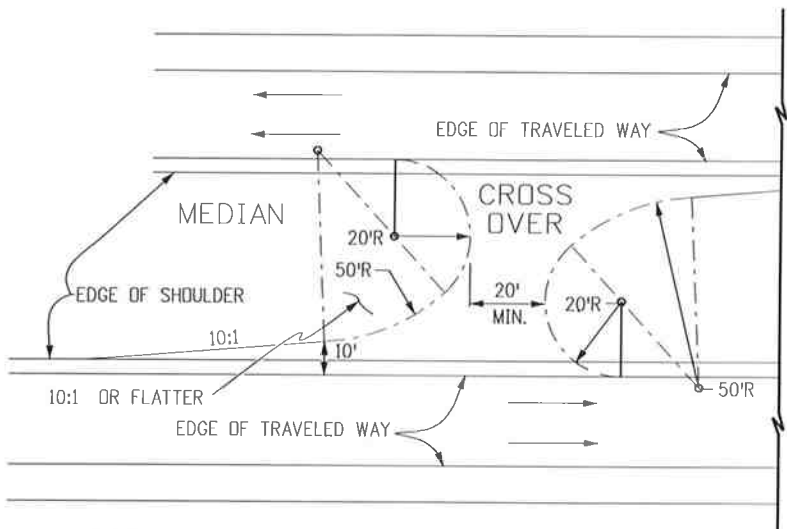

MEDIAN WIDTH GREATER THAN 50 FT.

TYPICAL PLANS FOR EMERGENCY MEDIAN CROSS OVER

LOCATION OF RADIUS POINTS MAY BE ADJUSTED FOR BEST FIT

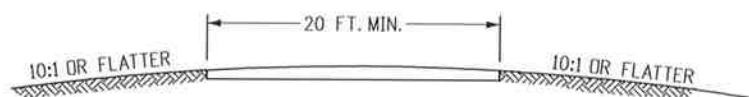

TYPICAL SECTION FOR MEDIAN CROSS OVER

ANY REQUIRED PIPE OR INLET FOR MEDIAN DRAINAGE SHALL HAVE A TRAVERSABLE DESIGN AS SPECIFIED ON THE PLANS

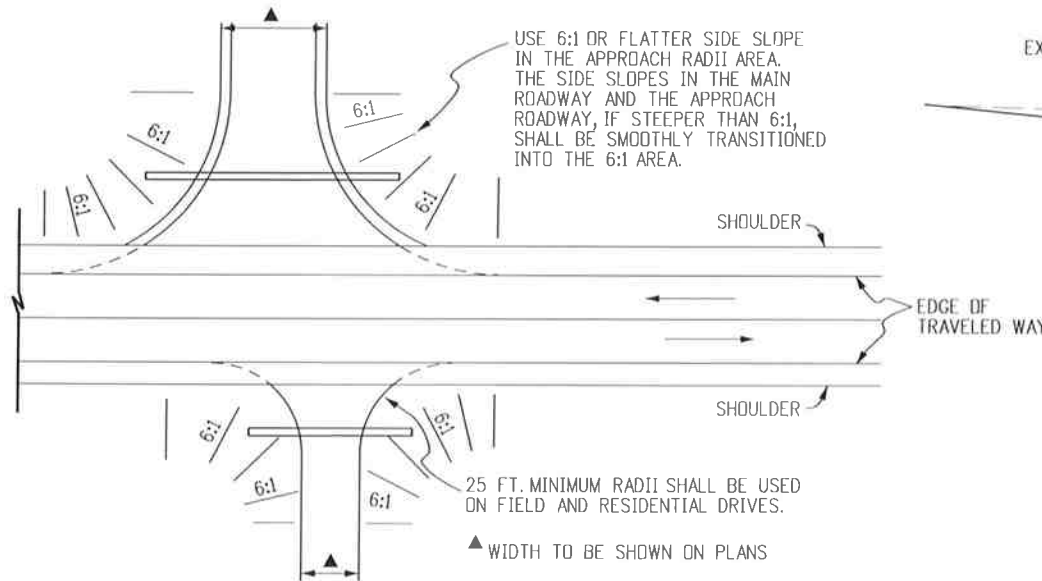

SIDE DRAINS SHALL BE LOCATED BEYOND THE CLEAR ZONE, OR WHEN WITHIN THE CLEAR ZONE, THEY SHALL BE INSTALLED WITH END SECTIONS CONFORMING TO A 6:1 SLOPE. FIFTY FT. RADII SHALL BE USED ON INTERSECTING ROADS, EXCEPT FOR FIELD AND RESIDENTIAL DRIVES OR UNLESS OTHERWISE SPECIFIED ON PLANS. RADII MAY BE VARIED TO SUIT FIELD CONDITIONS.

TYPICAL PLANS FOR SIDE APPROACH ROAD

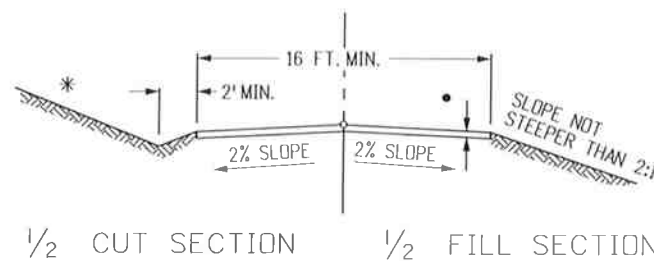

TYPICAL SECTION FOR APPROACH (ACCESS) ROAD

NOTE: ROAD APPROACHES WHICH REQUIRE HMA (ASPHALT) PAVEMENT SHALL BE PLACED AT THE FOLLOWING DISTANCES BACK FROM THE ROADWAY EDGE OF PAVEMENT:

1. RESIDENTIAL OR AGRICULTURAL FIELD ENTRANCES - PAVE 4 FEET BACK.
2. THREE OR MORE RESIDENCES OR COMMERCIAL PROPERTY - PAVE 20 FEET BACK OR TO ROW LINE, WHICHEVER IS LESS.
3. PUBLIC STREET - PAVE 50 FEET BACK OR TO ROW LINE, WHICHEVER IS LESS.
4. IF EXISTING ACCESS IS PAVED, THEN FEATHER NEW ASPHALT OVERLAY A MINIMUM OF 2 FEET BACK OR AS DIRECTED BY THE ENGINEER.

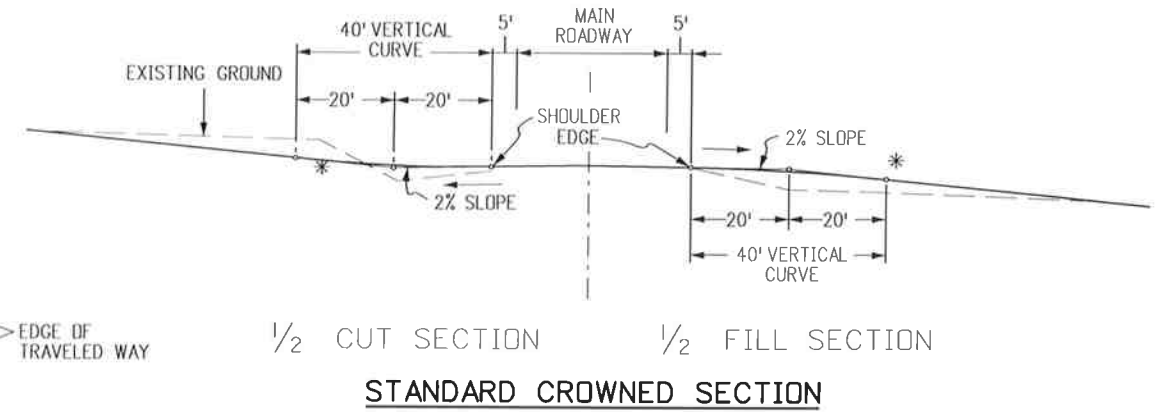

STANDARD CROWNED SECTION

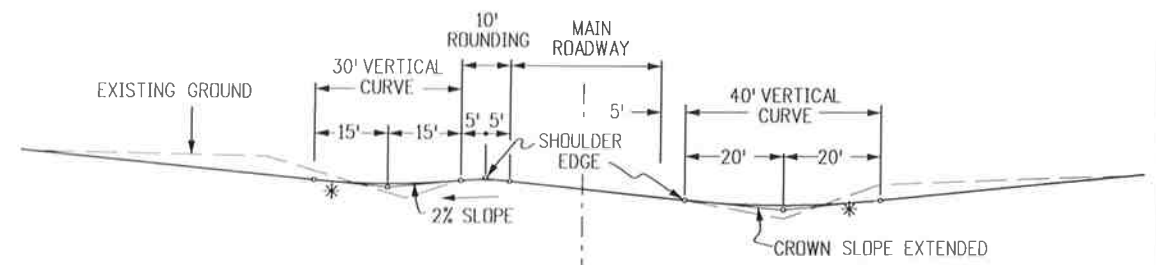

SUPERELEVATED CUT SECTION

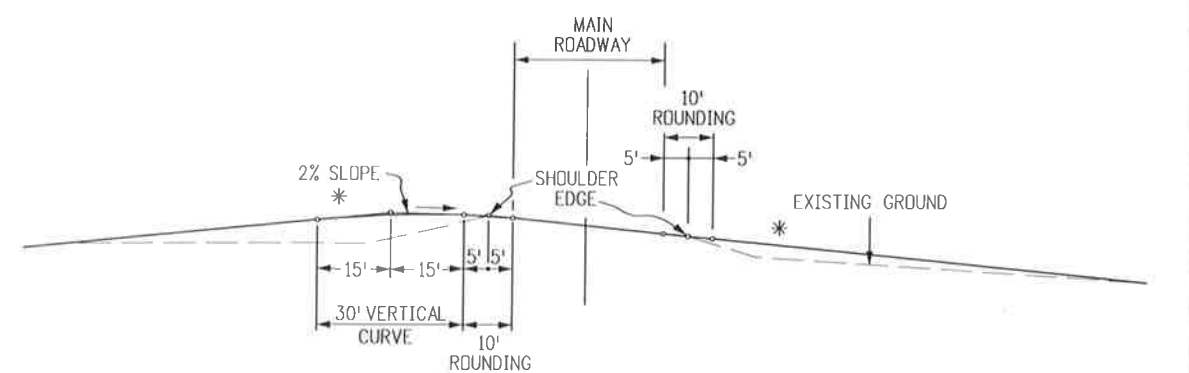

SUPERELEVATED FILL SECTION

VERTICAL ALIGNMENT SIDE APPROACH ROADS INTERSECTING MAIN ROADWAY

* TANGENT SLOPE NOT STEEPER THAN 8% BEYOND THE VERTICAL CURVE. THE SLOPE MAY BE STEEPER, IF REQUIRED, TO MEET EXISTING APPROACH SLOPE. HOWEVER, APPROACH ROAD SLOPE SHOULD NOT BE STEEPER THAN EXISTING SLOPE.

Computer File Information	
Creation Date: 07/04/12	Initials: DD
Last Modification Date: 07/08/13	Initials: LTA
Full Path: www.coloradodot.info/business/designsupport	
Drawing File Name: 203010101.dgn	
CAD Ver.: MicroStation V8 Scale: Not to Scale Units: English	

Sheet Revisions	
Date:	Comments
07/08/13	Added notes to Approach Road Typ. Sec. detail.

Colorado Department of Transportation

 4201 East Arkansas Avenue
 Denver, Colorado 80222
 Phone: (303) 757-9083
 Fax: (303) 757-9820
 Project Development Branch DD/LTA

APPROACH ROADS
 Issued By: Project Development Branch July 4, 2012

STANDARD PLAN NO.
 M-203-1
 Sheet No. 1 of 1

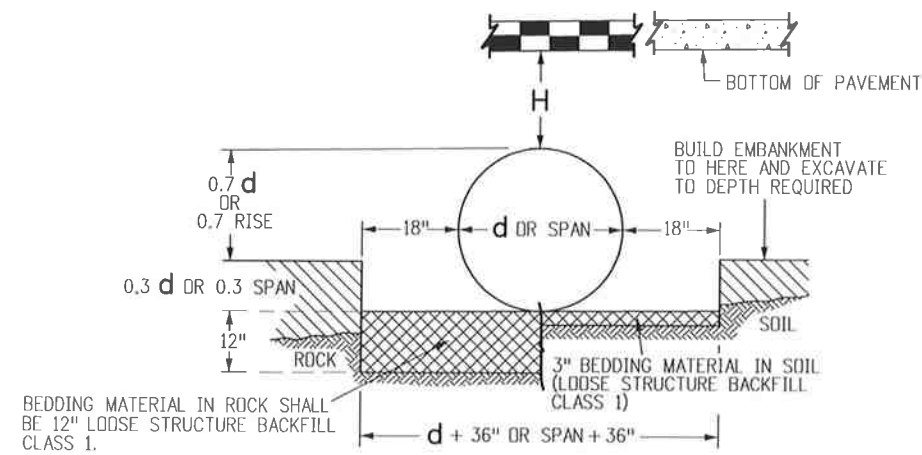

INSTALLATION OF METAL PIPE

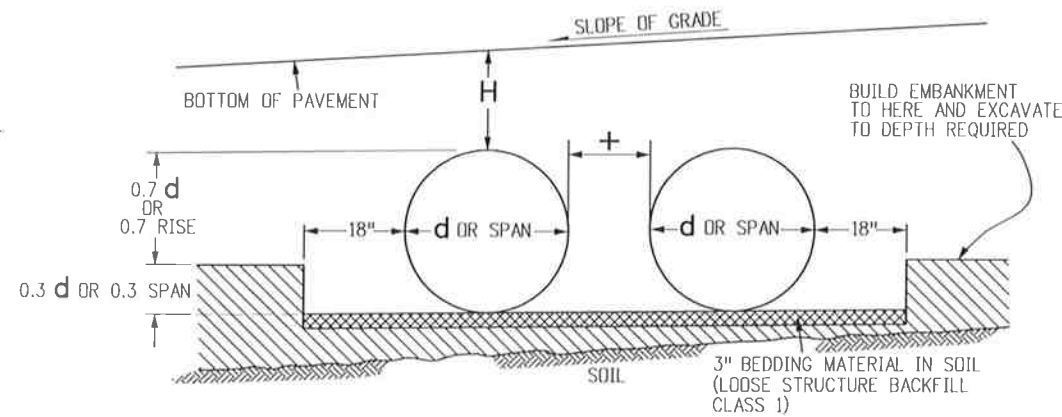

INSTALLATION OF MULTIPLE METAL PIPES

GENERAL NOTES

1. STEEL PIPES SHALL CONFORM TO THE REQUIREMENTS OF AASHTO M36. ALUMINUM PIPES SHALL CONFORM TO THE REQUIREMENTS OF AASHTO M196. ALUMINIZED STEEL SHALL CONFORM TO THE REQUIREMENTS OF AASHTO M274.
2. MINIMUM COVER SHALL BE PROVIDED DURING CONSTRUCTION TO PROTECT THE STRUCTURE FROM DAMAGE.
3. PIPE SHALL BE PLACED WITH LONGITUDINAL SEAMS AT THE SIDES OR QUARTER POINTS BUT NOT ALONG TOP OF VERTICAL AXIS.
4. STRUCTURAL PLATE PIPES OF EQUAL OR GREATER DIAMETER THAT CONFORM TO SECTION 510 MAY BE SUBSTITUTED FOR THE PIPES ON THESE SHEETS AT THE CONTRACTOR'S EXPENSE.
5. WHEN A PIPE IS TO BE EXTENDED, THE SAME PIPE MATERIAL AND SIZE AS IN THE ORIGINAL INSTALLATION SHALL BE USED.
6. EXTENSIONS FOR CMP ARCH PIPE SHALL MATCH THE CORRUGATIONS, AND THE SPAN AND RISE DIMENSIONS OF THE PIPE TO BE EXTENDED.
7. WHEN INSTALLING A GUARDRAIL OR A SIGN POST DIRECTLY ABOVE A PIPE, THE BOTTOM OF THE POST MUST BE AT LEAST 1 FOOT ABOVE THE TOP OF THE PIPE. THE HOLE FOR THE POST SHALL BE DRILLED INTO THE SOIL.
8. PIPE ARCH WITH EQUAL PERIPHERY AND WITH SPAN AND RISE DIMENSIONS APPROXIMATELY EQUAL TO THOSE SPECIFIED ON THE PLANS WILL BE PERMITTED.
9. PIPE ARCH IS INTENDED FOR USE WHERE MINIMUM COVER REQUIREMENTS FOR ROUND PIPE CANNOT BE MET. WHEN COVER EXCEEDS 11 FT. USE ROUND PIPE.
10. PIPE COVER GREATER THAN 90 FT. SHALL REQUIRE AN INVESTIGATION OF THE FOUNDATION MATERIAL.

LEGEND

H = THE MAXIMUM ALLOWABLE HEIGHTS OF FILL OVER THE TOP OF THE PIPE, EXCLUDING PAVEMENT THICKNESS, ARE SHOWN IN THE TABLES OF THIS STANDARD.

THE MINIMUM COVER SHALL BE AS SHOWN ON THESE TABLES OR CONFORM TO AASHTO REQUIREMENTS, WHICHEVER IS GREATER.

THE MINIMUM COVER FOR PIPE IS MEASURED FROM THE TOP OF THE PIPE TO THE BOTTOM OF THE PAVEMENT; HMA OR PCCP.

THE MINIMUM COVER IS MEASURED FROM THE TOP OF THE PIPE TO THE TOP OF THE SUBGRADE FOR CONSTRUCTION LOADS.

L₁ = LENGTH OF PIPE TO BE MEASURED WHEN PLACED IN ACCORDANCE WITH SECTION 624.

L₂ = LENGTH OF PIPE TO BE MEASURED WHEN PLACED IN ACCORDANCE WITH SECTION 603.

+ = THE MINIMUM SPACING BETWEEN THE OUTSIDE WALLS OF MULTIPLE PIPES OR END SECTIONS IS 18" OR 1/2 **d**, WHICHEVER IS GREATER, BUT NOT TO EXCEED 36".

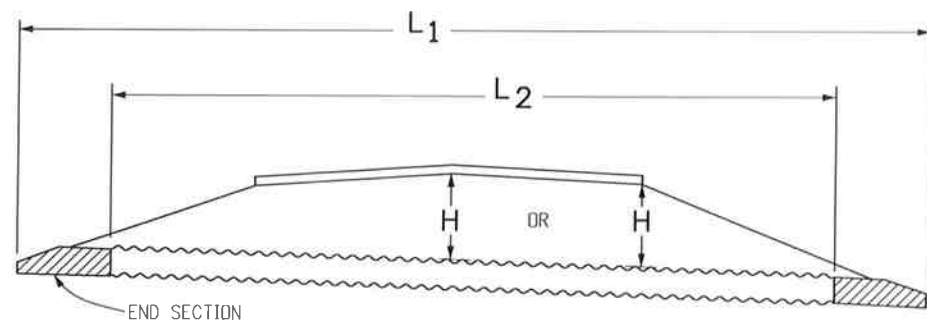

METAL PIPE WITH END SECTIONS

NOTE: USE THE **H** THAT IS GREATER FOR MAXIMUM ALLOWABLE FILL HEIGHT.

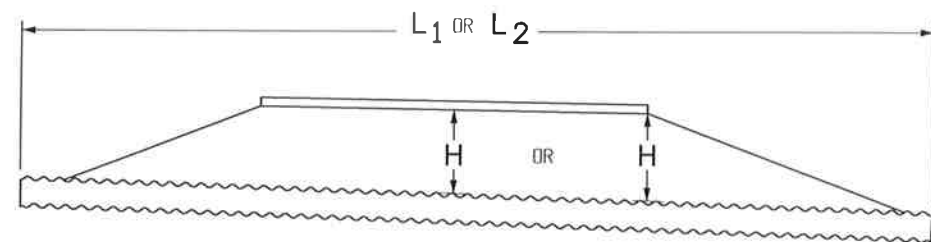

METAL PIPE WITHOUT END SECTIONS

NOTE: USE THE **H** THAT IS GREATER FOR MAXIMUM ALLOWABLE FILL HEIGHT.

PIPE SPAN (IN.)	MINIMUM COVER (IN.) FOR INDICATED AXLE LOADS, kips			
	18.0 - 50.0	50.0 - 75.0	75.0 - 110.0	110.0 - 150.0
12.0 - 42.0	24	30	36	36
48.0 - 72.0	36	36	42	48
78.0 - 120.0	36	42	48	48
126.0 - 144.0	42	48	54	54

MINIMUM COVER FOR CONSTRUCTION LOADS

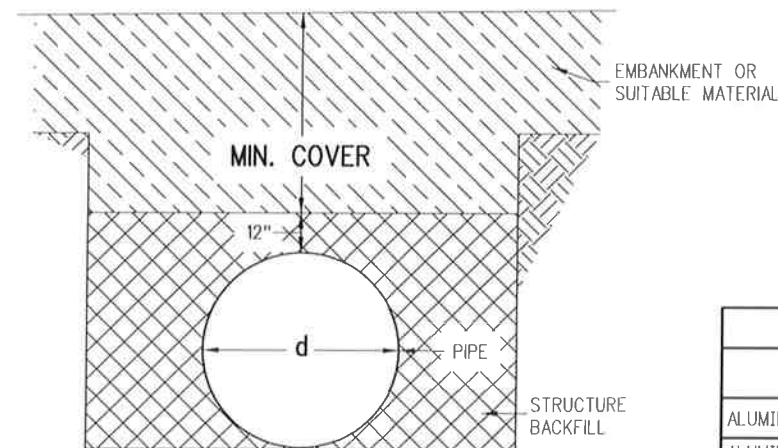

CONSTRUCTION MINIMUM COVER FOR PIPE

GAGE NO.	CONVERSION OF NOMINAL GAGE TO THICKNESS				
	16	14	12	10	8
ALUMINUM THICKNESS - IN.	0.060	0.075	0.105	0.135	0.164
ALUMINIZED OR GALVANIZED STEEL THICKNESS - IN.	0.064	0.079	0.109	0.138	0.168

ALLOWED WALL THICKNESS

Computer File Information	
Creation Date: 07/04/12	Initials: DLM
Last Modification Date: 10/02/14	Initials: LTA
Full Path: www.coloradodot.info/business/designsupport	(R-X)
Drawing File Name: 603010104.dgn	(R-X)
CAD Ver.: MicroStation V8 Scale: Not to Scale Units: English	(R-X)

Sheet Revisions	
Date:	Comments
03/05/14	Deleted "H MIN." dim. Revised Gen Note 2 and 1st note in Legend.
04/29/14	Added applicable coating types notes to all sheets.

Colorado Department of Transportation

4201 East Arkansas Avenue
 CDOT HQ, 4th Floor
 Denver, CO 80222
 Phone: 303-757-9021 FAX: 303-757-9868

Division of Project Support **DLM/LTA**

METAL PIPE

Issued By: Project Development Branch on July 4, 2012

STANDARD PLAN NO.

M-603-1

Sheet No. 1 of 4