

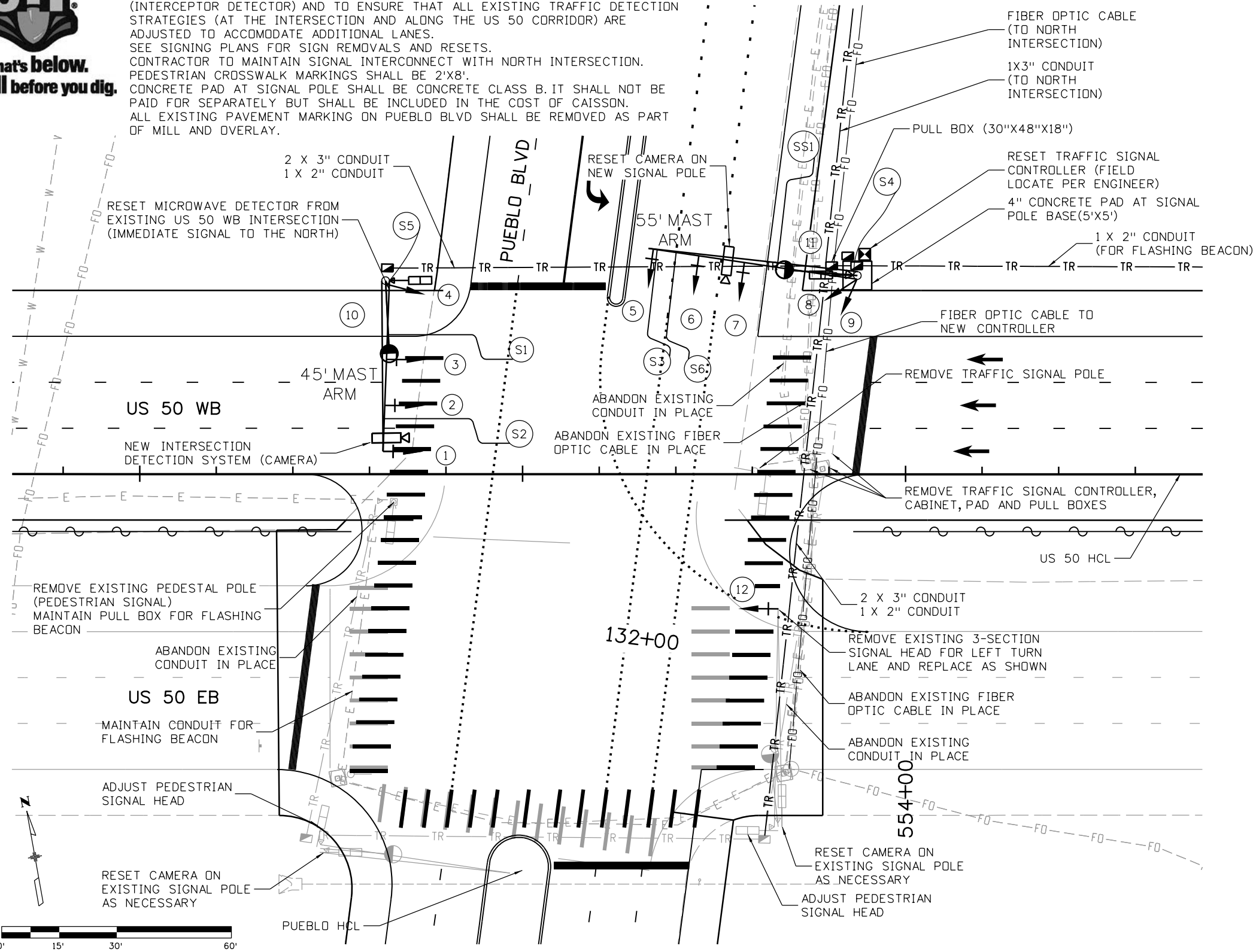

Know what's below.
Call before you dig.

NOTE:
 MAINTAIN EXISTING POWER SOURCE.
 CONTRACTOR TO RESET CAMERA AND MICROWAVE VEHICLE RADAR DETECTORS (INTERCEPTOR DETECTOR) AND TO ENSURE THAT ALL EXISTING TRAFFIC DETECTION STRATEGIES (AT THE INTERSECTION AND ALONG THE US 50 CORRIDOR) ARE ADJUSTED TO ACCOMMODATE ADDITIONAL LANES.
 SEE SIGNING PLANS FOR SIGN REMOVALS AND RESETS.
 CONTRACTOR TO MAINTAIN SIGNAL INTERCONNECT WITH NORTH INTERSECTION.
 PEDESTRIAN CROSSWALK MARKINGS SHALL BE 2'X8'.
 CONCRETE PAD AT SIGNAL POLE SHALL BE CONCRETE CLASS B. IT SHALL NOT BE PAID FOR SEPARATELY BUT SHALL BE INCLUDED IN THE COST OF CAISSON.
 ALL EXISTING PAVEMENT MARKING ON PUEBLO BLVD SHALL BE REMOVED AS PART OF MILL AND OVERLAY.



TRAFFIC SIGNAL HEADS

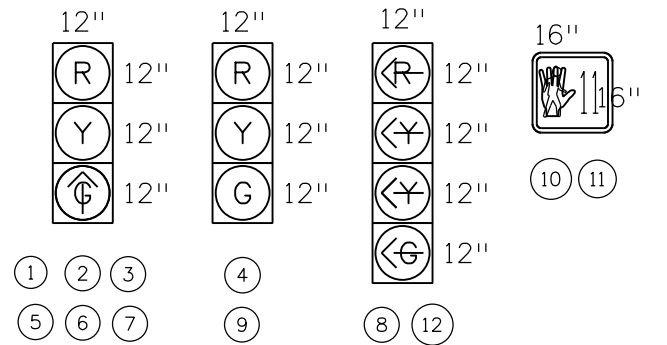

SIGNS

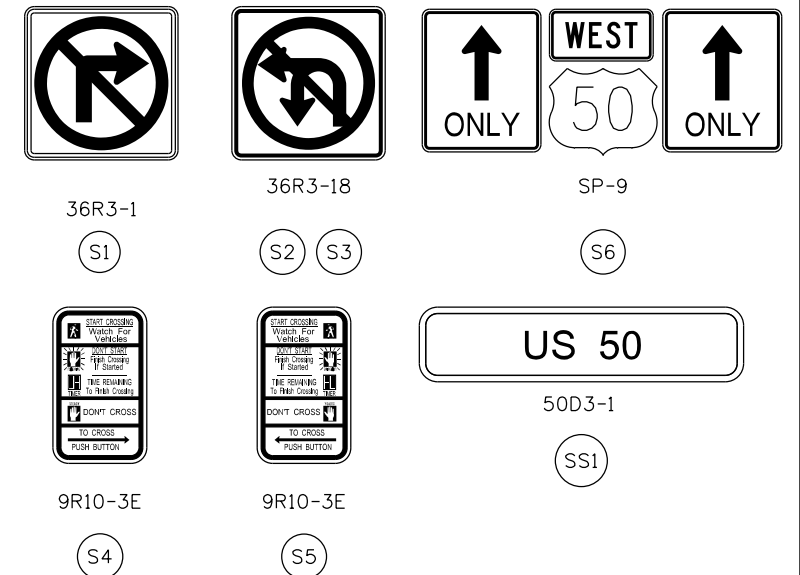

LEGEND

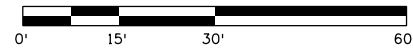
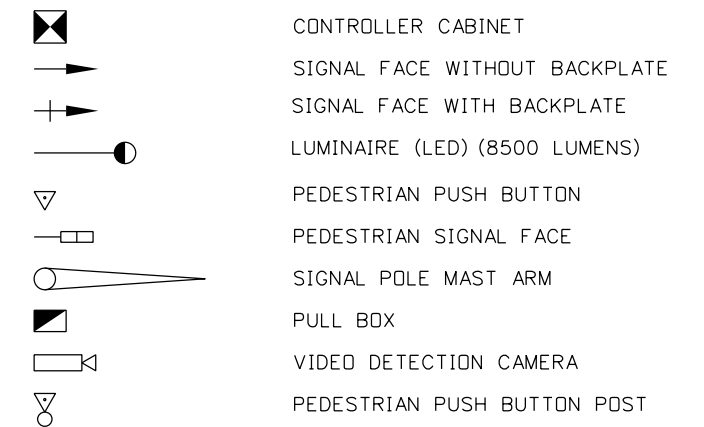

Print Date: 3/2/2017
 File Name: 20344_Signal_01.dgn
 Horiz. Scale: 1:30 Vert. Scale: As Noted

| Sheet Revisions | | |
|-----------------|----------|-------|
| Date: | Comments | Init. |
| | | |
| | | |
| | | |

Colorado Department of Transportation
 902 Erie Avenue
 Pueblo, CO 81001
 Phone: 719-562-5509 FAX: 719-546-5702
 Region 2 DTD

As Constructed
 No Revisions:
 Revised:
 Void:

US 50 WEST WESTBOUND
 TRAFFIC SIGNAL PLAN
 US 50 AND PUEBLO BLVD

Designer: GV
 Detailer: GV
 Subset: SIG

Structure Numbers
 Subset Sheets: 02 of 03

Project No./Code
 STA 0503-085
 20344
 Sheet Number 184

JFS J. F. SATO AND ASSOCIATES
 5898 South Rapp Street
 Littleton, Colorado 80120

erfman 10:56:55 AM c:\projects\wise\pwworking\dl757563\20344_Signal_01.dgn



Know what's below.
Call before you dig.

NOTE:
 MAINTAIN EXISTING POWER SOURCE.
 CONTRACTOR TO RESET CAMERA AND MICROWAVE VEHICLE RADAR DETECTORS AND TO ENSURE THAT ALL EXISTING TRAFFIC DETECTION STRATEGIES (AT THE INTERSECTION AND ALONG THE US 50 CORRIDOR) ARE ADJUSTED TO ACCOMMODATE ADDITIONAL LANES.
 CONTRACTOR TO REWIRE CABINET FOR ADDITIONAL PHASE AND FLASHING YELLOW ARROWS.
 SEE SIGNING PLANS FOR SIGN REMOVALS AND RESETS.
 CONTRACTOR TO MAINTAIN SIGNAL INTERCONNECT WITH SOUTH INTERSECTION.
 CONCRETE PAD AT SIGNAL POLE SHALL BE CONCRETE CLASS B. IT SHALL NOT BE PAID FOR SEPARATELY BUT SHALL BE INCLUDED IN THE COST OF CAISSON.
 ALL EXISTING PAVEMENT MARKING ON PUEBLO BLVD SHALL BE REMOVED AS PART OF MILL AND OVERLAY.

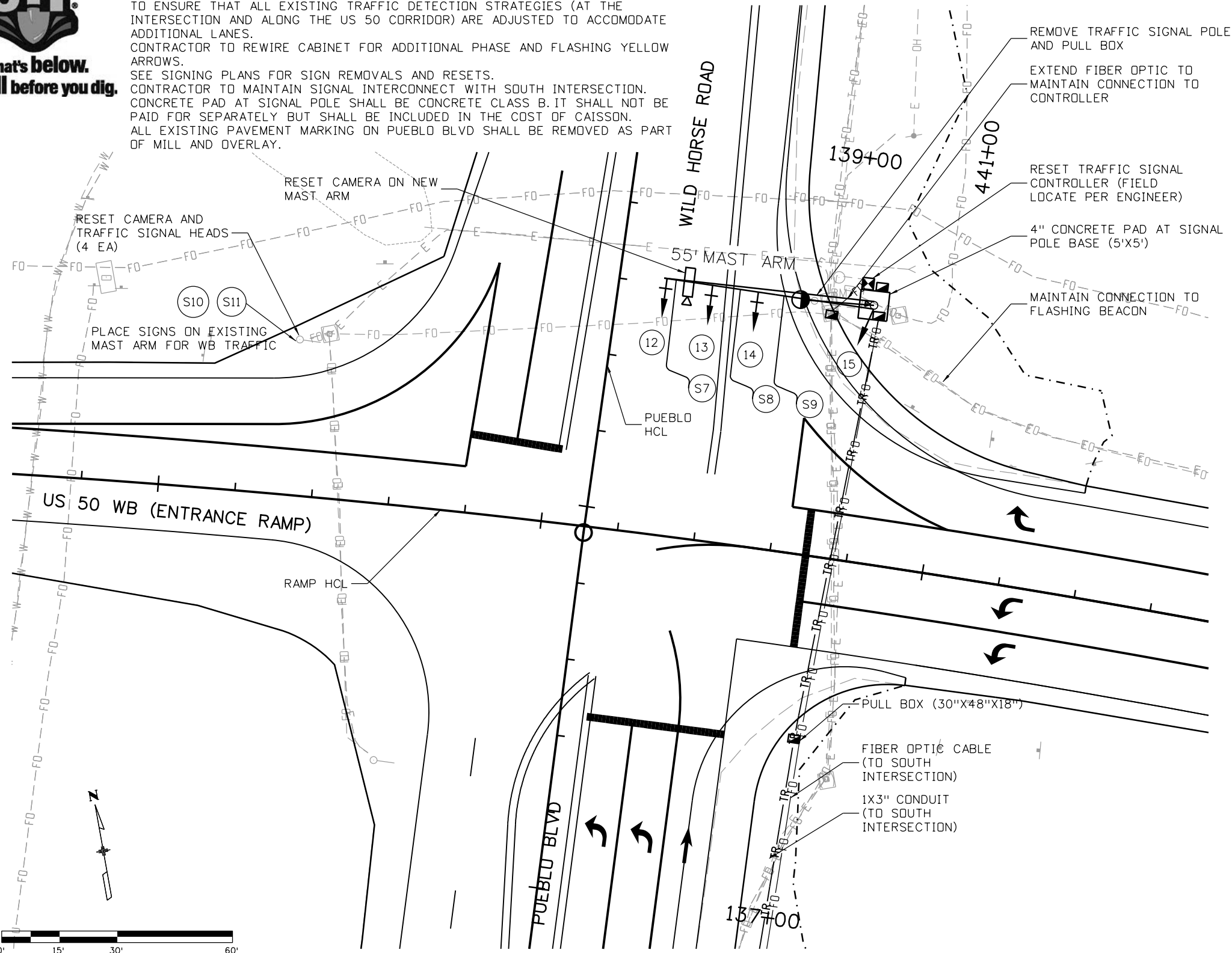

TRAFFIC SIGNAL HEADS

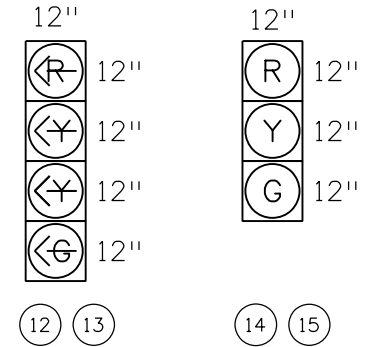

SIGNS

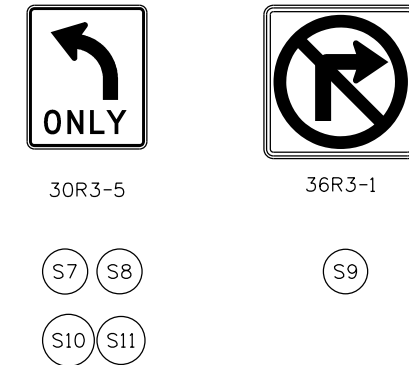

LEGEND

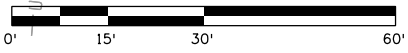
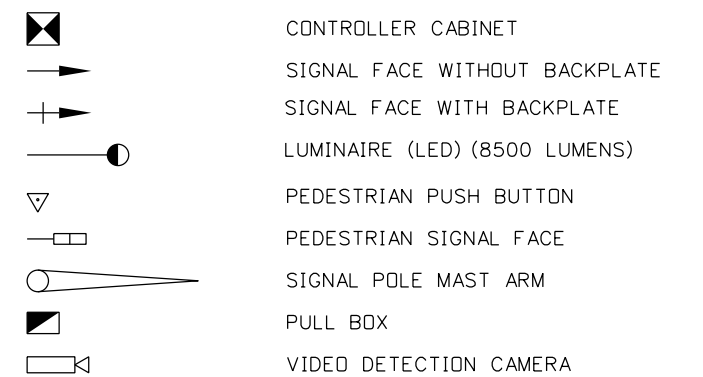

erfman 10:56:59 AM c:\projectwise\pwworking\dl757563\20344_Signal_02.dgn

| | | | | | | | | | |
|--|------------------------|-----------|--------|---|----------------|--|--|------------------|------------------|
| Print Date: 3/2/2017 | Sheet Revisions | | | Colorado Department of Transportation 902 Erie Avenue Pueblo, CO 81001 Phone: 719-562-5509 FAX: 719-546-5702 Region 2 DTD | As Constructed | US 50 WEST WESTBOUND TRAFFIC SIGNAL PLAN | | | Project No./Code |
| File Name: 20344_Signal_02.dgn | Date: | Comments: | Init.: | | No Revisions: | PUEBLO BLVD AND US 50 WB RAMP | | | STA 0503-085 |
| Horiz. Scale: 1:30 Vert. Scale: As Noted | | | | Revised: | Designer: GV | Structure Numbers: | | 20344 | |
| J. F. SATO AND ASSOCIATES 5898 South Rapp Street Littleton, Colorado 80120 | | | | Void: | Detailer: GV | Subset Sheets: 03 of 03 | | Sheet Number 185 | |