

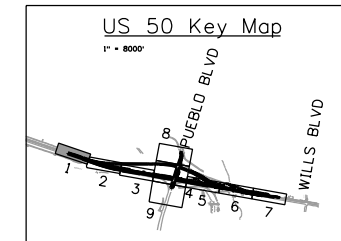

Know what's below.
Call before you dig.

NOTES:

- UTILITY LOCATIONS SHOWN FOR INFORMATION ONLY, AND SHALL BE VERIFIED BY THE CONTRACTOR.
- SEE GENERAL NOTES FOR FURTHER INFORMATION.
- LUMINAIRE SHALL INCLUDE 130W LED TYPE III COBRA HEAD LUMINAIRE, 40' POLE AND NEW CONCRETE FOUNDATION
- SEE SIGNAL PLAN FOR TRAFFIC SIGNAL EQUIPMENT AND DESIGN, INCLUDING SIGNAL POLE LUMINAIRES.



613-01200 613-01300 613-13004 613-34400 613-40010 613-50105 613-50355

TABULATION OF LIGHTING QUANTITIES

D	SUBSET SHEET NO.	STATION (US 50 RAMP) *	SIDE	OFFSET *	2 Inch Electrical Conduit (Plastic)	3 Inch Electrical Conduit (Plastic)	Luminaire (Special) (LED) (130 Watt)	Light Standard Metal (40 Ft)	Light Standard Foundation	Lighting Control Center (Pedestal Only)	Power Transformer	COMMENT
					LF	LF	EACH	EACH	EACH	EACH	EACH	
PT 01	08	440+81.24	LT	112							1	New transformer on utility pole. Contractor to contact Black Hills Energy for exact size and location.
	04-06_08	440+91.06 TO 461+38.19	LT & RT		2,030	65						Conduits for power to Light Standards.
LCC 01	08	440+84.25	LT	91.26						1		Lighting Control Center placed near Pueblo Blvd.
LS 01	05	456+14.07	RT	46.30			1	1	1			Light Std. in exit gore & placed 200' from LS03 along US 50 EOP.
LS 02	05	456+40.00	LT	31.53			1	1	1			Light Std. 12' from ramp EOP & placed 150' from LS03 along Ramp EOP.
LS 03	05	458+02.90	LT	25.01			1	1	1			Light Std. 12' from ramp EOP & placed 25' east of physical gore.
LS 04	06	460+03.88	LT	16.05			1	1	1			Light Std. minimum 3' behind guardrail & placed 200' east of LS03.
LS 05	06	462+03.47	LT	25.59			1	1	1			Light Std. minimum 3' behind guardrail & placed 200' east of LS04.
TOTALS					2,030	65	5	5	5	1	1	

* Station and offset are approximate; Contractor to determine exact location in the field with Engineer.
Note: All unshielded light standards shall have break-away type transformer base.

LEGEND

- OVERHEAD ELECTRIC POLE
- TR- PROPOSED TRAFFIC CONDUIT
- FO- PROPOSED FIBER OPTIC
- E- PROPOSED LIGHTING CONDUIT
- PROPOSED PIPE
- POTHOLE LOCATION
- SPLICE BOX
- NEW ROADWAY LIGHT STANDARD

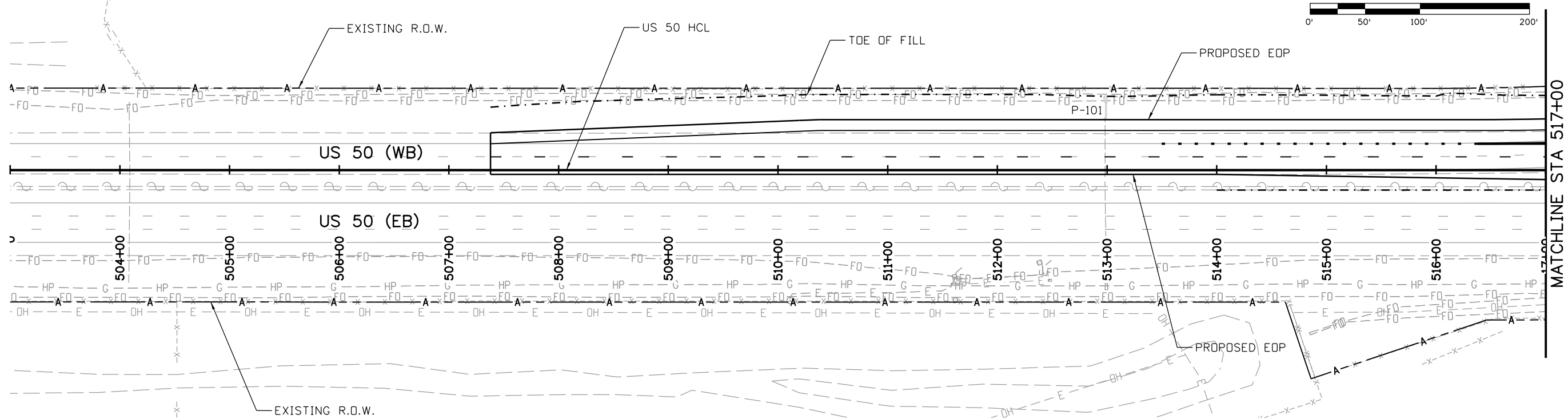

Print Date: 3/2/2017

File Name: 20344-Utility_01.dgn

Horiz. Scale: 1:100 Vert. Scale:

JFS & A
J. F. SATO AND ASSOCIATES
5898 South Rapp Street
Littleton, Colorado 80120



Sheet Revisions

Date:	Comments	Init.

Colorado Department of Transportation



902 Erie Avenue
Pueblo, CO 81001
Phone: 719-562-5509 FAX: 719-546-5702

Region 2

DTD

As Constructed

No Revisions:

Revised:

Void:

US 50 WEST WESTBOUND
UTILITY PLAN
US 50

Designer:	AB	Structure Numbers	
Detailer:	AB		
Subset:	UT	Subset Sheets: 01 of 09	

Project No./Code

STA 0503-085

Sheet Number 26



Know what's below.
Call before you dig.

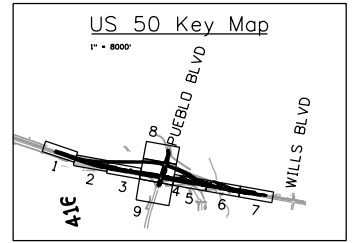
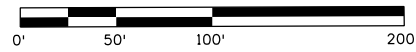

TELEPHONE (CENTURY LINK)
N = 602072.71
E = 238842.43
STA 411+67.02, Lt. 39.30'

FIBER OPTIC (SECOM)
44" TOP
N = 602078.53
E = 238825.96
STA 411+50.27, Lt. 45.02'

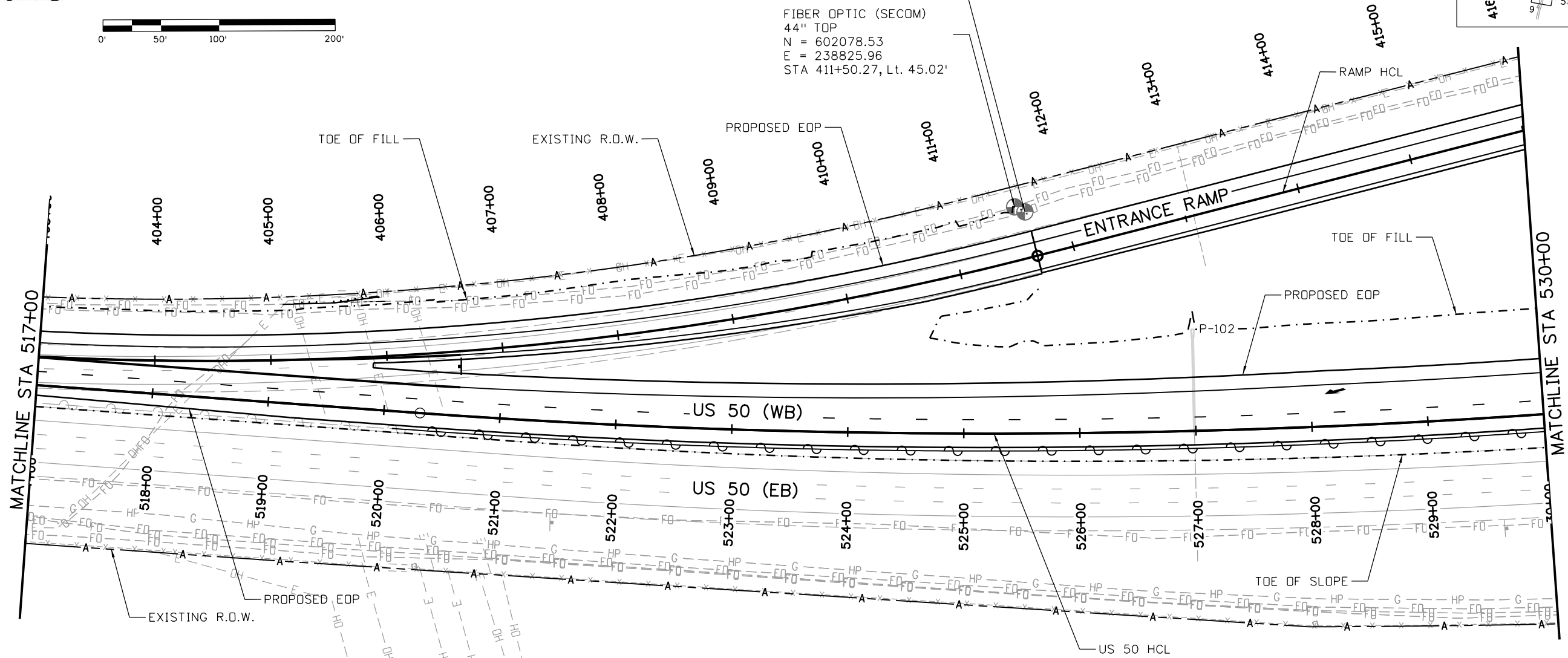

NOTES:

- UTILITY LOCATIONS SHOWN FOR INFORMATION ONLY, AND SHALL BE VERIFIED BY THE CONTRACTOR.
- SEE GENERAL NOTES FOR FURTHER INFORMATION.
- LUMINAIRE SHALL INCLUDE 130W LED TYPE III COBRA HEAD LUMINAIRE, 40' POLE AND NEW CONCRETE FOUNDATION
- SEE SIGNAL PLAN FOR TRAFFIC SIGNAL EQUIPMENT AND DESIGN, INCLUDING SIGNAL POLE LUMINAIRES.

LEGEND	
	OVERHEAD ELECTRIC POLE
	PROPOSED TRAFFIC CONDUIT
	PROPOSED FIBER OPTIC
	PROPOSED LIGHTING CONDUIT
	PROPOSED PIPE
	POTHOLE LOCATION
	SPLICE BOX
	NEW ROADWAY LIGHT STANDARD

Print Date: 3/2/2017
File Name: 20344-Utility_02.dgn
Horiz. Scale: 1:100 Vert. Scale:

J. F. SATO AND ASSOCIATES
5898 South Rapp Street
Littleton, Colorado 80120

Sheet Revisions		
Date:	Comments	Init.

Colorado Department of Transportation

902 Erie Avenue
Pueblo, CO 81001
Phone: 719-562-5509 FAX: 719-546-5702

Region 2 DTD

As Constructed	No Revisions:
Revised:	
Void:	

US 50 WEST WESTBOUND UTILITY PLAN US 50			
Designer:	AB	Structure	
Detailer:	AB	Numbers	
Subset:	UT	Subset Sheets:	02 of 09

Project No./Code	STA 0503-085
	20344
Sheet Number	27



Know what's below.
Call before you dig.

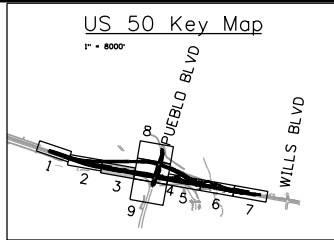

- NOTES:
1. UTILITY LOCATIONS SHOWN FOR INFORMATION ONLY, AND SHALL BE VERIFIED BY THE CONTRACTOR.
 2. SEE GENERAL NOTES FOR FURTHER INFORMATION.
 3. LUMINAIRE SHALL INCLUDE 130W LED TYPE III COBRA HEAD LUMINAIRE, 40' POLE AND NEW CONCRETE FOUNDATION
 4. SEE SIGNAL PLAN FOR TRAFFIC SIGNAL EQUIPMENT AND DESIGN, INCLUDING SIGNAL POLE LUMINAIRES.

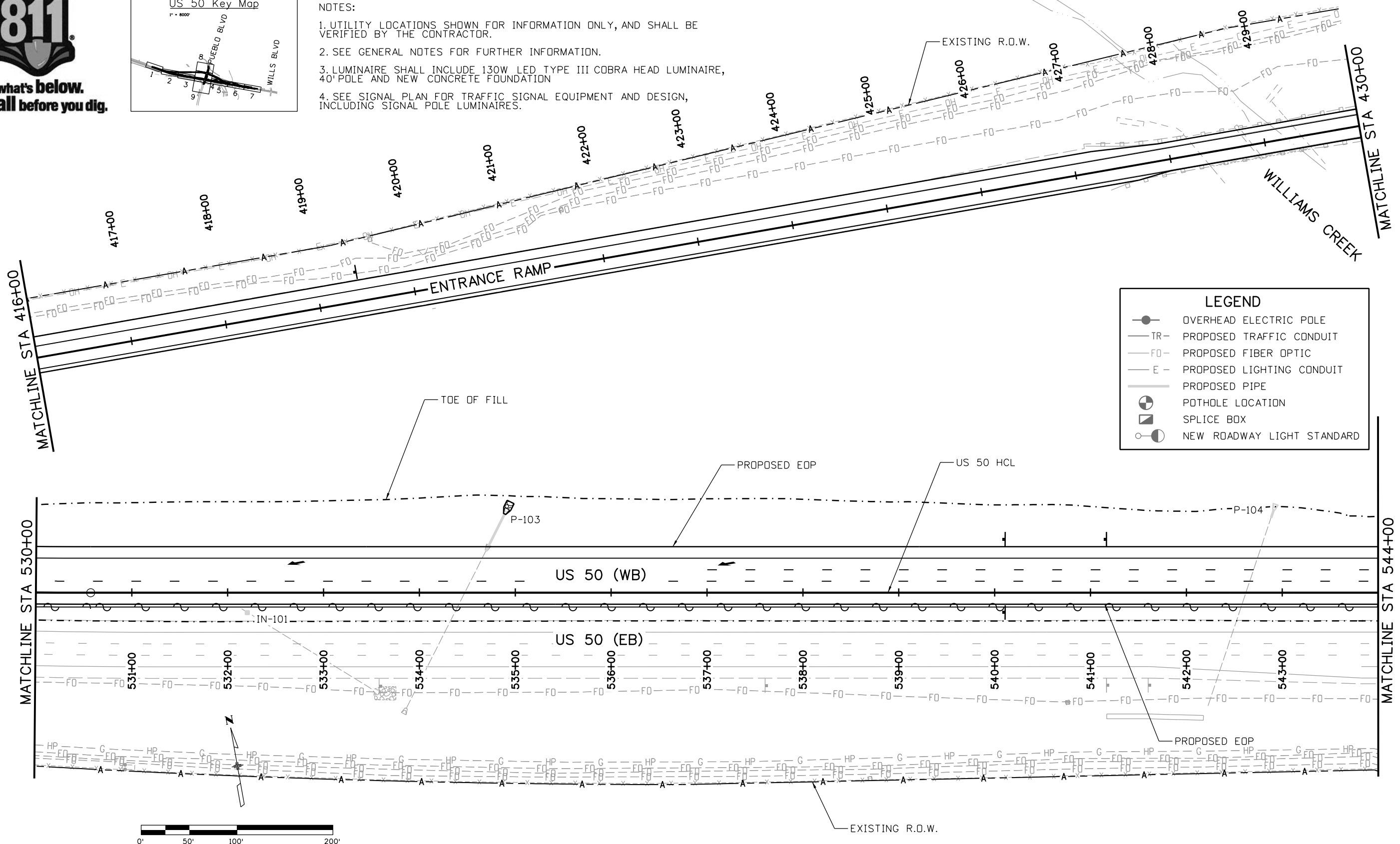

LEGEND	
	OVERHEAD ELECTRIC POLE
	PROPOSED TRAFFIC CONDUIT
	PROPOSED FIBER OPTIC
	PROPOSED LIGHTING CONDUIT
	PROPOSED PIPE
	POTHOLE LOCATION
	SPLICE BOX
	NEW ROADWAY LIGHT STANDARD

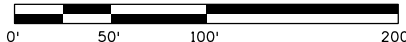

Print Date: 3/2/2017
 File Name: 20344-Utility_03.dgn
 Horiz. Scale: 1:100 Vert. Scale:
JFS & A
 J. F. SATO AND ASSOCIATES
 5898 South Rapp Street
 Littleton, Colorado 80120

Sheet Revisions		
Date:	Comments	Init.

Colorado Department of Transportation

 902 Erie Avenue
 Pueblo, CO 81001
 Phone: 719-562-5509 FAX: 719-546-5702
 Region 2 DTD

As Constructed
No Revisions:
Revised:
Void:

US 50 WEST WESTBOUND
 UTILITY PLAN
 US 50

Designer:	AB	Structure	
Detailer:	AB	Numbers	
Subset:	UT	Subset Sheets:	03 of 09

Project No./Code	STA 0503-085
	20344
Sheet Number	28

erfman 10:48:01 AM c:\projectwise\pwz_working\dl756025\20344-Utility_03.dgn

LEGEND

- OVERHEAD ELECTRIC POLE
- TR— PROPOSED TRAFFIC CONDUIT
- FO- PROPOSED FIBER OPTIC
- E- PROPOSED LIGHTING CONDUIT
- PROPOSED PIPE
- ⊙ POT HOLE LOCATION
- ⊠ SPLICE BOX
- NEW ROADWAY LIGHT STANDARD

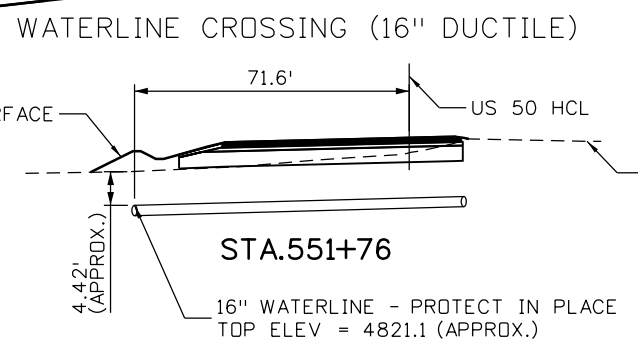

TELEPHONE (CENTURY LINK)
 46" TOP
 N = 601474.74
 E = 241398.01
 STA 551+88.93, Lt. 68.44'

WATERLINE (CITY OF PUEBLO)
 53" TOP
 N = 601480.07
 E = 241385.99
 STA 551+76.16, Lt. 71.58'
 (SEE CROSS-SECTION)

WILLIAMS CREEK

FIBER OPTIC (CDOT)
 N = 601433.68
 E = 241580.73
 STA 553+76.01, Lt. 60.06'

- NOTES:**
- UTILITY LOCATIONS SHOWN FOR INFORMATION ONLY, AND SHALL BE VERIFIED BY THE CONTRACTOR.
 - SEE GENERAL NOTES FOR FURTHER INFORMATION.
 - LUMINAIRE SHALL INCLUDE 130W LED TYPE III COBRA HEAD LUMINAIRE, 40' POLE AND NEW CONCRETE FOUNDATION
 - SEE SIGNAL PLAN FOR TRAFFIC SIGNAL EQUIPMENT AND DESIGN, INCLUDING SIGNAL POLE LUMINAIRES.

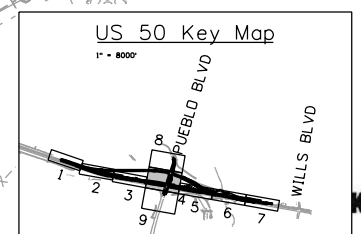
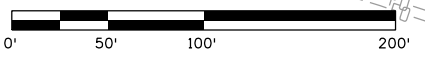

Print Date: 3/2/2017	Sheet Revisions			Colorado Department of Transportation	As Constructed	US 50 WEST WESTBOUND UTILITY PLAN		Project No./Code
File Name: 20344-Utility_04.dgn	Date:	Comments	Init.	 902 Erie Avenue Pueblo, CO 81001 Phone: 719-562-5509, FAX: 719-546-5702	No Revisions:	US 50		STA 0503-085
Horiz. Scale: 1:100 Vert. Scale:					Revised:	Designer: AB	Structure	20344
 J. F. SATO AND ASSOCIATES 5898 South Rapp Street Littleton, Colorado 80120					Void:	Detailer: AB	Numbers	
				Region 2	DTD	Subset: UT	Subset Sheets: 04 of 09	Sheet Number 29

erfman 10:48:05 AM c:\projectwise\pwz_working\1756025\20344-Utility_04.dgn

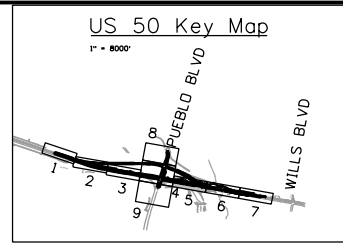

Know what's below.
Call before you dig.

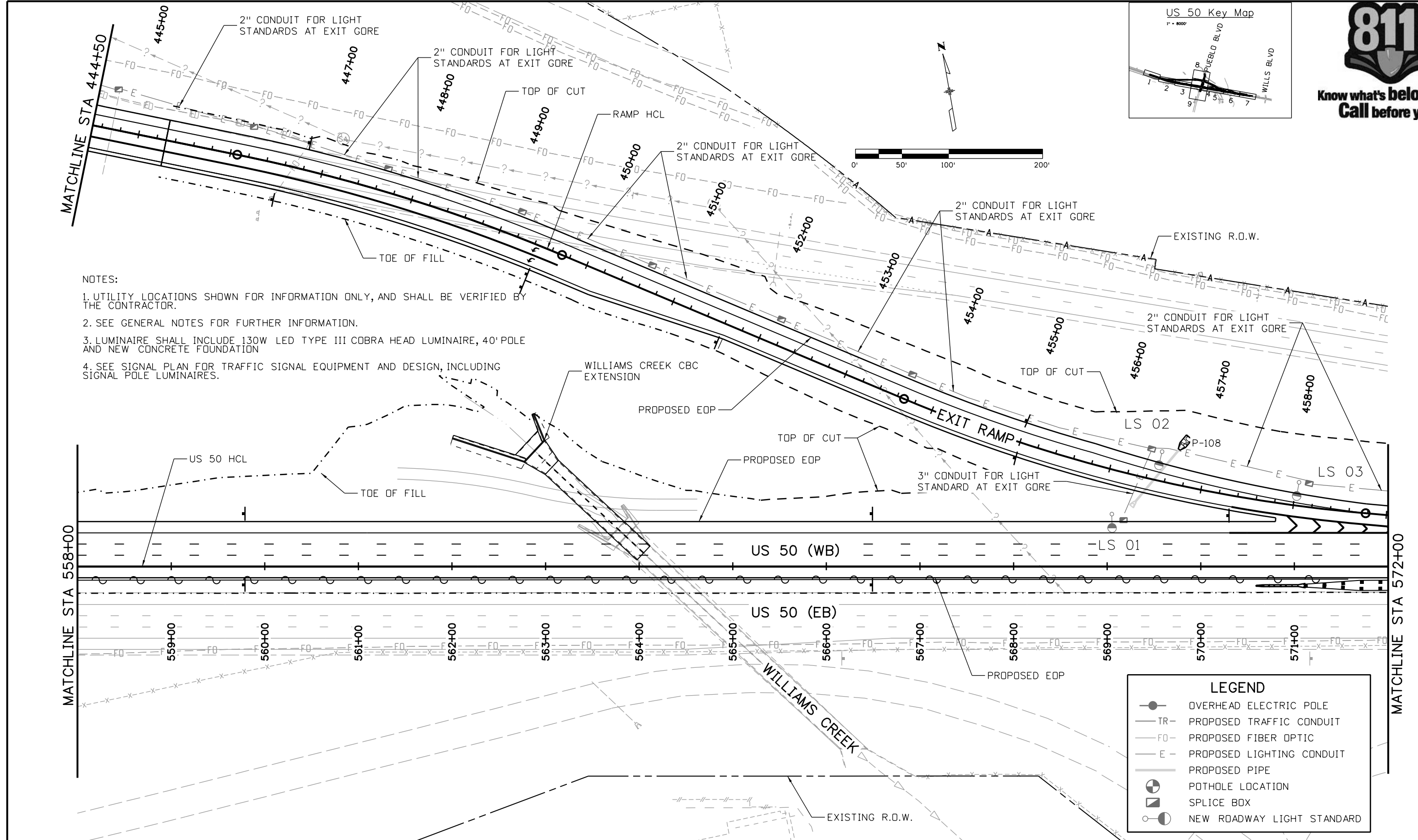

- NOTES:
- UTILITY LOCATIONS SHOWN FOR INFORMATION ONLY, AND SHALL BE VERIFIED BY THE CONTRACTOR.
 - SEE GENERAL NOTES FOR FURTHER INFORMATION.
 - LUMINAIRE SHALL INCLUDE 130W LED TYPE III COBRA HEAD LUMINAIRE, 40' POLE AND NEW CONCRETE FOUNDATION
 - SEE SIGNAL PLAN FOR TRAFFIC SIGNAL EQUIPMENT AND DESIGN, INCLUDING SIGNAL POLE LUMINAIRES.

LEGEND	
	OVERHEAD ELECTRIC POLE
	PROPOSED TRAFFIC CONDUIT
	PROPOSED FIBER OPTIC
	PROPOSED LIGHTING CONDUIT
	PROPOSED PIPE
	POTHOLE LOCATION
	SPLICE BOX
	NEW ROADWAY LIGHT STANDARD

Print Date: 3/2/2017	<table border="1"> <thead> <tr> <th colspan="3">Sheet Revisions</th> </tr> <tr> <th>Date:</th> <th>Comments</th> <th>Init.</th> </tr> </thead> <tbody> <tr> <td> </td> <td> </td> <td> </td> </tr> <tr> <td> </td> <td> </td> <td> </td> </tr> </tbody> </table>	Sheet Revisions			Date:	Comments	Init.							Colorado Department of Transportation 902 Erie Avenue Pueblo, CO 81001 Phone: 719-562-5509 FAX: 719-546-5702 Region 2	As Constructed	US 50 WEST WESTBOUND UTILITY PLAN US 50	Project No./Code
Sheet Revisions																	
Date:	Comments	Init.															
File Name: 20344-Utility_05.dgn			No Revisions:		STA 0503-085												
Horiz. Scale: 1:100 Vert. Scale:				Revised:	Designer: AB	Structure Numbers											
J. F. SATO AND ASSOCIATES 5898 South Rapp Street Littleton, Colorado 80120		Region 2	DTD	Void:	Detailer: AB												
					Subset: UT	Subset Sheets: 05 of 09	Sheet Number	30									

erfman 10:48:09 AM c:\projects\wise\pzw_working\dl756025\20344-Utility_05.dgn



Know what's below.
Call before you dig.

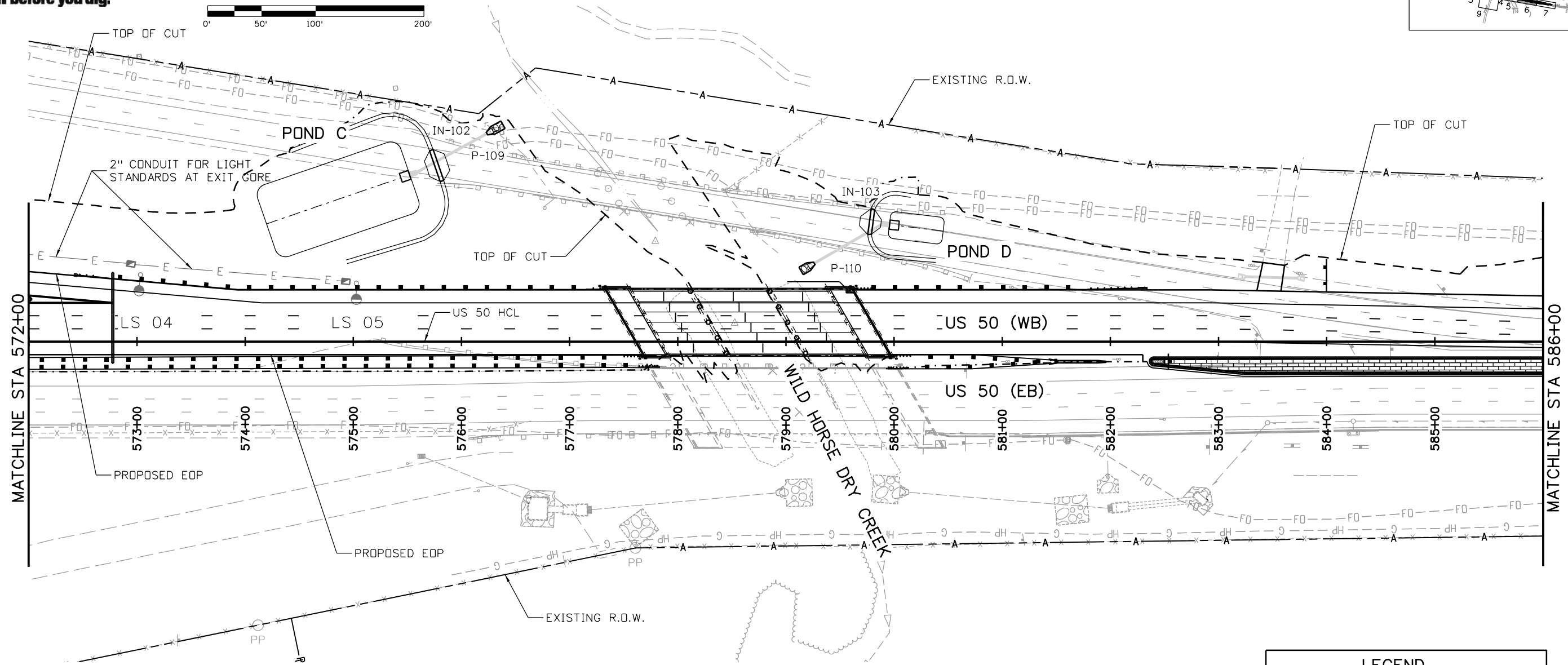
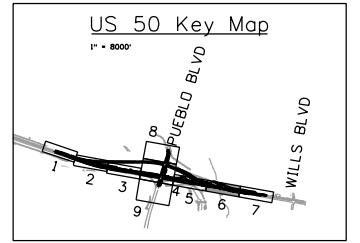
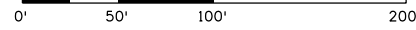

NOTES:

1. UTILITY LOCATIONS SHOWN FOR INFORMATION ONLY, AND SHALL BE VERIFIED BY THE CONTRACTOR.
2. SEE GENERAL NOTES FOR FURTHER INFORMATION.
3. LUMINAIRE SHALL INCLUDE 130W LED TYPE III COBRA HEAD LUMINAIRE, 40' POLE AND NEW CONCRETE FOUNDATION
4. SEE SIGNAL PLAN FOR TRAFFIC SIGNAL EQUIPMENT AND DESIGN, INCLUDING SIGNAL POLE LUMINAIRES.

LEGEND	
	OVERHEAD ELECTRIC POLE
	PROPOSED TRAFFIC CONDUIT
	PROPOSED FIBER OPTIC
	PROPOSED LIGHTING CONDUIT
	PROPOSED PIPE
	POTHOLE LOCATION
	SPLICE BOX
	NEW ROADWAY LIGHT STANDARD

Print Date: 3/2/2017
 File Name: 20344-Utility_06.dgn
 Horiz. Scale: 1:100 Vert. Scale:

JFS
 J. F. SATO AND ASSOCIATES
 5898 South Rapp Street
 Littleton, Colorado 80120

Sheet Revisions		
Date:	Comments	Init.

Colorado Department of Transportation

CDOT
 902 Erie Avenue
 Pueblo, CO 81001
 Phone: 719-562-5509 FAX: 719-546-5702

Region 2 DTD

As Constructed
No Revisions:
Revised:
Void:

US 50 WEST WESTBOUND UTILITY PLAN US 50			
Designer:	AB	Structure	
Detailer:	AB	Numbers	
Subset:	UT	Subset Sheets:	06 of 09

Project No./Code
STA 0503-085
20344
Sheet Number 31



Know what's below.
Call before you dig.

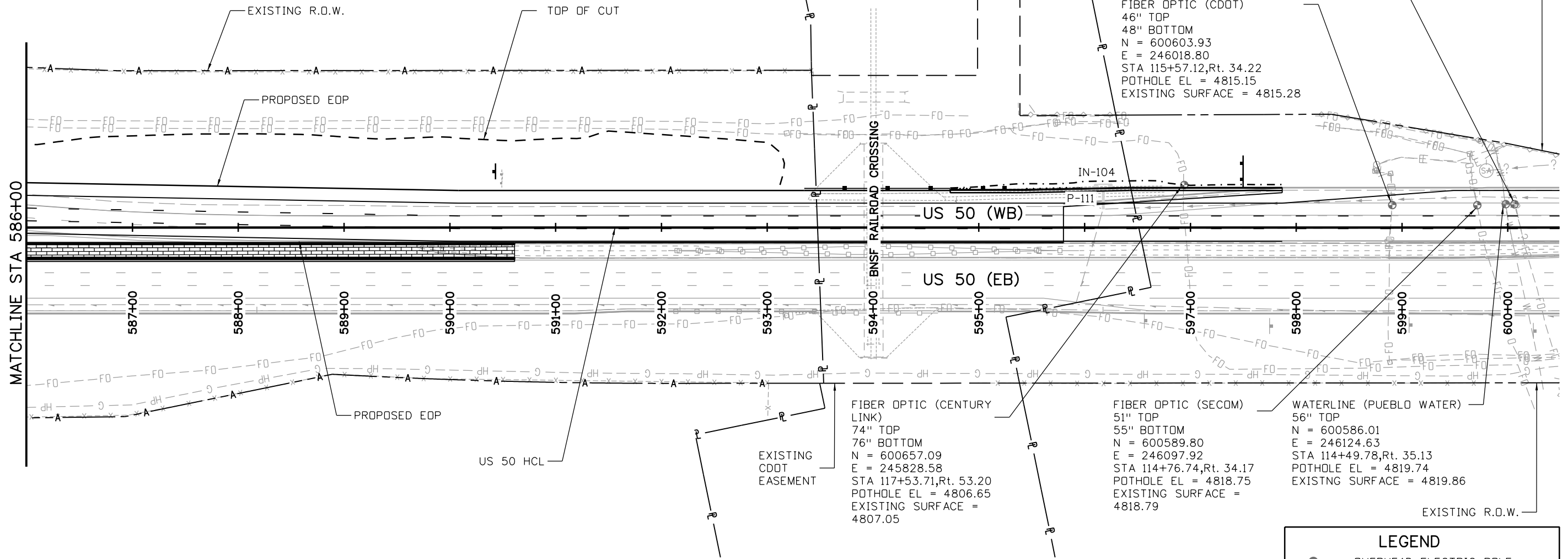
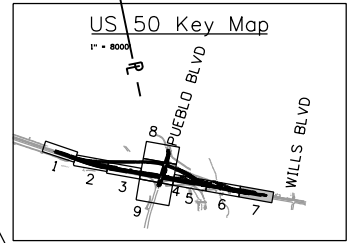
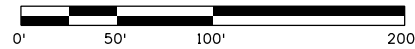

NOTES:

- UTILITY LOCATIONS SHOWN FOR INFORMATION ONLY, AND SHALL BE VERIFIED BY THE CONTRACTOR.
- SEE GENERAL NOTES FOR FURTHER INFORMATION.
- LUMINAIRE SHALL INCLUDE 130W LED TYPE III COBRA HEAD LUMINAIRE, 40' POLE AND NEW CONCRETE FOUNDATION
- SEE SIGNAL PLAN FOR TRAFFIC SIGNAL EQUIPMENT AND DESIGN, INCLUDING SIGNAL POLE LUMINAIRES.

LEGEND	
	OVERHEAD ELECTRIC POLE
	TR- PROPOSED TRAFFIC CONDUIT
	FO- PROPOSED FIBER OPTIC
	E - PROPOSED LIGHTING CONDUIT
	PROPOSED PIPE
	POTHOLE LOCATION
	SPLICE BOX
	NEW ROADWAY LIGHT STANDARD

Print Date: 3/2/2017
 File Name: 20344-Utility_07.dgn
 Horiz. Scale: 1:100 Vert. Scale:
JFS J. F. SATO AND ASSOCIATES
 5898 South Rapp Street
 Littleton, Colorado 80120

Sheet Revisions		
Date:	Comments	Init.

Colorado Department of Transportation
 902 Erie Avenue
 Pueblo, CO 81001
 Phone: 719-562-5509 FAX: 719-546-5702
Region 2 DTD

As Constructed
No Revisions:
Revised:
Void:

US 50 WEST WESTBOUND UTILITY PLAN US 50		
Designer:	AB	Structure Numbers
Detailer:	AB	
Subset:	UT	Subset Sheets: 07 of 09

Project No./Code
STA 0503-085
Sheet Number 32

erfman 10:48:16 AM c:\projectwise\pwworking\dl756025\20344-Utility_07.dgn



Know what's below.
Call before you dig.

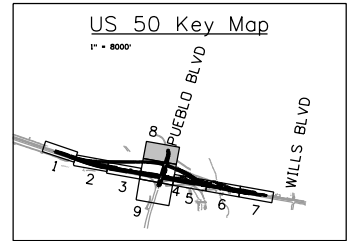

LEGEND	
	OVERHEAD ELECTRIC POLE
	PROPOSED TRAFFIC CONDUIT
	PROPOSED FIBER OPTIC
	PROPOSED LIGHTING CONDUIT
	PROPOSED PIPE
	POTHOLE LOCATION
	SPLICE BOX
	NEW ROADWAY LIGHT STANDARD

NOTES:

- UTILITY LOCATIONS SHOWN FOR INFORMATION ONLY, AND SHALL BE VERIFIED BY THE CONTRACTOR.
- SEE GENERAL NOTES FOR FURTHER INFORMATION.
- LUMINAIRE SHALL INCLUDE 130W LED TYPE III COBRA HEAD LUMINAIRE, 40' POLE AND NEW CONCRETE FOUNDATION
- SEE SIGNAL PLAN FOR TRAFFIC SIGNAL EQUIPMENT AND DESIGN, INCLUDING SIGNAL POLE LUMINAIRES.

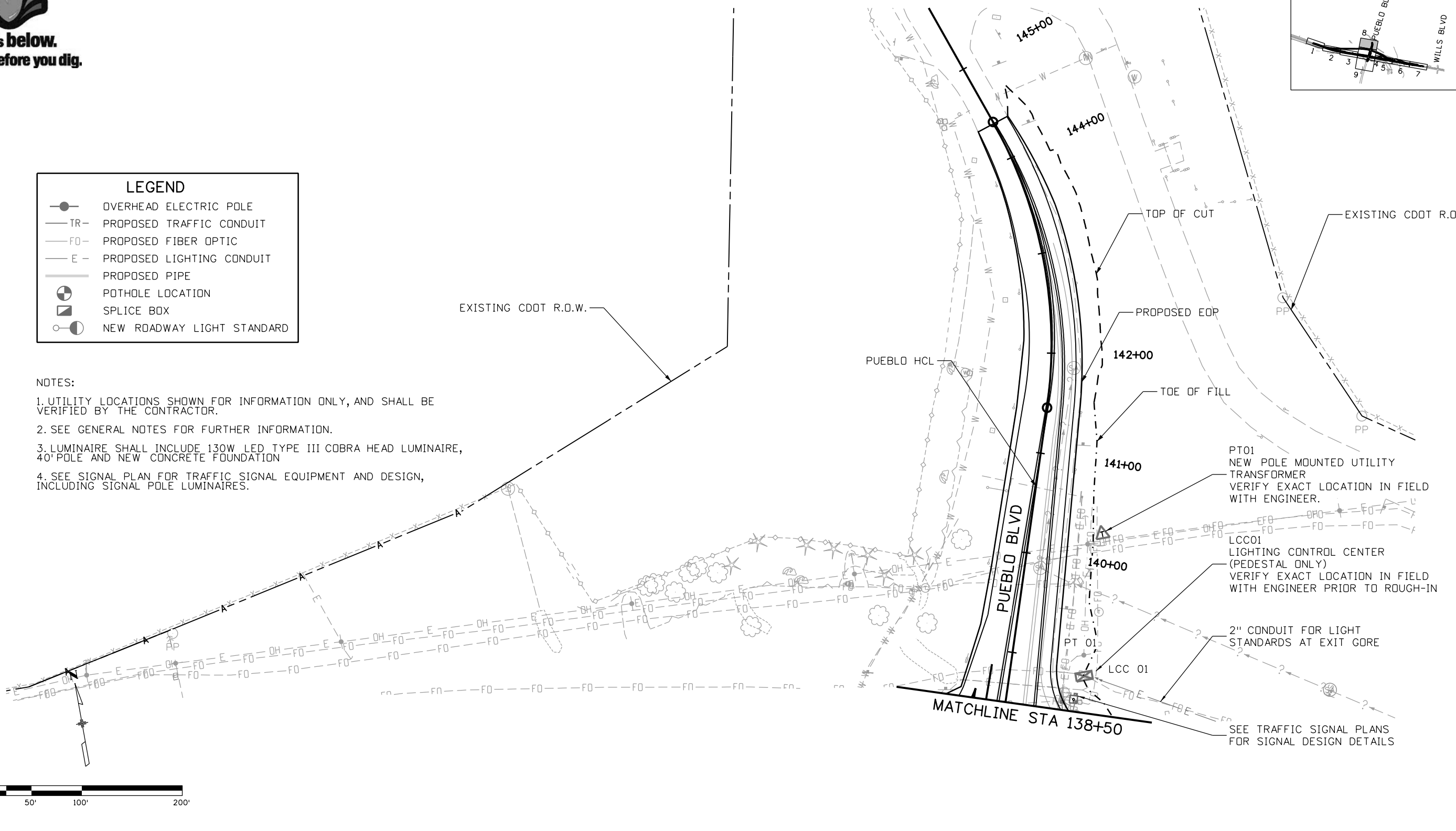
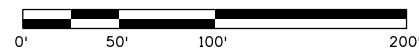

Print Date: 3/2/2017
 File Name: 20344-Utility_08.dgn
 Horiz. Scale: 1:100 Vert. Scale:
JFS J. F. SATO AND ASSOCIATES
 5898 South Rapp Street
 Littleton, Colorado 80120

Sheet Revisions		
Date:	Comments	Init.

Colorado Department of Transportation
 902 Erie Avenue
 Pueblo, CO 81001
 Phone: 719-562-5509 FAX: 719-546-5702
Region 2 DTD

As Constructed
No Revisions:
Revised:
Void:

US 50 WEST WESTBOUND UTILITY PLAN PUEBLO BLVD			
Designer:	AB	Structure	
Detailer:	AB	Numbers	
Subset:	UT	Subset Sheets:	08 of 09

Project No./Code
STA 0503-085
20344
Sheet Number 33

erfman 10:48:20 AM c:\projectwise\pwworking\dl756025\20344-Utility_08.dgn



Know what's below.
Call before you dig.

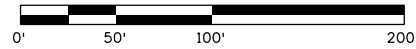

LEGEND	
	OVERHEAD ELECTRIC POLE
	PROPOSED TRAFFIC CONDUIT
	PROPOSED FIBER OPTIC
	PROPOSED LIGHTING CONDUIT
	PROPOSED PIPE
	POTHOLE LOCATION
	SPLICE BOX
	NEW ROADWAY LIGHT STANDARD

NOTES:

- UTILITY LOCATIONS SHOWN FOR INFORMATION ONLY, AND SHALL BE VERIFIED BY THE CONTRACTOR.
- SEE GENERAL NOTES FOR FURTHER INFORMATION.
- LUMINAIRE SHALL INCLUDE 130W LED TYPE II COBRA HEAD LUMINAIRE, 40' POLE AND NEW CONCRETE FOUNDATION
- SEE SIGNAL PLAN FOR TRAFFIC SIGNAL EQUIPMENT AND DESIGN, INCLUDING SIGNAL POLE LUMINAIRES.

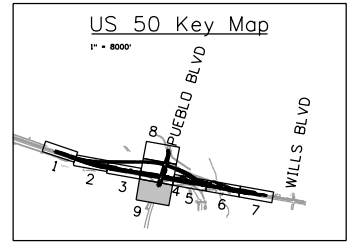
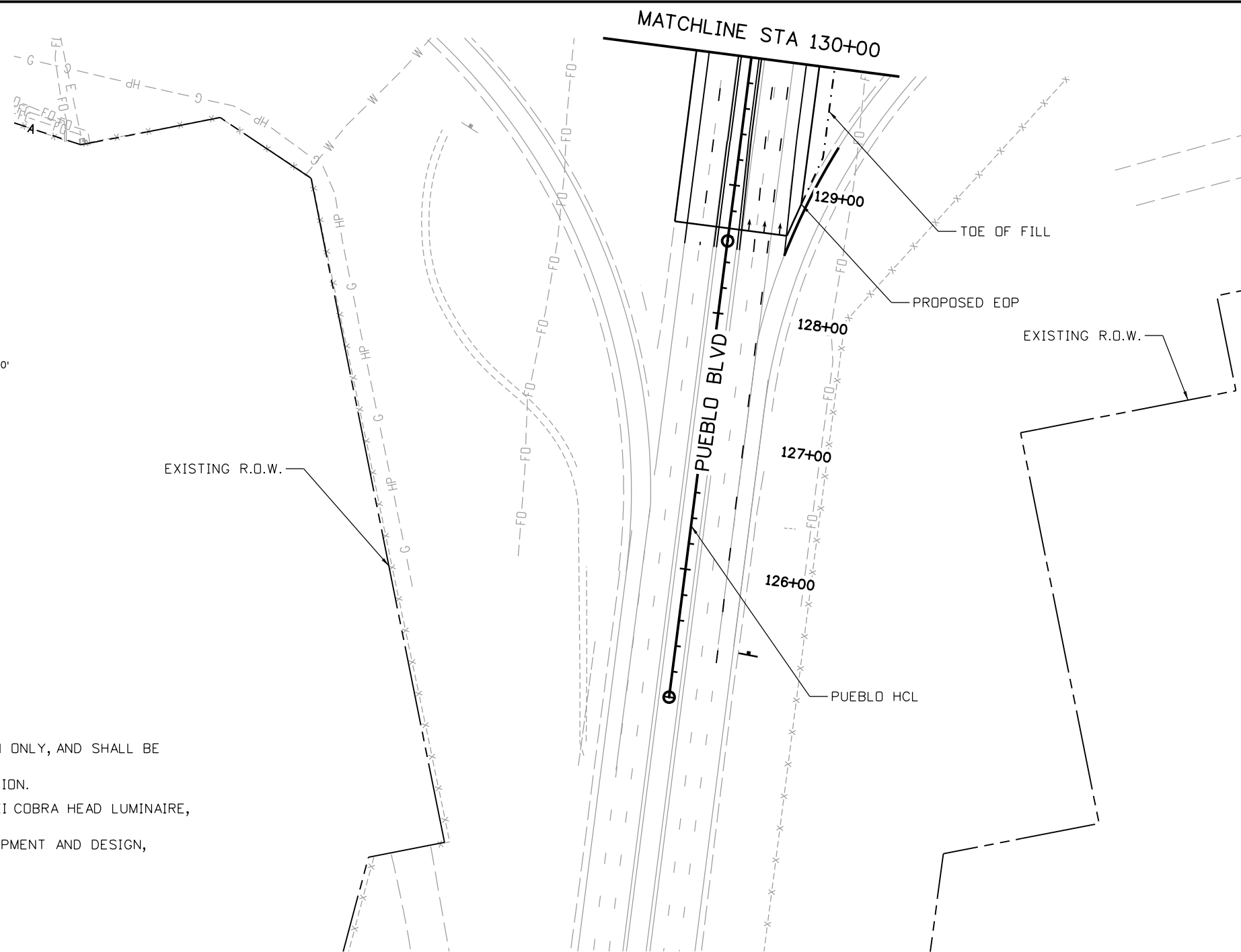

Print Date: 3/2/2017
 File Name: 20344-Utility_09.dgn
 Horiz. Scale: 1:100 Vert. Scale:
JFS J. F. SATO AND ASSOCIATES
 5898 South Rapp Street
 Littleton, Colorado 80120

Sheet Revisions		
Date:	Comments	Init.

Colorado Department of Transportation
 902 Erie Avenue
 Pueblo, CO 81001
 Phone: 719-562-5509 FAX: 719-546-5702
Region 2 DTD

As Constructed
No Revisions:
Revised:
Void:

US 50 WEST WESTBOUND UTILITY PLAN PUEBLO BLVD			
Designer:	AB	Structure	
Detailer:	AB	Numbers	
Subset:	UT	Subset Sheets:	09 of 09

Project No./Code
STA 0503-085
20344
Sheet Number 34