

Oversight / NHS

FHWA REGION VIII OVERSIGHT? NO YES

NATIONAL HIGHWAY SYSTEM? NO YES

DEPARTMENT OF TRANSPORTATION STATE OF COLORADO

Related Projects:

P. E. UNDER PROJECT: STA 0503-088
Project Number: 20448
Project Code:

R.O.W. Projects:

R.O.W. Project Description
F001-3(14), F050-3(3) & F050-3(5)Sec2

HIGHWAY CONSTRUCTION BID PLANS OF PROPOSED FEDERAL AID PROJECT NO. STA 0503-085 US 50 PUEBLO COUNTY CONSTRUCTION PROJECT CODE NO. 20344

TABULATION OF LENGTH & DESIGN DATA

STATION	FEET	
	ROADWAY US 50	MAJOR STR.
BEGIN APPROACH TO PROJECT STA 0503-085 ON US 50 = M.P. 310.0	6,336.00	
BEGIN WIDENING STA. 507+37.86 = MP 311.2*		
END WIDENING AND BEGIN NEW CONSTRUCTION STA. 516+37.86 = MP 311.4*	900.00	
	4,540.88	
BEGIN STRUCTURE K-18-CZ STA. 561+78.66 = MP 312.26*		211.00
END STRUCTURE K-18-CZ STA. 563+89.66 = MP 312.30*	1,392.20	
BEGIN STRUCTURE K-18-DA STA. 577+81.86 = MP 312.50*		186.96
END STRUCTURE K-18-DA STA. 579+68.82 = MP 312.54*	1,092.34	
END NEW CONSTRUCTION AND BEGIN WIDENING & RECONSTRUCTION STA. 590+61.16 = MP 312.75*	328.84	
BEGIN STRUCTURE K-18-BL STA. 593+90.00 = MP 312.86*		20.00
END STRUCTURE K-18-BL STA. 594+10.00 = MP 312.86*	376.85	
END WIDENING & RECONSTRUCTION STA. 597+86.85 = MP 312.9*	3,168.00	
BEGIN APPROACH TO PROJECT STA 0503-085 ON US 50 = M.P. 313.5		
TOTAL	18,135.11	417.96
SUMMARY OF PROJECT LENGTH	FEET	MILES
MAJOR STRUCTURE	418	0.08
PROJECT GROSS LENGTH	18,553	3.5

* Milepost are approximate

DESIGN DATA	US 50 (WB)
MAXIMUM RADIUS OF CURVE	6,800 FT.
MAXIMUM GRADE	3.3%
MINIMUM S.S.D. HORIZONTAL	495 FT.
MINIMUM S.S.D. VERTICAL	495 FT.
MAXIMUM DESIGN SPEED	65 MPH
2036 DESIGN TRAFFIC	DHV = 7,859 vph ADT = 87,312 vpd
DHV TRUCK %	4.7%
CLEAR ZONE DISTANCE (TANGENT)	30 FT.
CLEAR ZONE DISTANCE (1,640 MIN. RADIUS)	30 FT.
CONSTRUCTION CLEAR ZONE (MIN 18')	18 FT.

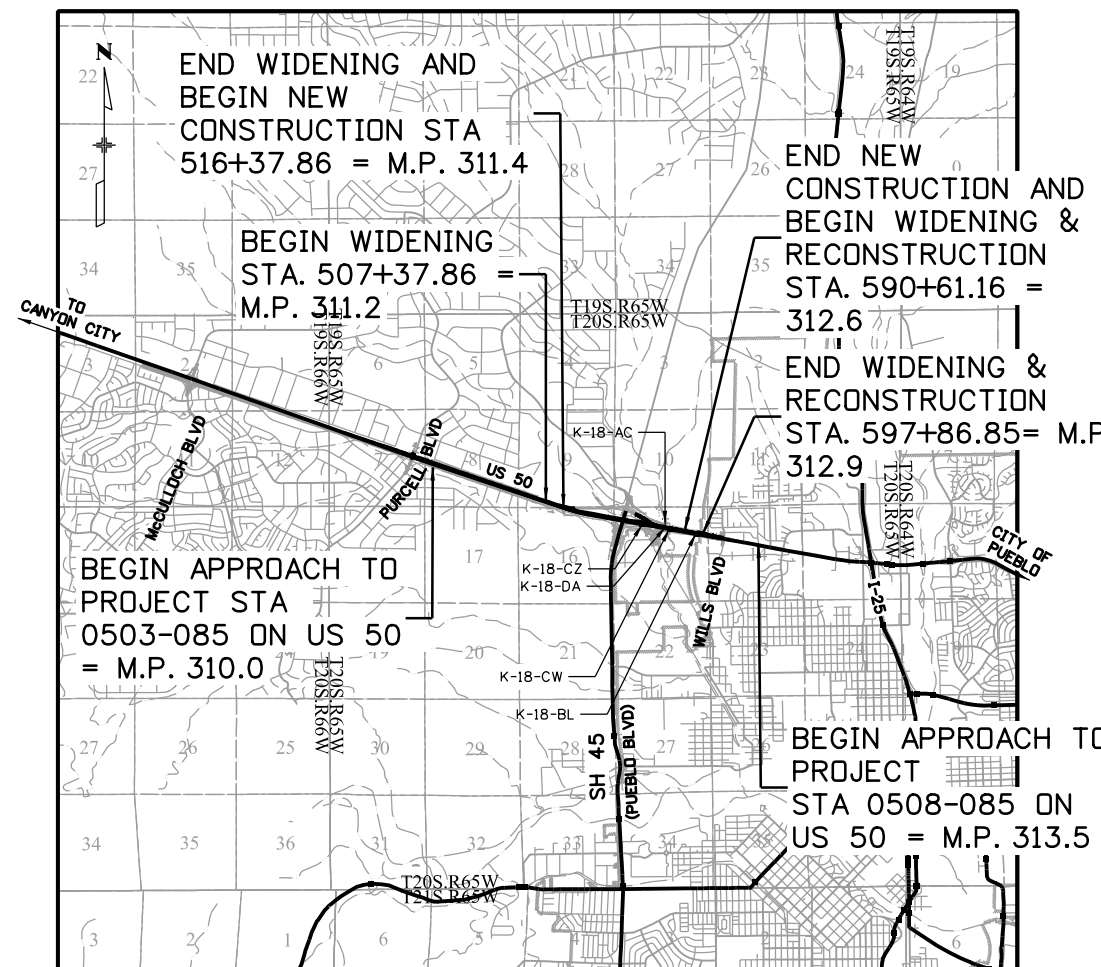

PROJECT LOCATION MAP

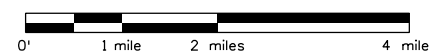

SHEET NO.

- 1
- 2
- 3
- 4-12
- 13-19
- 20-25
- 26-34
- 35
- 36-44
- 45-58
- 59-60
- 61-62
- 63-73
- 74
- 75-79
- 80-88
- 89-90
- 91-96
- 97-101
- 102
- 103
- 104-134
- 135
- 136-137
- 138-145
- 146-148
- 149-156
- 157-163
- 164-172
- 173-181
- 182
- 183
- 184-185
- 186-187
- 188
- 189-198
- 199
- 200-204
- 205-245

INDEX OF SHEETS

- TITLE SHEET
- STANDARDS PLANS LIST
- GENERAL NOTES
- TYPICAL SECTIONS
- SUMMARY OF APPROXIMATE QUANTITIES
- TABULATIONS (EARTHWORK, REMOVALS AND RESETS, SURFACING, GUARDRAILS, DELINEATORS AND DRAINAGE)
- UTILITY PLAN
- GEOMETRY PLAN
- REMOVAL AND RESET PLAN
- ROADWAY PLAN AND PROFILE
- INTERSECTION DETAIL
- GORE DETAIL
- BOREHOLE LOCATION PLAN
- SURVEY TAB
- SURVEY CONTROL DIAGRAM
- GRADING PLAN
- POND DETAILS
- DRAINAGE DETAILS
- PIPE PLAN AND PROFILE
- STORM SYSTEM PLAN AND PROFILE
- STRUCTURE LOCATION MAP
- US 50 WEST WB OVER WILD HORSE DRY CREEK
- BNSF OVER US 50 WEST (ROADWAY DETAIL)
- BNSF OVER US 50 WEST (STRUCTURE REPAIR)
- US 50 WEST WB OVER WILLIAMS CREEK (CBC EXTENSION)
- ENVIRONMENTAL PLANS - GENERAL NOTES
- ENVIRONMENTAL PLANS
- STORM WATER MANAGEMENT PLAN NOTES
- EROSION CONTROL PLAN - INITIAL
- EROSION CONTROL PLAN - FINAL
- TABULATION OF TRAFFIC ENGINEERING ITEMS
- TRAFFIC SIGNAL NOTES AND TABULATION
- TRAFFIC SIGNAL PLAN
- TABULATION OF SIGNING
- TABULATION OF PAVEMENT MARKINGS
- SIGNING AND STRIPING PLAN
- CLASS III CROSS-SECTIONS
- CONSTRUCTION PHASING PLAN
- CONSTRUCTION TRAFFIC CONTROL

Print Date: 3/8/2017

File Name: 20344DES_TitleSht.dgn

Horiz. Scale: 1:1

Vert. Scale:

Sheet Revisions

0000

Date:	Comments	Init.

Colorado Department of Transportation



902 Erie Avenue
Pueblo, CO 81001
Phone: 719-562-5509 FAX: 719-546-5702

Region 2

DTD

As Constructed

No Revisions:
Revised:
Void:

Contract Information

Contractor:
Resident Engineer:
Project Engineer:
PROJECT STARTED: / / ACCEPTED: / /
Comments:

Project No./Code

STA 0503-085

20344

Sheet Number 1



J.F. SATO AND ASSOCIATES
5898 South Rapp Street
Littleton, Colorado 80120