

busanskyj1:37:31 PM p:\617479-PWINT.aecomonline.local\AECOM_DS01_NA\Documents\60505397-US50_Royal Gorge West_SH9.ctb North\900 Work\910 CAD\02 SHEETS\04_Structural\US50_SH9-S-B09_K_15_W_GEN_LAY.dgn

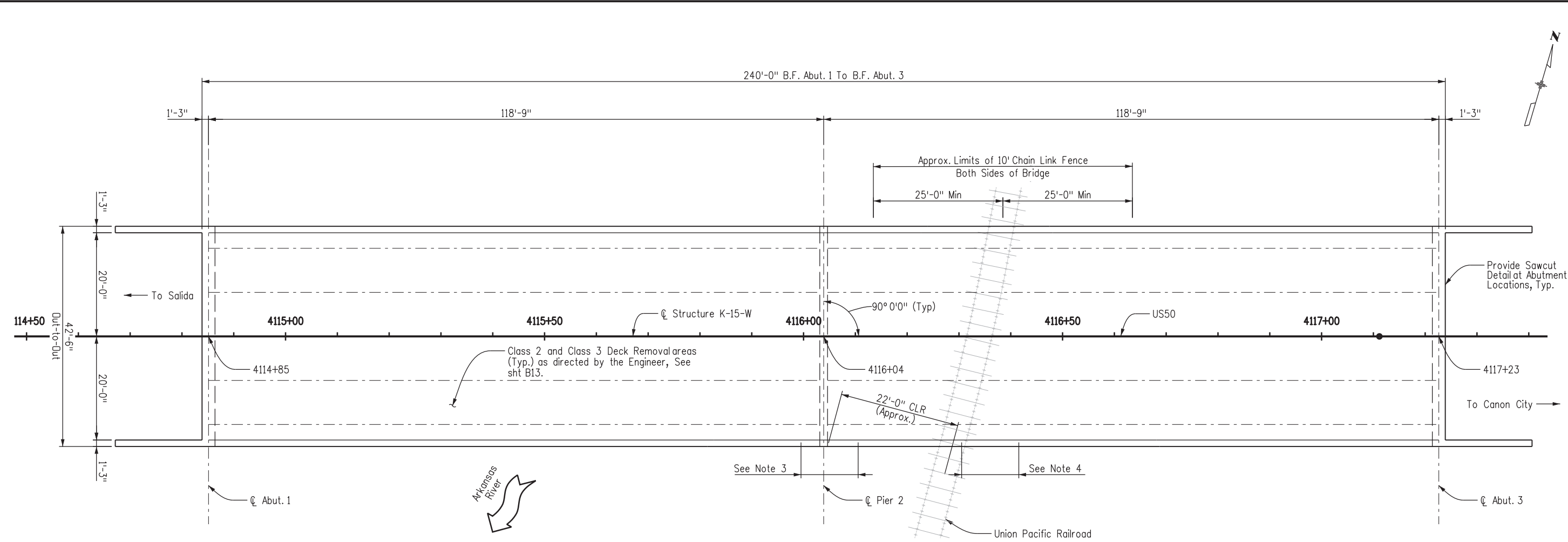

PLAN
(STR K-15-W)

NOTES:

- ① There is approximately 3½ - 4½ inches of existing asphalt on the bridge deck. The deck thickness is 7¼ inches.
- ② Taper HMA to drain at all existing deck drain locations, as directed by the engineer.
- ③ Repair the chain link fence between the first two posts on the west side of the south fence.
- ④ Replace the damaged steel tube beam on the impacted bridge rail between splices. Replace one rail post and perform concrete repair to the spalled curb. Replace bolts on the two adjacent rail posts.
- ⑤ The contractor shall provide a minimum 14'-0" traffic opening on the bridge, measured from face of curb to face of curb, at all times.
- ⑥ Deck removal shall be in accordance with specifications. Removed areas of deck shall be replaced with Concrete Class D (Bridge) (Special).
- ⑦ Blow-through debris from Class 3 repairs shall be collected from dry swales at the end of each day. Blow-through from Class 3 repairs will be captured before entering flowing Waters of the State or wetlands.
- ⑧ See Sheet B8 for fence and rail repair details.

Design		Detail		Quantities	
INITIAL	DATE	INITIAL	DATE	INITIAL	DATE
MS	11/16	RW	11/16	MS	11/16
GM	11/16	GMM	11/16	GMM	11/16
Designed By	Checked By	Detailed By	Checked By	Quantities By	Checked By

Print Date: 1/25/2017
File Name: US50_SH9-S-B09_K_15_W_GEN_LAY.dgn
Horiz. Scale: 1:20 Vert. Scale:

Sheet Revisions		
Date:	Comments	Init.

Colorado Department of Transportation

 1480 Quail Lake, Suite A
 Colorado Springs, CO 80906
 Phone: 719-634-2323 FAX: 719-227-3298
Region 2 DW

As Constructed
No Revisions:
Revised:
Void:

GENERAL LAYOUT			
STR NO. K-15-W			
Designer:	M. SUELAU	Structure	K-15-W
Detailer:	R. WHITCHER	Numbers	
Subset:		Subset Sheets:	B6 of B15

Project No./Code
STA 0503-089
21255
Sheet Number 109