







**LEGEND**

-  MOBILE ATTENUATOR VEHICLE, TWO 360-DEGREE YELLOW FLASHING BEACONS, AND YELLOW FLASHING VEHICLE LIGHTS OR STROBES.
-  VARIABLE MESSAGE SIGN (VMS).
-  WHEN VMS IS USED, THE "SHOULDER CLOSED" SIGN BECOMES OPTIONAL.
-  THE "PICK-UP VEHICLES" OR "WARNING VEHICLE" MAY ENCRDACH INTO THE TRAFFIC LANE WHEN THE SHOULDER IS TOO NARROW TO DRIVE ON.
-  IF TRACKING OF THE WET PAINT IS ANTICIPATED, THE USE OF CONES OR STATIONARY "WET PAINT" SIGNS SHALL BE POSTED.
-  THE VARIABLE SEPARATION DISTANCE BETWEEN THE "CONE PLACEMENT VEHICLE" AND "CONE PICKUP VEHICLE" SHALL BE DETERMINED BY THE TRACK DRYING TIME OF THE PAVEMENT MARKING MATERIAL.
-  OPTIONAL

**FOLLOWING DISTANCE CHART FOR WARNING AND MOBILE ATTENUATOR (OR CONE PICKUP) VEHICLE**

POSTED WZ SPEED LIMIT (MPH)	FOLLOWING DISTANCE (FEET)
0 - 30	250 - 550
35 - 40	325 - 700
45 - 50	600 - 900
55	750 - 1200
60 - 65	1000 - 1400
70 - 75	1200 - 1600

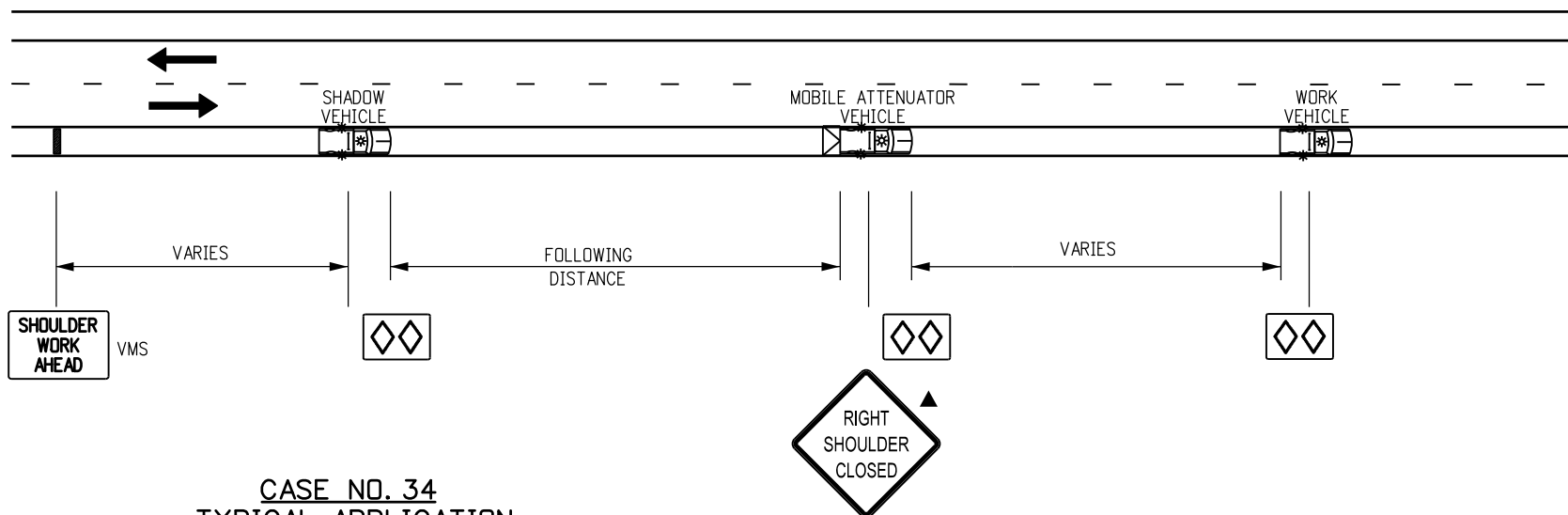

**CASE NO. 34  
TYPICAL APPLICATION  
MOBILE WORK ZONE  
MOBILE SHOULDER CLOSURE ON 2-LANE UNDIVIDED HIGHWAY**

**NOTE**

THE VARIABLE SEPARATION DISTANCE BETWEEN THE "CONE PLACEMENT VEHICLE" AND "CONE PICKUP VEHICLE" SHALL BE DETERMINED BY THE TRACK DRYING TIME OF THE PAVEMENT MARKING MATERIAL.

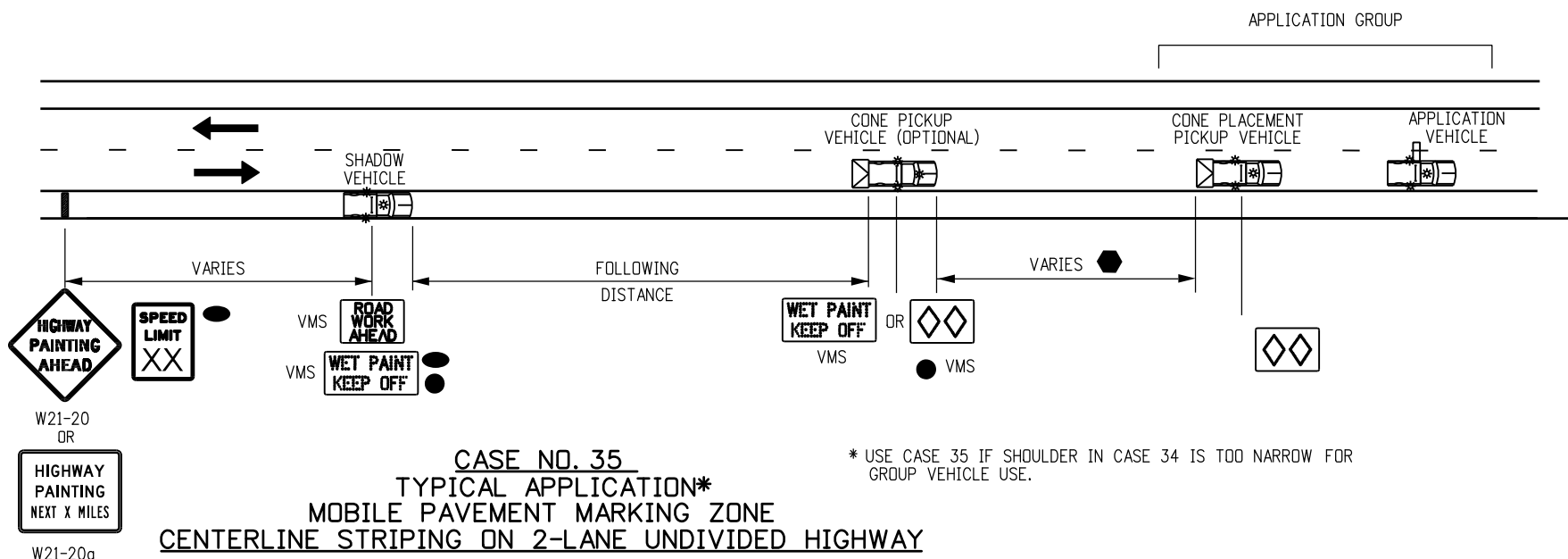

**CASE NO. 35  
TYPICAL APPLICATION\*  
MOBILE PAVEMENT MARKING ZONE  
CENTERLINE STRIPING ON 2-LANE UNDIVIDED HIGHWAY**

Computer File Information		Sheet Revisions		Colorado Department of Transportation		TRAFFIC CONTROLS FOR HIGHWAY CONSTRUCTION		STANDARD PLAN NO.			
Creation Date: 07/04/12	Initials: KEN	Date:	Comments		4201 East Arkansas Avenue Denver, Colorado 80222 Phone: (303) 757-9543 Fax: (303) 757-9219	<b>TRAFFIC CONTROLS FOR HIGHWAY CONSTRUCTION</b>		S-630-1			
Last Modification Date: 03/16/2016	Initials: NNC	3/27/14	REDUCED NUMBER OF TMA VEHICLES, REVISE VMS AND ADD STATIONARY SIGNS					Issued By: Safety & Traffic Engineering Branch July 4, 2012		Sheet No. 21 of 24	
Full Path: www.coloradodot.info/library/traffic/traffic-s-standard-plans		12/8/14	FORMERLY SHEET 17.								
Drawing File Name: S-630-1_21of24.dgn		5/20/16	VEHICLE TITLE CHANGE, SIGN REMOVAL								
CAD Ver.: MicroStation V8	Scale: Not to Scale Units: English	6/23/16	UPDATED NOTE ON BOTTOM RIGHT FROM 34 TO 35 AND 30 TO 34			Safety & Traffic Engineering Branch	KCM/NNC				