

SH 45 Curve 2
 $\Delta c = 18^\circ 54' 09''$
 $Tc = 765.76'$
 $Lc = 1517.60'$
 $Rc = 4600.00'$

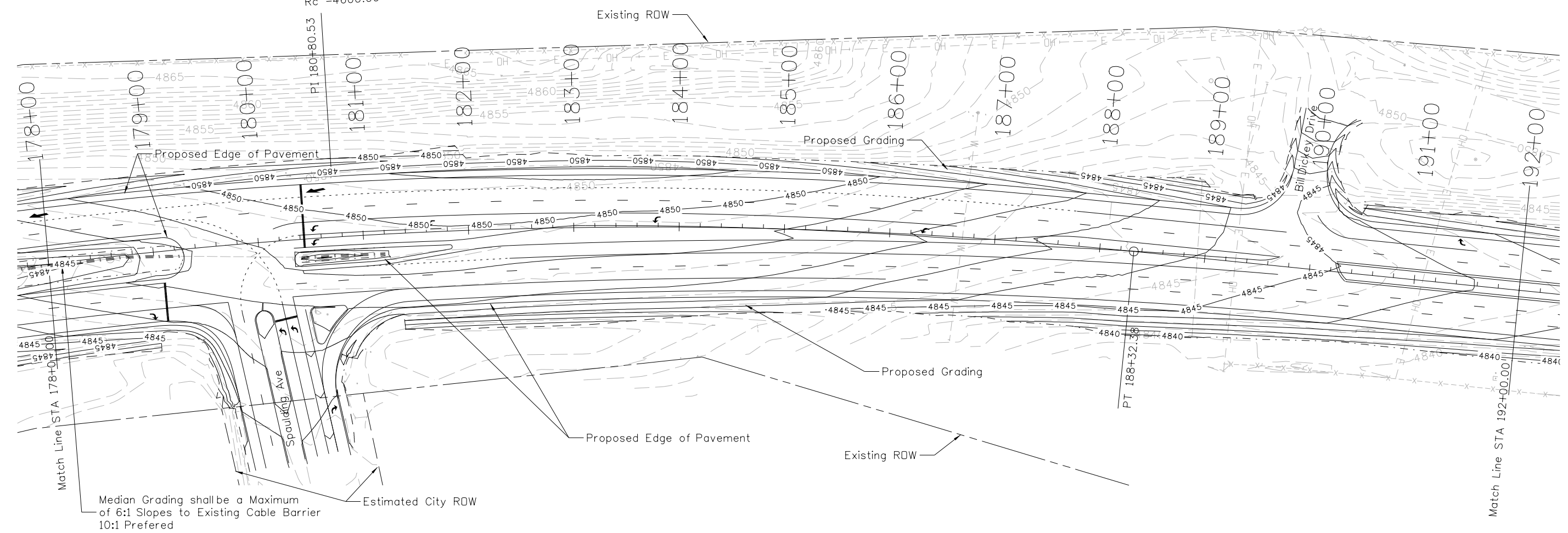

Median Grading shall be a Maximum of 6:1 Slopes to Existing Cable Barrier
 10:1 Preferred



**Know what's below.
 Call before you dig.**

Print Date: 2/21/2017
File Name: 20755DES_Grading08.dgn
Horiz. Scale: 1:100 Vert. Scale: As Noted
Unit Information Unit Leader DTD

Sheet Revisions		
Date:	Comments	Init.

Colorado Department of Transportation



902 Erie Avenue
 Pueblo, CO 81001
 Phone: 719-562-5509 FAX: 719-546-5702

Region 2 DTD

As Constructed
No Revisions:
Revised:
Void:

GRADING PLAN SH 45			
Designer:	LEP	Structure	
Detailer:	LEP	Numbers	
Sheet Subset:	GRADE	Subset Sheets:	08 of 09

Project No./Code
STM SH45-001
20755
Sheet Number 79

phillips 2:26:06 PM c:\projectwise\pwz_working\dl328826\20755DES_Grading08.dgn