

NOTE:  
All Stationing is Based on the SH 45 Control Line,  
The Southbound SH 45 Profile Grade Line is shown  
For Elevation Control of the Southbound Lanes.

 = Concrete Pavement (8 1/4 inches)  
 = Concrete Pavement (8 1/4 inch) and  
8" Aggregate Base Course (Special)  
See Roadway Plan Sheets for Details

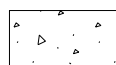
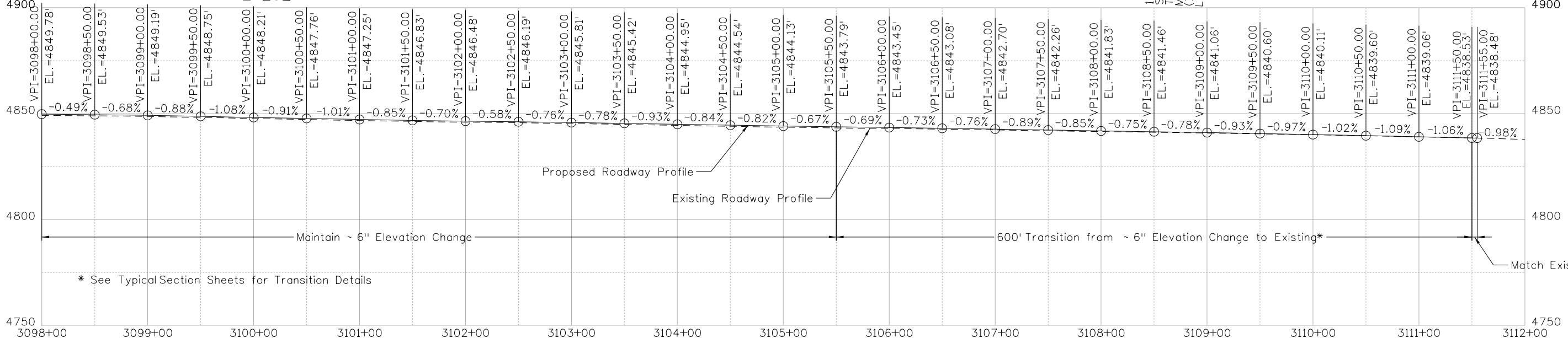
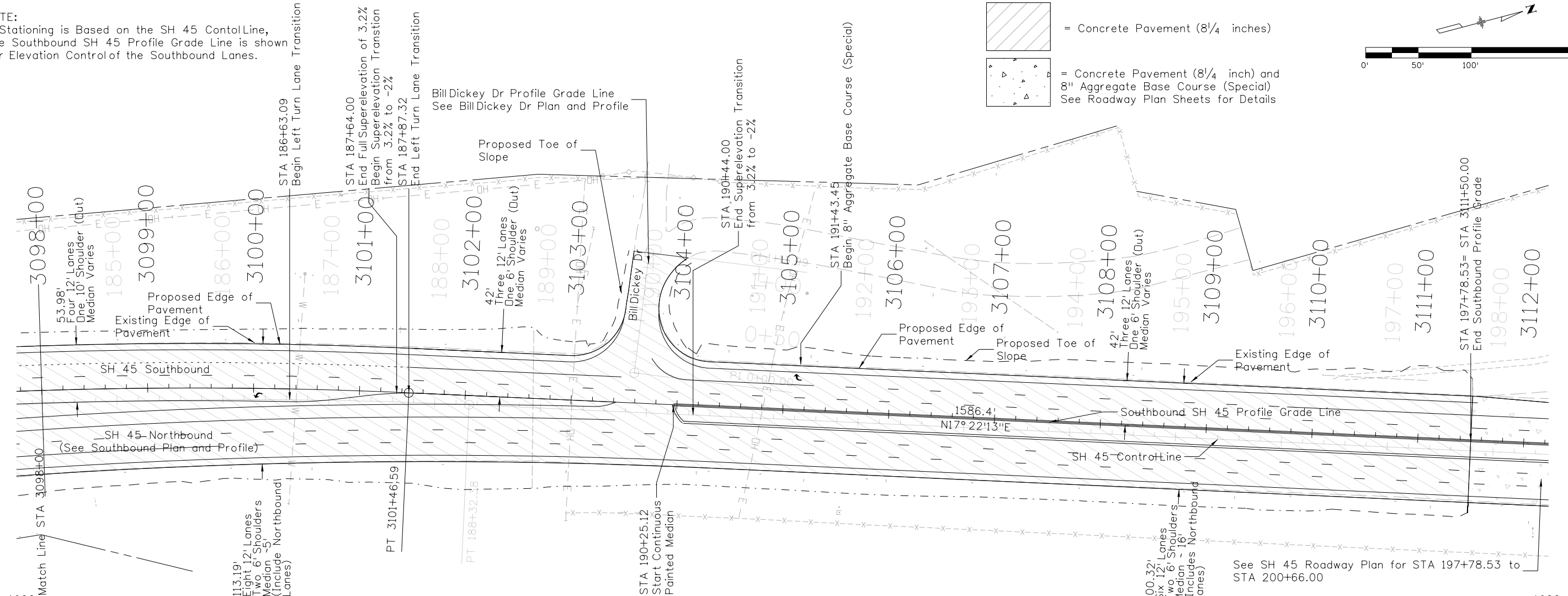
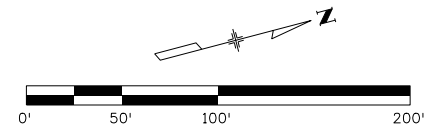

phillips 9/21/13 11:36 AM c:\projectwise\pwworking\dl328626\20755DES\_PnPSB08.dgn

Print Date: 3/7/2017
File Name: 20755DES_PnPSB08.dgn
Horiz. Scale: 1:100      Vert. Scale: As Noted
Unit Information      Unit Leader DTD

Sheet Revisions		
Date:	Comments	Init.

Colorado Department of Transportation  
  
 902 Erie Avenue  
 Pueblo, CO 81001  
 Phone: 719-562-5509 FAX: 719-546-5702  
 Region 2      DTD

As Constructed
No Revisions:
Revised:
Void:

SOUTHBOUND PLAN AND PROFILE			
SH 45			
Designer:	LEP	Structure	
Detailer:	LEP	Numbers	
Sheet Subset:	SB P&P	Subset Sheets:	08 of 08

Project No./Code	
STM SH45-001	
20755	
Sheet Number	65