

NOTE:
 All Stationing is Based on the SH 45 Control Line,
 The Northbound SH 45 Profile Grade Line is shown
 For Elevation Control of the Northbound Lanes.

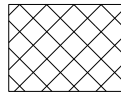

= Concrete Pavement (8 1/4 inches)



= Concrete Pavement (8 1/4 inches) (Fast Track)

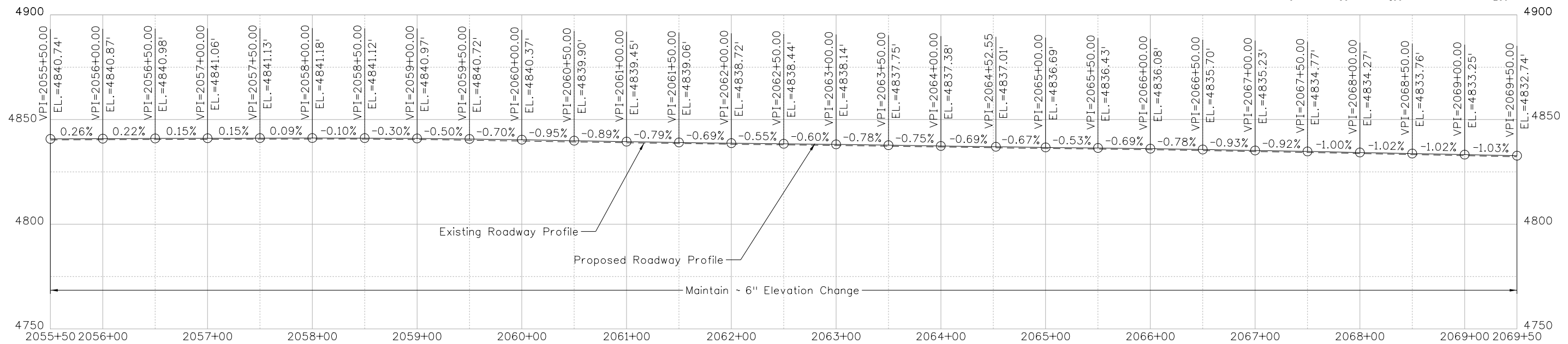

phillips 3:20:42 PM c:\projectwise\pwz_working\at328826\20755DES_PnPNB05.dgn

Print Date: 2/21/2017	Sheet Revisions			Colorado Department of Transportation			As Constructed		NORTHBOUND PLAN AND PROFILE			Project No./Code	
File Name: 20755DES_PnPNB05.dgn	Date:	Comments	Init.	902 Erie Avenue Pueblo, CO 81001 Phone: 719-562-5509 FAX: 719-546-5702			No Revisions:		SH 45			STM SH45-001	
Horiz. Scale: 1:100				Region 2			Revised:		Designer: LEP			20755	
Unit Information				DTD			Void:		Detailer: LEP			Sheet Number	
									Structure Numbers			54	
									Sheet Subset: NB P&P			Subset Sheets: 05 of 08	