

NOTE:  
 All Stationing is Based on the SH 45 Control Line,  
 The Northbound SH 45 Profile Grade Line is shown  
 For Elevation Control of the Northbound Lanes.

 = Concrete Pavement (8 1/4 inches)

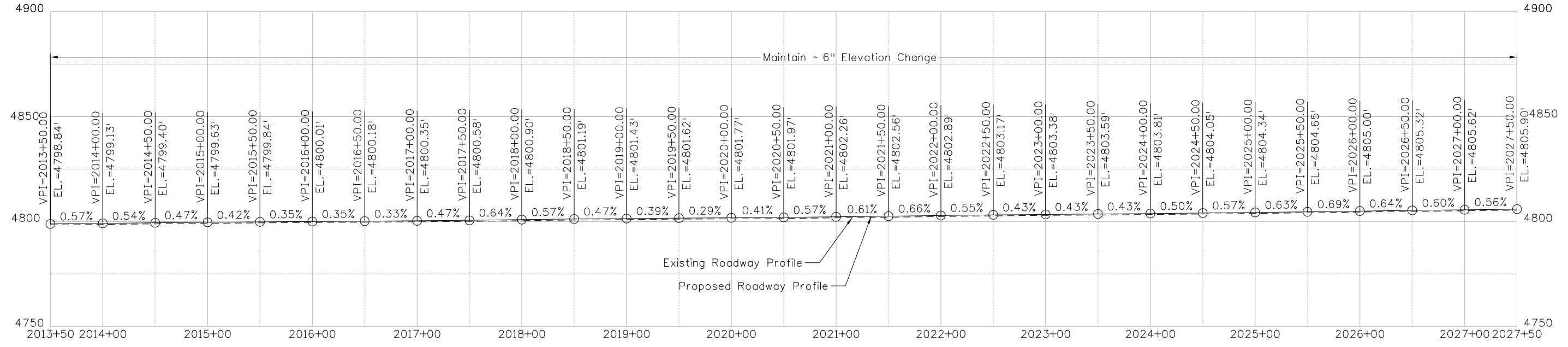
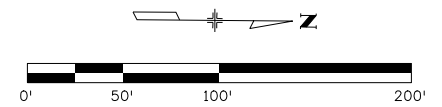

Print Date: 2/21/2017	 Colorado Department of Transportation 902 Erie Avenue Pueblo, CO 81001 Phone: 719-562-5509 FAX: 719-546-5702 Region 2 DTD	As Constructed	NORTHBOUND PLAN AND PROFILE		Project No./Code
File Name: 20755DES_PnPNB02.dgn		No Revisions:	SH 45		STM SH45-001
Horiz. Scale: 1:100 Vert. Scale: As Noted		Revised:	Designer: LEP	Structure Numbers	20755
Unit Information Unit Leader DTD		Void:	Detailer: LEP	Sheet Subset: NB P&P	Subset Sheets: 02 of 08

phillips 3:13:10 PM c:\projectwise\pwworking\dl328826\20755DES\_PnPNB02.dgn