

900 > 23.99' 45
 54.00 > 23.99' 45
 177 > 16.5' 45
 45.22.6.111 X ENGR
 1.-CONTRACT 0.2016
 14589000776.222
 776.22214589000
 8900076.222.480
 9822.8798 | 235
 8222.8798 | 232
 16 m
 23 m
 900.0 G
 900.0 G
 45°

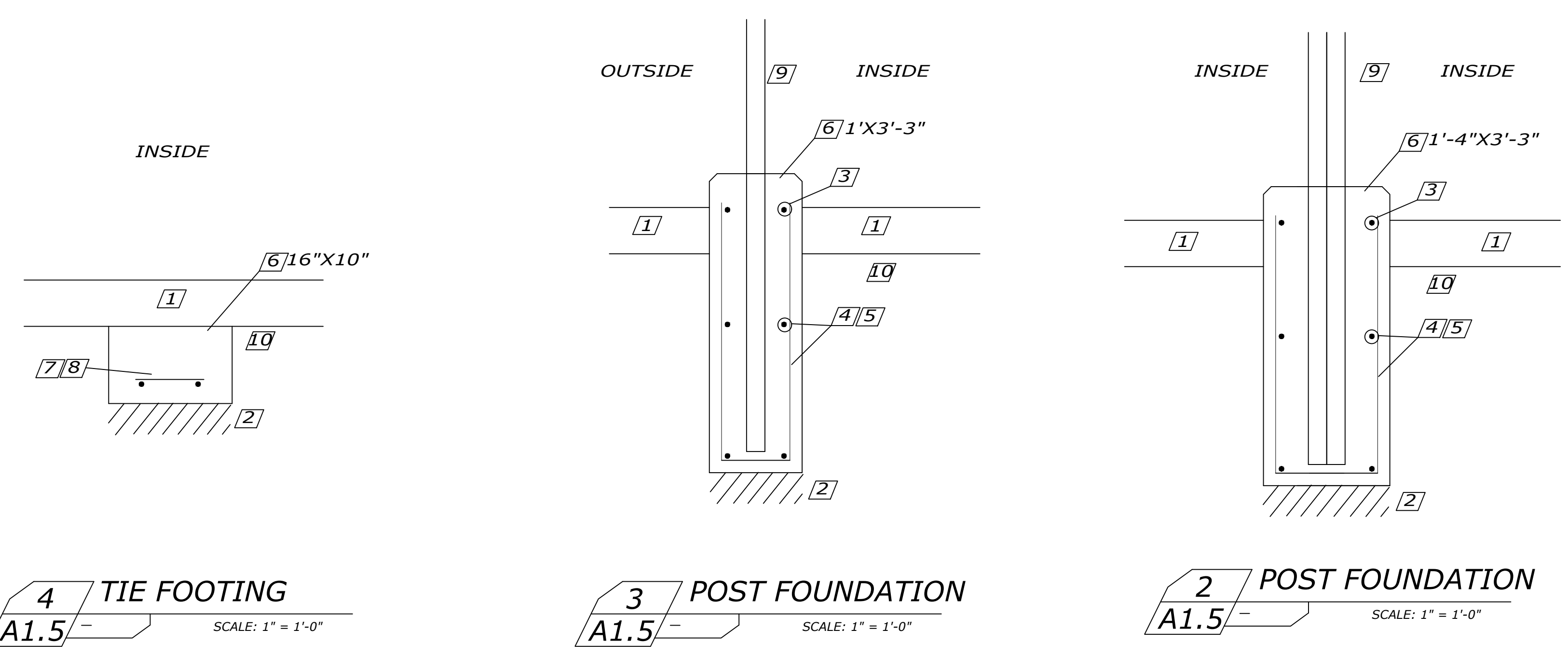

4 TIE FOOTING
 A1.5 - SCALE: 1" = 1'-0"

3 POST FOUNDATION
 A1.5 - SCALE: 1" = 1'-0"

2 POST FOUNDATION
 A1.5 - SCALE: 1" = 1'-0"

GENERAL NOTES:

A. ALL REBAR TO BE ON 2" CHAIRS AND HAVE 2" MIN. COVER EVERYWHERE

KEYED NOTES:

- 1 6" GRAVEL OR MULTCH
- 2 4" COMPACT STRUCTURAL FILL ON COMPACT SOIL
- 3 #3 REBAR LONG CONTINUOUS
- 4 #5 REBAR LONG CONTINUOUS
- 5 #3 BENT 36", 8", 36" @ 24" O.C.
- 6 GRADE BEAM TO BE CAST AGAINST EARTH
- 7 #3 REBAR TRANS @ 16" OC
- 8 #5 REBAR LONG CONTINUOUS
- 9 GREENHOUSE STRUCTURE BY OTHERS
- 10 PREP SOIL TO SLOPE 1% FROM NORTH TO SOUTH

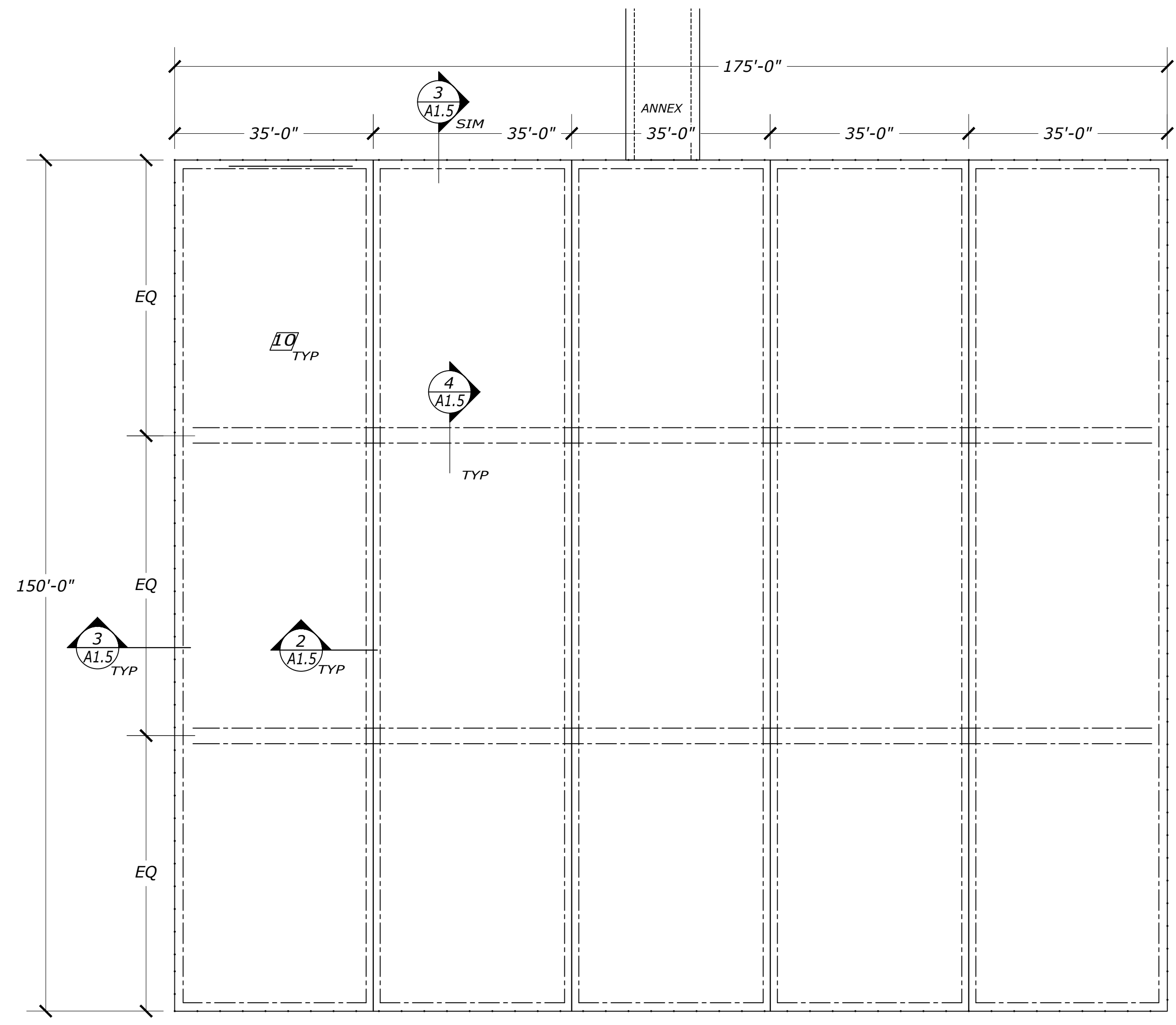

1 GREENHOUSE FOUNDATION PLAN
 A1.5 - SCALE: 1/16" = 1'-0"



AE LEUKEN, LLC
 ARCHITECTURAL ENGINEERS

1122 N. EL PASO ST
 COLORADO SPRINGS CO, 80903
 PHONE : (719) 398 1155

MILE HIGH ROSE LLC
 180 COUNTY RD 599
 WALSENBURG, CO 81089

| NO. | DATE | DESCRIPTION |
|-----|------|-------------|
| | | |

| | |
|-------------|---------------|
| DATE: | XX/XX/XXXX |
| CHECKED BY: | JJG |
| PROJECT NO: | PROJECT# |
| SHEET: | GH FNDTN PLAN |

A1.5